

plan

M.P. ....

L. & S. 12/2 SUB 3/07

SURVEY ORDER No.

46/2003

Bk. 1290 fol. 79

In the Ward of MONTSERRAT

SURVEY OFFICE,

FEBRUARY 12<sup>TH</sup> 192003

To

MR. INDAR RAGOO TTLs.  
Land Surveyor

The application for the undermentioned parcel of Land having been approved, I request you to set out the Boundaries, by a Traverse Survey, and according to the Land Surveyors Rules, 1935.

Names of Petitioner and Residence	ACREAGE			Boundaries
	A.	B.	P.	
SURVEY OF A PARCEL OF LAND KNOWN AS LOT #27 SAN FRANCISCO LAND SETTLEMENT SITUATE AT SAN FRANCISCO LAND SETTLEMENT, FREEPORT FOR A STANDARD AGRICULTURAL LEASE FOR JOHN LAKHANSINGH + DAVID LAKHANSINGH.				N. S. E. W.

Road to be reserved to provide access to

*Michael Jones*  
Director of Surveys

CERTIFICATES

I certify that I checked the steel tape used on the ..... Standard on the ..... day of ..... and that I verified the compass used on the ..... day of ..... on the Port-of-Spain Referring Mark.

Land Surveyor

I certify that I ran all the lines charged for myself and strictly observed Rule 10 and that  $\circ$  pillars and  $\leftarrow$  irons were placed by me on the survey.

Pillars were taken at

*Sd. Rago*

Land Surveyor







Survey Order No.....

FIELD NOTES

(1)

(2)

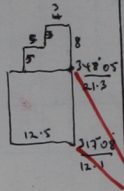

1/pt  
 10.06  
 Road  
 Res. now Saiju Rd 10.06m  
 1/pt  
 195.00  
 1/pt  
 62.44

State  
 (25)

(27)

1/pt  
 195.00

1/pt in  
 bamboo path

COUVA RIVER

River Reserve  
 90.3m

89.65

(27)

1/pt  
 132.90

1/pt  
 98.98

(27)

12  
 90.0

50  
 3.0

13.05

WL  
 Nom Mkt

1/pt Y6  
 45.00  
 10.06

(27)  
 State

5.00  
 23.12  
 Botfa  
 1/pt

0  
 110° 24' 62.85  
 1/pt

5.00'  
 wall wire fence

Nom Mkt U6

Distances in metres  
 Bgare Cassini Grid based on Solar Obs.

Surveyed in Feb. 2003 to be leased to David & John  
 Lackhansingh