

M.P.....

L. & S.—53

L. & S...11270.....

*Splans*

SURVEY ORDER No.

38/2003

*Bk. 1290 Pt. 178*

In the Ward of..... CUNUPIA .....

SURVEY OFFICE,

FEBRUARY 6<sup>TH</sup> ..... 192003

To

MR. INDAR RAGOO T.T.L.S.  
*Land Surveyor*

The application for the undermentioned parcel of Land having been approved, I request you to set out the Boundaries, by a Traverse Survey, and according to the Land Surveyors Rules, 1935.

Names of Petitioner and Residence	ACREAGE			Boundaries
	A.	R.	P.	
SURVEY OF A PARCEL OF LAND KNOWN AS LOT #28 BOY CATO ROAD, LAS LOMAS FOR A STANDARD AGRICULTURAL LEASE FOR INSTAN AKALOO				N. S. E. W.

Road to be reserved to provide access to

*Michael Jones*  
Director of Surveys

CERTIFICATES

I certify that I checked the steel tape used on the .....Standard on the..... day of..... and that I verified the compass used on the..... day of ..... on the Port-of-Spain Referring Mark.

*Land Surveyor*

I certify that I ran all the lines charged for myself and strictly observed Rule 10 and that pillars and irons were placed by me on the survey.

Pillars were taken at

*Sndr. Rojas*  
*Land Surveyor*





FIELD NOTES

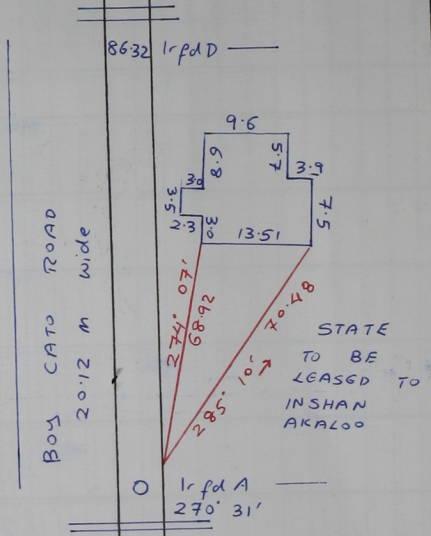

Dist. in metres  
 Bearings are U.T.M Grid based on solar obs.  
 Surveyed in February 2003 for a Standard  
 Agricultural lease for Inshan Akaloo.