

8/plan

M.P. ....

L. & S. 113/2 sub. 1/66

SURVEY ORDER No.

26/2003

Bk 1290 M. 90

In the Ward of TOCO .....

SURVEY OFFICE,

JANUARY 26<sup>th</sup> 192003

To

MR. INDAR RAGOO TTLs.  
Land Surveyor

The application for the undermentioned parcel of Land having been approved, I request you to set out the Boundaries, by a Traverse Survey, and according to the Land Surveyors Rules, 1935.

Names of Petitioner and Residence	ACREAGE			Boundaries
	A.	R.	P.	
SURVEY OF LOT #66 ALLANDALE LAND, CUMANÁ SETTLEMENT TOCO, FOR A LEASE TO VIOLA BRATHWAITE (10.6 HA).				N. S. E. W.

Road to be reserved to provide access to

*[Signature]*  
Director of Surveys  
2003.1.28

CERTIFICATES

I certify that I checked the steel tape used on the ..... Standard on the..... day of..... and that I verified the compass used on the..... day of ..... on the Port-of-Spain Referring Mark.

Land Surveyor

I certify that I ran all the lines charged for myself and strictly observed Rule 10 and that 01 pillars and 01 irons <sup>was</sup> were placed by me on the survey.

Pillars were taken at

*[Signature]*  
Land Surveyor

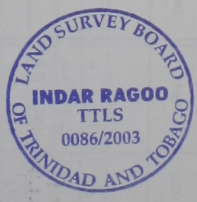





FIELD NOTES

(1)

(2)

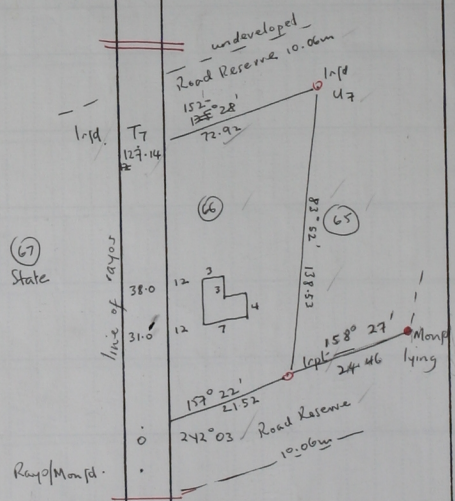

Vide Plan K.P. 53A

Dist. in metres

By one Cassini Grid. based on Sd Obs.

Surveyed in Feb 2003 to be leased to viola Brithwaite