

8 days

M.P.

L. & S.—53

L. & S. 21122 sub 550

SURVEY ORDER No.

376 | 8003

In the Ward of Tacaná

SURVEY OFFICE,

DECEMBER 15TH 192003

To Mr Indar Ragoo TTLS
Land Surveyor

The application for the undermentioned parcel of Land having been approved, request you to set out the Boundaries, by a Traverse Survey, and according to the Land Surveyors Rules, 1935.

Names of Petitioner and Residence	ACREAGE			Boundaries
	A.	R.	P.	
Survey and Subdivision of a parcel of land at Ramdehat Truce St Augustine for lease to Elizabeth Garib				N. S. E. W.

road to be reserved to provide access to

[Signature]
Director of Surveys

CERTIFICATES

certify that I checked the steel tape used on the Standard
in the day of
and that I verified the compass used on the
day of on the Port-of-Spain Referring Mark.

Land Surveyor

I certify that I ran all the lines charged for myself and strictly observed
rule 10 and that pillars and iron ^{and 4 nails} were placed by me on the survey.

Pillars were taken at

Indar Ragoo
Land Surveyor

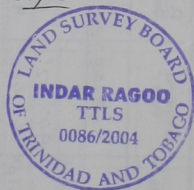

Survey Order No. 376/2003

Ward of Tacarigua
County of St. George

See BK. 922 : 3
917 : 285

FIELD NOTES

(1)

(2)

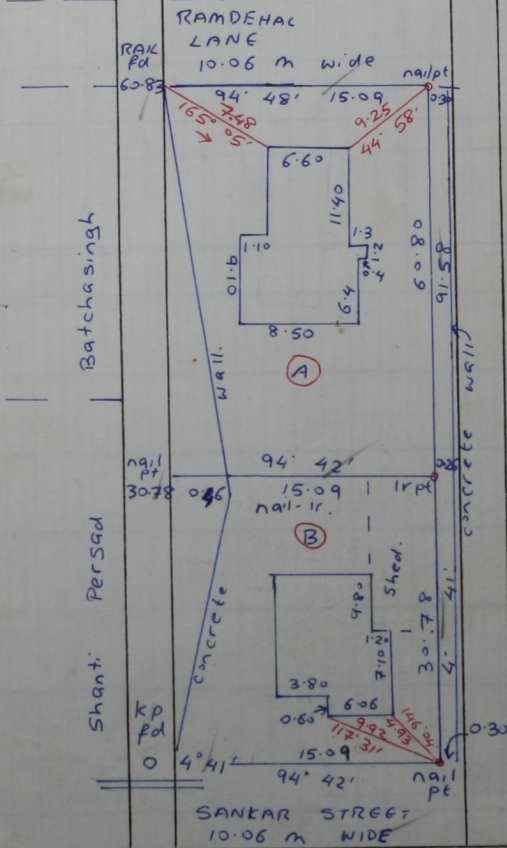

Bearings are Cassini Grid based on Solar obs.

Dist. in n

Surveyed by me with due authority in January 2004 for leases to Elizabeth Garib.