

M.P.....

L. & S. 1/2/3. 546.35/52

SURVEY ORDER No.

360 | 2003

BK 1359/1237

Submitted
OL
2004/6/15

8 plans

In the Ward of..... MANZANILLA.....

SURVEY OFFICE,

..... DECEMBER 1ST 192003

To

MR. ROOP SINGH T.TLS......
Land Surveyor

The application for the undermentioned parcel of Land having been approved, I request you to set out the Boundaries, by a Traverse Survey, and according to the Land Surveyors Rules, 1935.

Names of Petitioner and Residence	ACREAGE			Boundaries
	A.	B.	F.	
SURVEY OF A PARCEL OF LAND (21.4 HA) KNOWN AS LOT #052 US BASE LANDS, NORTH MANZANILLA FOR A STANDARD AGRICULTURAL LEASE FOR MAHABIR RAGBIR.				N. S. E. W.

Road to be reserved to provide access to

[Signature]
Director of Surveys

CERTIFICATES

I certify that I checked the steel tape used on theStandard on the..... day of..... and that I verified the compass used on the..... day of on the Port-of-Spain Referring Mark.

Land Surveyor

I certify that I ran all the lines charged for myself and strictly observed Rule 10 and that — pillars and / irons were placed by me on the survey.

Pillars were taken at

[Signature]
Land Surveyor
2nd June 2004

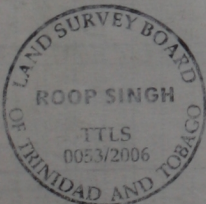

Stamp

Sta.	Field	Deduced	Chain	N.	S.	E.	W.	Sta.	Meridian	Perpendicular	Double Longitudes	North Products	South Products	Sta.	Co-ordinates
A	359° 40'		174.81												
B	89 41'		100.29												
C	191 28		194.65												
D	286 55		63.33												
AREA = 1.4750 A.C.															

FIELD NOTES

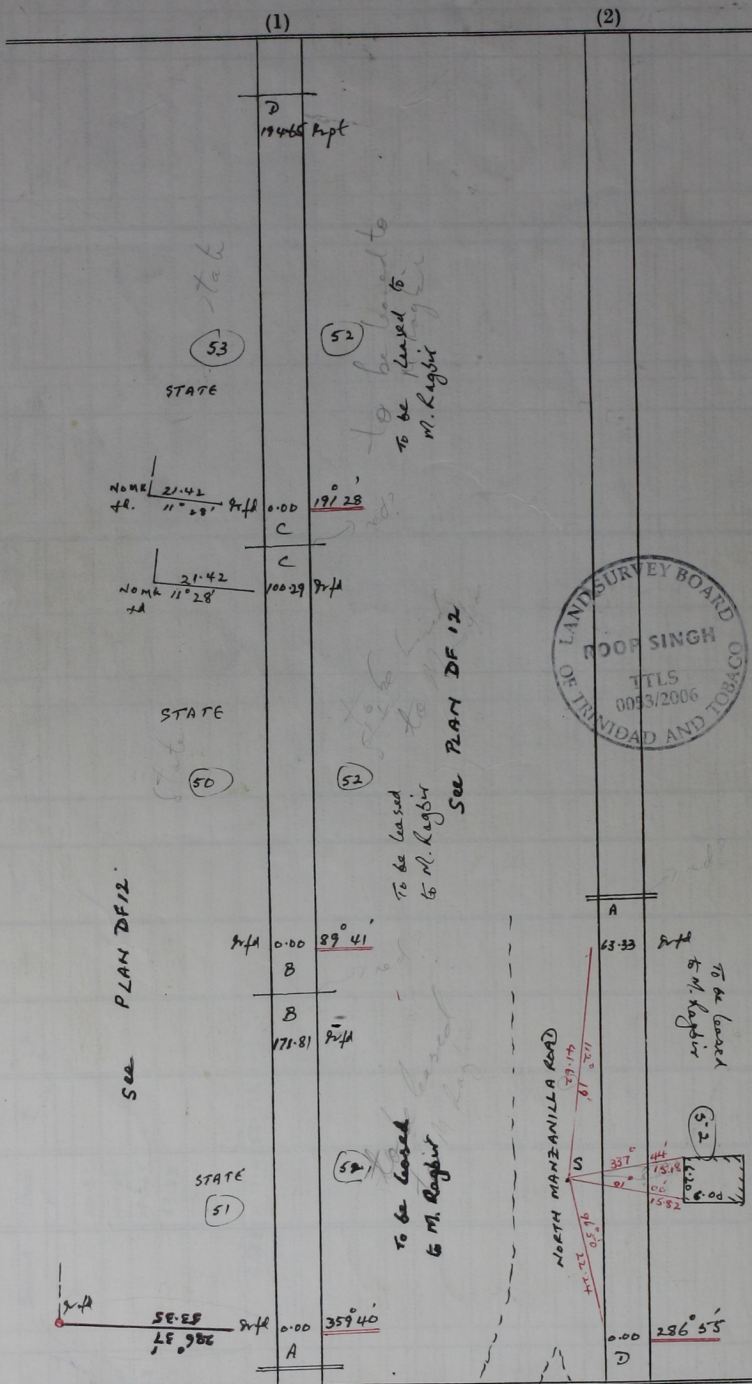

BEARINGS ARE CASSINI GRID BASED ON SOLAR OBS.
TO OBTAIN COMPASS BEARING ADD 21 MINS.

WARD OF MANZANILLA
COUNTY OF ST. ANDREW

SURVEYED IN MAY 2004 TO BE LEASED TO MAHABIR RAGBIR. CADASTRAL SHEET ESC. 368/3/6
DIST. IN METRES