

M.P. ....

L. & S.—53

L. & S. 1117 sub 266

*plans*

SURVEY ORDER No.

201 / 2003

In the Ward of ARIMA

*Bk. 1290 fol. 39*

SURVEY OFFICE,

MAY 13<sup>TH</sup> 192003

To

MR. KEITH SCOTT T.T.L.S.  
Land Surveyor

The application for the undermentioned parcel of Land having been approved, I request you to set out the Boundaries, by a Traverse Survey, and according to the Land Surveyors Rules, 1935.

Names of Petitioner and Residence	ACREAGE			Boundaries
	A.	B.	P.	
SURVEY OF A PARCEL OF LAND (10.7 HA) KNOWN AS LOT #226 WALLERFIELD FOOD GARDENS SITUATE AT WALLERFIELD, ARIMA FOR A STANDARD AGRICULTURAL LEASE FOR RUDOLPH LEWIS				N. S. E. W.

Road to be reserved to provide access to

*[Signature]*  
Director of Surveys

CERTIFICATES

I certify that I checked the steel tape used on the .....Standard on the..... day of..... and that I verified the compass used on the..... day of ..... on the Port-of-Spain Referring Mark.

Land Surveyor

I certify that I ran all the lines charged for myself and strictly observed Rule 10 and that      pillars and 3 irons were placed by me on the survey.

Pillars were taken at

*[Signature]*  
Land Surveyor  
T.T.L.S.  
5/6/03



## SURROUND TRAVERSE

DEG.	MIN.	DIST	EASTINGS	NORTHINGS
			1000.00	1000.00
6	19	22.99	1002.53	1022.85
8	00	35.73	1007.50	1058.23
83	29	49.06	1056.25	1063.80
168	39	55.32	1067.13	1009.56
261	45	10.06	1057.18	1008.12
261	56	57.75	1000.00	1000.02

*CLOSE = 2 / 15,028  
 Bk = 272.2430  
 DIST = 0.02  
 Area = 3283.4 m<sup>2</sup>*

$\Delta E =$        $\Delta N =$   
 0.00      0.02  
 Prec = 1 / 15,027 ✓

AREA =      3,283.42 sq. m. ✓  
 TOTAL AREA =      0.3283 Ha.

*Camp. closed  
 Anthony to check*



FIELD NOTES

(1)

(2)

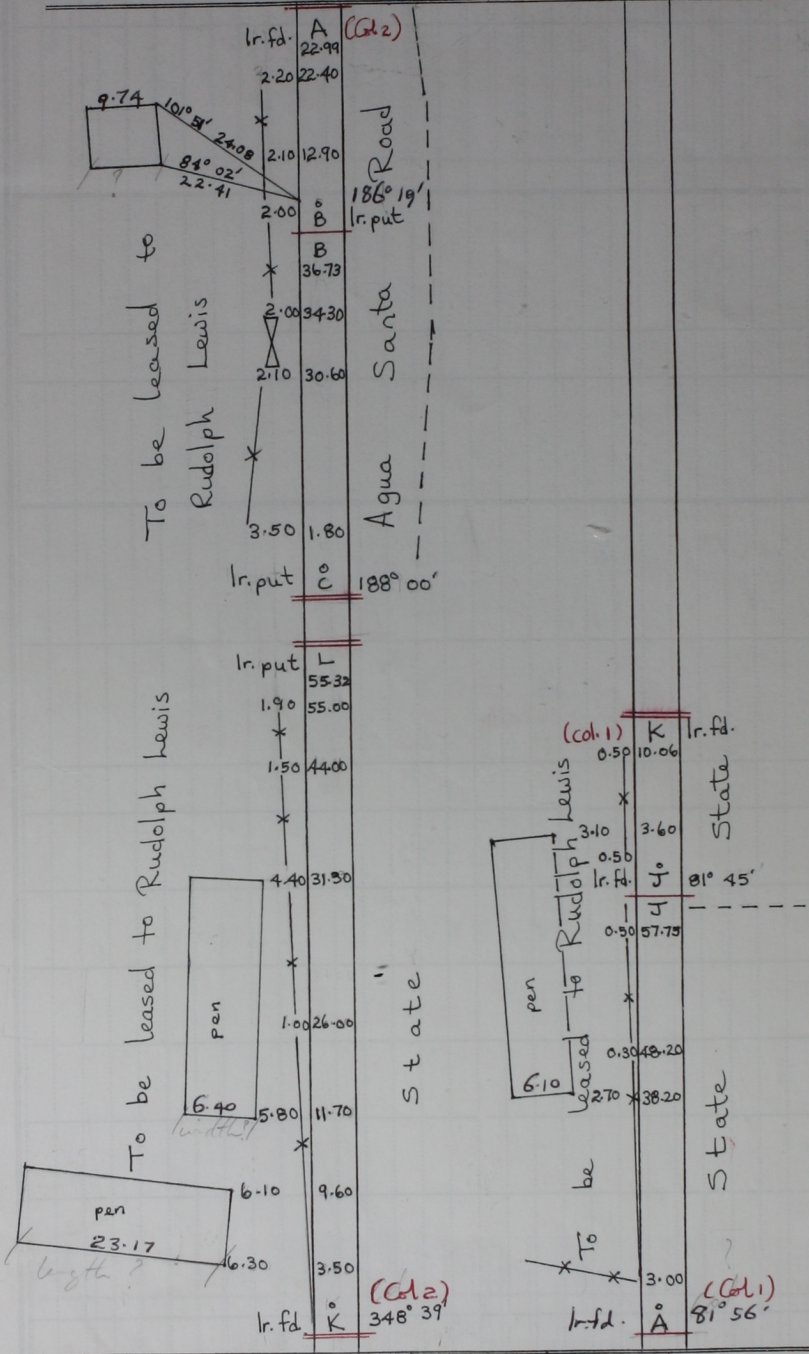

Bearings are Cassini Grid based on Solar Obs.  
 To obtain compass bearings add 13 minutes  
 Surveyed in May 2003 to be leased to Rudolph Lewis

Cadastral Sheet 25A 3/a & 24C 4/b  
 Ward of Arima  
 County of St. George  
 Vide BK. 1089 Fol. 103  
 BK 1180 Fol. 113