

*8 plans*

M.P.....

L. & S. 111667.....

**SURVEY ORDER No.**

153/2003

*Bk. 12 90 fol. 60*

In the Ward of.....

**SURVEY OFFICE,**

APRIL 9<sup>TH</sup>.....192003

To

MR. WINSTON RAMCHARAN TTLS.  
Land Surveyor

The application for the undermentioned parcel of Land having been approved, I request you to set out the Boundaries, by a Traverse Survey, and according to the Land Surveyors Rules, 1935.

Names of Petitioner and Residence	ACREAGE			Boundaries
	A.	R.	P.	
SURVEY OF A PARCEL OF LAND (1.60 HA) KNOWN AS   SITUATED AT #48 - 50 BYE PASS ROAD ARIMA FOR A STANDARD AGRICULTURAL LEASE FOR TULADAI TEELUCKSINGH + RAMESH TEELUCKSINGH.				N. S. E. W.

Road to be reserved to provide access to

*Michael Jones*  
Director of Surveys

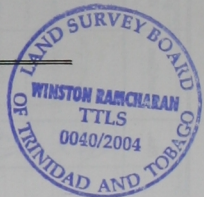

**CERTIFICATES**

I certify that I checked the steel tape used on the .....Standard on the..... day of..... and that I verified the compass used on the..... day of ..... on the Port-of-Spain Referring Mark.

Land Surveyor

I certify that I ran all the lines charged for myself and strictly observed Rule 10 and that ..... pillars and *(one)* iron were placed by me on the survey.

Pillars were taken at

*Winston Ramcharan*  
Land Surveyor





FIELD NOTES

(1)

(2)

To plot buildings

- y-1 42°13' 45.9
- y-2 125°32' 12.50
- y-3 158°33' 13.92
- y-4 158°20' 47.73
- y-5 162°15' 37.23
- y-6 177°07' 41.98
- y-f 61°55' 34.38
- y-e 51°00' 33.51
- y-d 27°52' 13.13
- y-a 335°08' 39.17
- y-b 338°08' 27.48
- y-b' 23°41' 64.22
- y-c 32°32' 63.44
- y-c 354°20' 20.80

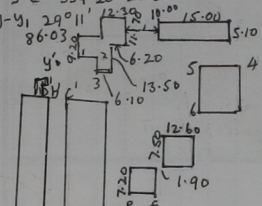

River  
Z  
Res 1.51m wide  
3ftd  
277.04  
226.91

Lease for  
Tuladai & Ramesh  
Teelucksingh

(48) (49) (50)

(51) (52)  
Leased to  
Martinez

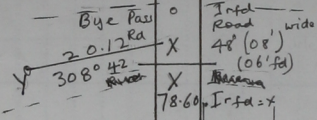

Inter Road  
48' (08') wide  
(06'fd)  
Interd = x

A  
Lease for  
Tuladai & Ramesh  
Teelucksingh

(48) (49) (50)

See Below

BYE PASS ROAD  
20.12 m wide.  
grtd  
138° 07'

B2 Ir pt  
260.57  
A  
Lease for  
Tuladai & Ramesh  
Teelucksingh

(48) (49) (50)

(47)

Leased to Y. Ali

See s.0 55/68

BYE ROAD  
A2  
Interd  
48° 08' PASS  
20.12 m wide

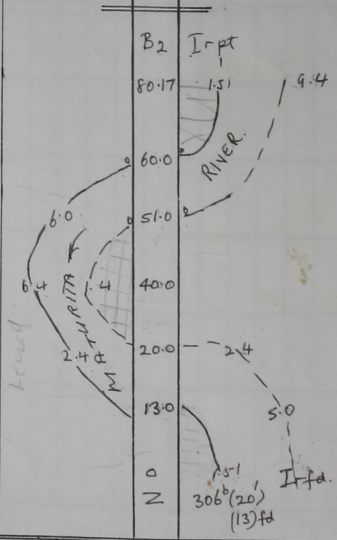

o Denotes Ir fd except otherwise stated.  
Brgs are Cassini based on Solar observations

L + 51/1/1667 Distances are in metres  
Surveyed in

Cadastral Sheet B20M 245  
Ward of Arnie  
County of St George.  
April 2003 for a Standard Agricultural  
Lease for Tuladai & Ramesh Teelucksingh