

M.P.

L. & S.—83

L. & S. 22/11/19 VOL. II G.F

196-

SURVEY ORDER No.

83/2002

J.D. 247

In the Ward of Tacangha

SURVEY OFFICE,

AUGUST 5th 19.2002

To

MR. MARTIN COOKE T.T.S.
Land Surveyor

The application for the undermentioned parcel of Land having been approved, I request you to set out the Boundaries, by a Traverse Survey, and according to the Land Surveyors Rules, 1935.

Names of Petitioner and Residence	ACREAGE			Boundaries
	A.	B.	F.	
SURVEY OF A PARCEL OF LAND SITUATED AT RAMBOONIE TRACE, EUREPE - HOUSING PROGRAMME 2002 FOR THE LAND SETTLEMENT AGENCY				N. S. E. W.

Road to be reserved to provide access to

Michael
Director of Surveys

CERTIFICATES

I certify that I checked the steel tape used on the Standard on the day of and that I verified the compass used on the day of on the Port-of-Spain Referring Mark.

Land Surveyor

I certify that I ran all the lines charged for myself and strictly observed Rule 10 and that pillars and irons were placed by me on the survey.

Pillars were taken at

Edwin N. Gode
Land Surveyor

1

FIELD NOTES

FARM GROVE, CUPEPE.

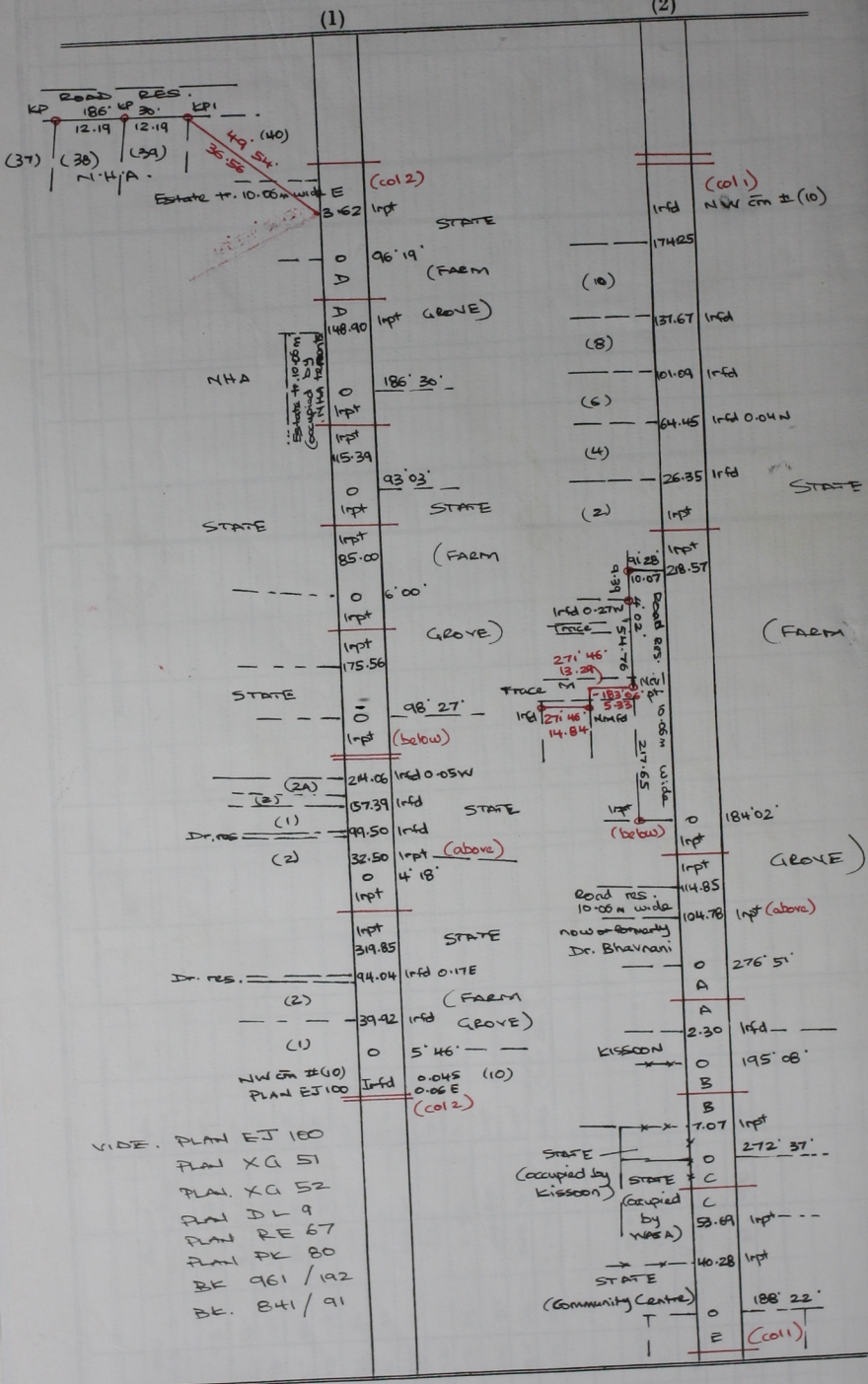

- VIDE. PLAN EJ 100
 PLAN XG 51
 PLAN XG 52
 PLAN DL 9
 PLAN RE 67
 PLAN PK 80
 BK 961/192
 BK. 841/91

Dist. m
 Big area Cassini Grid based on solar obs.
 Surveyed by me in May 2002 for the Ministry of Housing.