

I.P.....

& S. 10/6/28.....

①

*plans*

SURVEY ORDER No.

31/2002

*BK 1269 707.107*

in the Ward of QUAYAGWAYARE.....

SURVEY OFFICE,

MARCH 21<sup>st</sup> 192002

To  
MR. WINSTON RAMCHARAN T.T.S.  
Land Surveyor

The application for the undermentioned parcel of Land having been approved, I request you to set out the Boundaries, by a Traverse Survey, and according to the Land Surveyors Rules, 1935.

Names of Petitioner and Residence	ACREAGE			Boundaries
	A.	B.	P.	
SURVEY OF A PARCEL OF LAND (PRESENTLY LEASED TO PETROTRIN) SITUATED AT RIO CLARO, QUAYAGWAYARE FOR A TEST CELLULAR SITE				N. S. E. W.

Road to be reserved to provide access to

*[Signature]*  
Director of Surveys

CERTIFICATES

I certify that I checked the steel tape used on the ..... Standard on the ..... day of ..... and that I verified the compass used on the ..... day of ..... on the Port-of-Spain Referring Mark.

Land Surveyor

I certify that I ran all the lines charged for myself and strictly observed Rule 10 and that - pillars and 4 irons were placed by me on the survey.

Pillars were taken at

*[Signature]*  
Land Surveyor

Sta.	Field	Deducted	Chain- m	N.	S.	E.	W.	Sta.	Meridian	Perpen- dicular	Double Longitudes	North Products	South Products	Sta.	Co-ordinates
C	258° 28'		30.48					C		C-1	4562.6	2915.691	335		
D	348° 28'		15.24					D		B4 = 4.82	5345				
E	78° 28'		30.48					E		D.S.F = 2.00	E-30				
F	168° 38'		15.24					F		Area = 464.5 m <sup>2</sup>					
				Area =		<u>464.5 m<sup>2</sup></u>									
										comp. eld.					
										Anthony's school					



FIELD NOTES

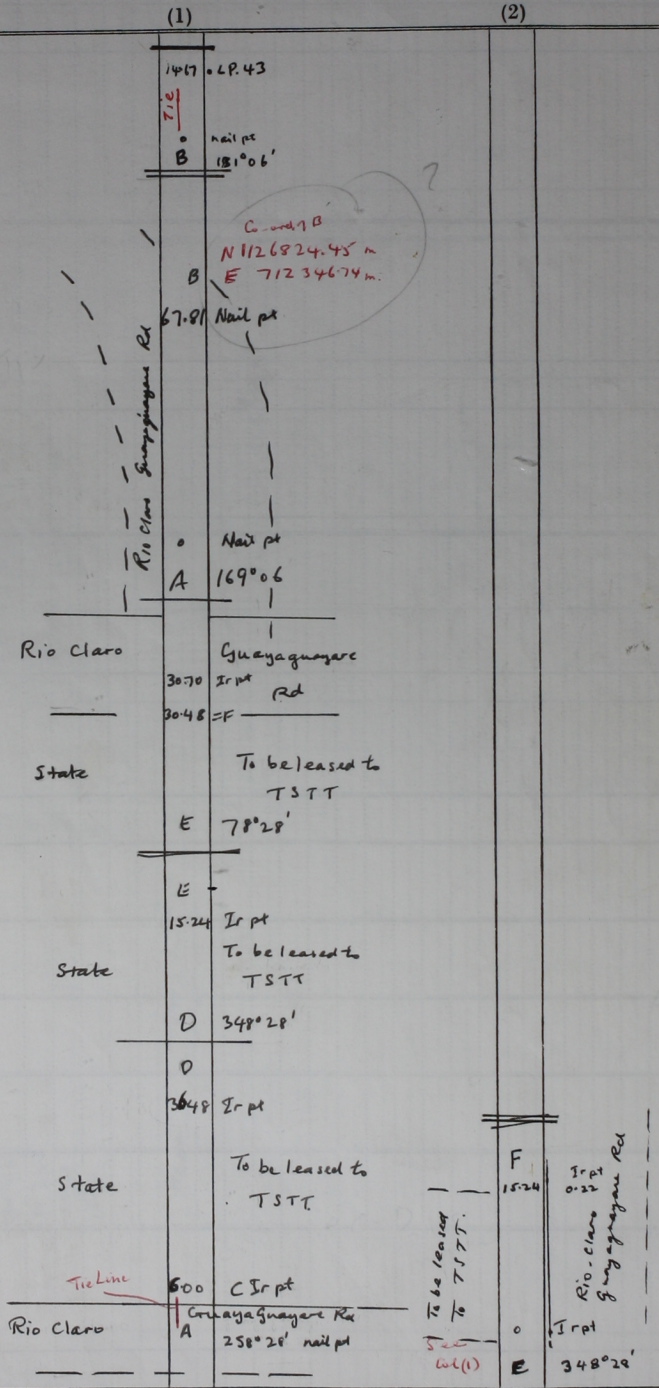

Borgs are Cassini grid based on Salar obs.  
Denotes Ir pt except otherwise stated  
Distances in metres

Ward of Guayaquayare  
Cantón of Mayro  
Cadastral sheet