

M.P.

L. & S. 2/1/4 SUR 16 LOT #147 TEMP

Plaus

SURVEY ORDER No.

29/2002

Bk 1269 178

In the Ward of ST. ANNS

SURVEY OFFICE,

APRIL 11th 19 2002

To

MR. MICHAEL AWANG T.T.L.
Land Surveyor

The application for the undermentioned parcel of Land having been approved, I request you to set out the Boundaries, by a Traverse Survey, and according to the Land Surveyors Rules, 1935.

Names of Petitioner and Residence	ACREAGE			Boundaries
	A.	B.	P.	
SURVEY OF A PARCEL OF LAND AT #147 LADY YOUNG AVENUE MORUANT FOR A LEASE TO MS. THERESA CHARLES				N. S. E. W.

Road to be reserved to provide access to

[Signature]
Director of Surveys

CERTIFICATES

I certify that I checked the steel tape used on the Standard on the day of and that I verified the compass used on the day of on the Port-of-Spain Referring Mark.

Land Surveyor

I certify that I ran all the lines charged for myself and strictly observed Rule 10 and that — pillars and 3 irons were placed by me on the survey.

Pillars were taken at

Land Surveyor

[Signature] T.T.L.S.

AREA TO BE LEASED TO THERESA CHARLES

Sta.	Field	Deducted	Chain (m)	N.	S.	E.	W.	Sta.	Meridian	Perpen- dicular	Double Longitudes	North Products	South Products	Sta.	Co-ordinates (m) N E
C	23° 10'		12.67					C		C-D 115) 269.4				C	1000.00
E	20° 00'		7.59					E		Bx = 194.2830				E	1011.65
F	20° 06'		12.51					F		DIST = 2.67 E-3				F	1014.25
B	11° 10'		7.13					B		Area = 9.24 m ²				B	1002.58
								C						C	1000.00
<p>AREA = 92.6 m²</p> <p>Comp. kept. Anthony L. Charles</p>															

FIELD NOTES

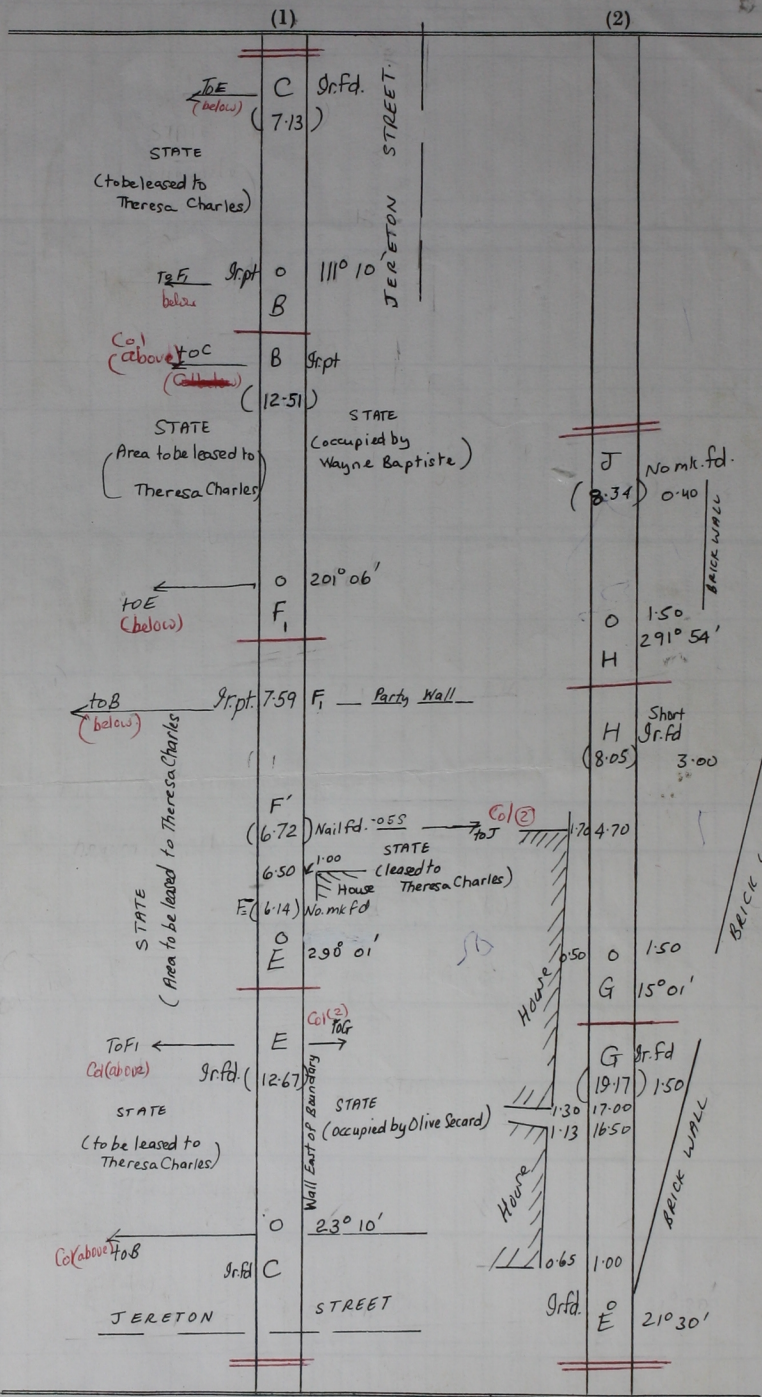

Cad. Sheet : B171, 23B, 21a

Ward of: St. Ann's.

County of: St. George.

SEE PLAN : BH20, LOT #24.

Bearings are Cassini Grid, based on Solar Obs.
DISTANCES ARE IN METRES.

SURVEYED IN APRIL, 2002 for a lease to
THERESA CHARLES BY THE STATE.