

M.P.....

L. & S.-83

L. & S...6/6/39.....

Splaw

SURVEY ORDER No.

18 192002

BK 1269 78. 156

In the Ward of GUAYAGUAYARE

SURVEY OFFICE,

MARCH 12th

192002

To

MR. HARVEY RAMREKHA TTY

Land Surveyor

The application for the undermentioned parcel of Land having been approved, I request you to set out the Boundaries, by a Traverse Survey, and according to the Land Surveyors Rules, 1935.

Names of Petitioner and Residence	ACREAGE			Boundaries
	A.	B.	P.	
SURVEY OF A PARCEL OF LAND FOR COMMERCIAL LEASE SITUATED AT ISTHMUS ROAD CALEOTA POINT, GUAYAGUAYARE FOR GULF PETROLEUM SERVICES CO. LTD.				N. S. E. W.

Road to be reserved to provide access to

[Signature]
Director of Surveys

CERTIFICATES

I certify that I checked the steel tape used on theStandard on the..... day of..... and that I verified the compass used on the..... day of on the Port-of-Spain Referring Mark.

Land Surveyor

I certify that I ran all the lines charged for myself and strictly observed Rule 10 and that — pillars and *4* irons were placed by me on the survey.

Pillars were taken at

[Signature]
Land Surveyor

Sta.	Field	Deducted	Chain metres	N.	S.	E.	W.	Sta.	Meridian	Perpendicular	Double Longitudes	North Products	South Products	Sta.	Co-ordinates
D	46° 49'	E 45' N	242.81	166.16	73.92	177.05		C		177.05	177.05	29418.6			
C	136° 49'	S 43' E	100.00		166.16	68.43		B		245.48	422.53	30810.9			
B	226° 49'	N 43' S	242.81		166.16		177.05	A		68.43	313.91	52159.3			
A	316° 49'	S 43' W	100.00	72.92			68.43	D		0.00	68.43	4989.9			
				339.08	229.08	245.48	245.48			490.96	981.92	34408.5	82970.2		
													34408.5		
													2.4 48561.7		
													24280.9		
												Area. 34281 ha			

comp. chkd.
 GW by bacm

Sta. Co-ordinates
 Meridian
 Perpendicular

FIELD NOTES

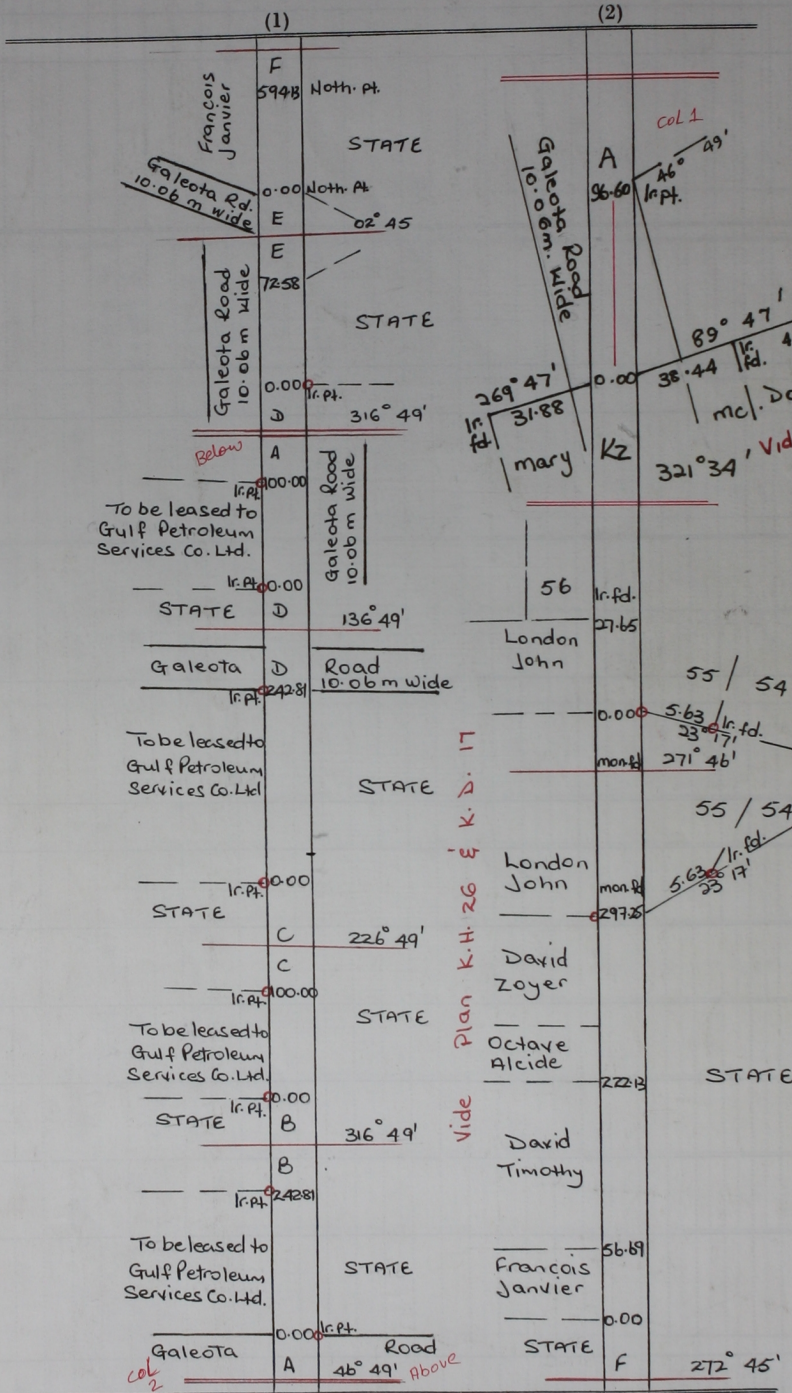

Bearings are cassini grid based on solar obs.
 Distances are in metres.
 Surveyed in April 2002 to be leased To Gulf Petroleum Services Co. Ltd.

Ward of Guayaguayare
 County of Mayaro
 Cadastral Sheet (H.15.M) 66
 4f