

M.P.

L. & S.—53

L. & S. 16/11/35 G.F.

SURVEY ORDER No.

96/2001

In the Ward of Tacariguh

BK 1269/145

SURVEY OFFICE,

11th June 2001

To

Mr. Ron Gajadkar T.T.S
Land Surveyor

The application for the undermentioned parcel of Land having been approved, I request you to set out the Boundaries, by a Traverse Survey, and according to the Land Surveyors Rules, 1935.

Names of Petitioner and Residence	ACREAGE			Boundaries
	A.	B.	F.	
<u>Survey of a parcel of land at Raghur Street, Curape, for W.A.S.A</u>	<u>0.6</u>	<u>ha</u>		N. S. E. W.

Road to be reserved to provide access to

[Signature]
Director of Survey

CERTIFICATES

I certify that I checked the steel tape used on the Standard on the day of and that I verified the compass used on the day of on the Port-of-Spain Referring Mark.

Land Surveyor

I certify that I ran all the lines charged for myself and strictly observed Rule 10 and that pillars and irons were placed by me on the survey. Pillars were taken at

Land Surveyor



FIELD NOTES

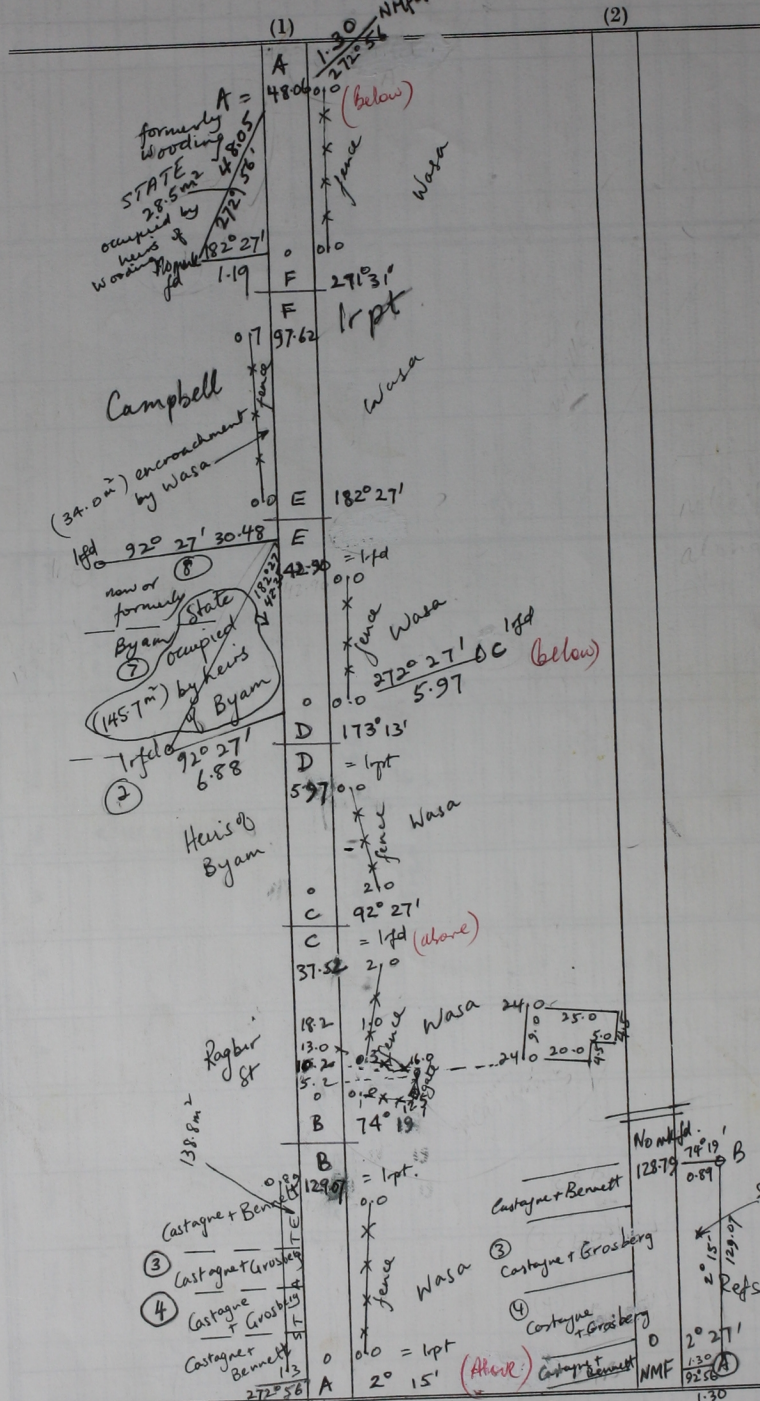

WARD OF TACARICUA
 County of ST GEORGE
 CADASTRAL SHEET 23C, B. 18 I.
 26

Bearings are Cassini Grid
 based on Solar Obs
 Distances are in metres
 Surveyed in June 2001
 for W.A.S.A.