

M.P.....

L. & S.—53

7 plans

L. & S. 1112 SUB H/44

SURVEY ORDER No.

31 12001

Bk 1269: 170

In the Ward of... ST. ANNS.....

SURVEY OFFICE,

FEBRUARY 6<sup>th</sup> 192001

To

MR PETER GOODRIDGE TINS  
Land Surveyor

The application for the undermentioned parcel of Land having been approved, I request you to set out the Boundaries, by a Traverse Survey, and according to the Land Surveyors Rules, 1935.

Names of Petitioner and Residence	ACREAGE			Boundaries
	A.	B.	P.	
SURVEY OF A PARCEL OF LAND, LOT 44, LA PASTORA LAND SETTLEMENT, FOR ENDELL THOMAS AND CURTIS THOMAS FOR A STANDARD AGRICULTURAL LEASE (APPROX 1.0 HECTARE).				N. S. PLAN M 3 94 E. W.

Road to be reserved to provide access to

*[Signature]*  
Director of Surveys

CERTIFICATES

I certify that I checked the steel tape used on the .....Standard on the..... day of..... and that I verified the compass used on the..... day of ..... on the Port-of-Spain Referring Mark.

Land Surveyor

I certify that I ran all the lines charged for myself and strictly observed Rule 10 and that — pillars and ~~wa~~(<sup>wa</sup>) iron# were placed by me on the survey. Pillars were taken at

*[Signature]*  
Land Surveyor



Survey Order No... 31/2001

Ward of St. Anns

FIELD NOTES

County of St. George

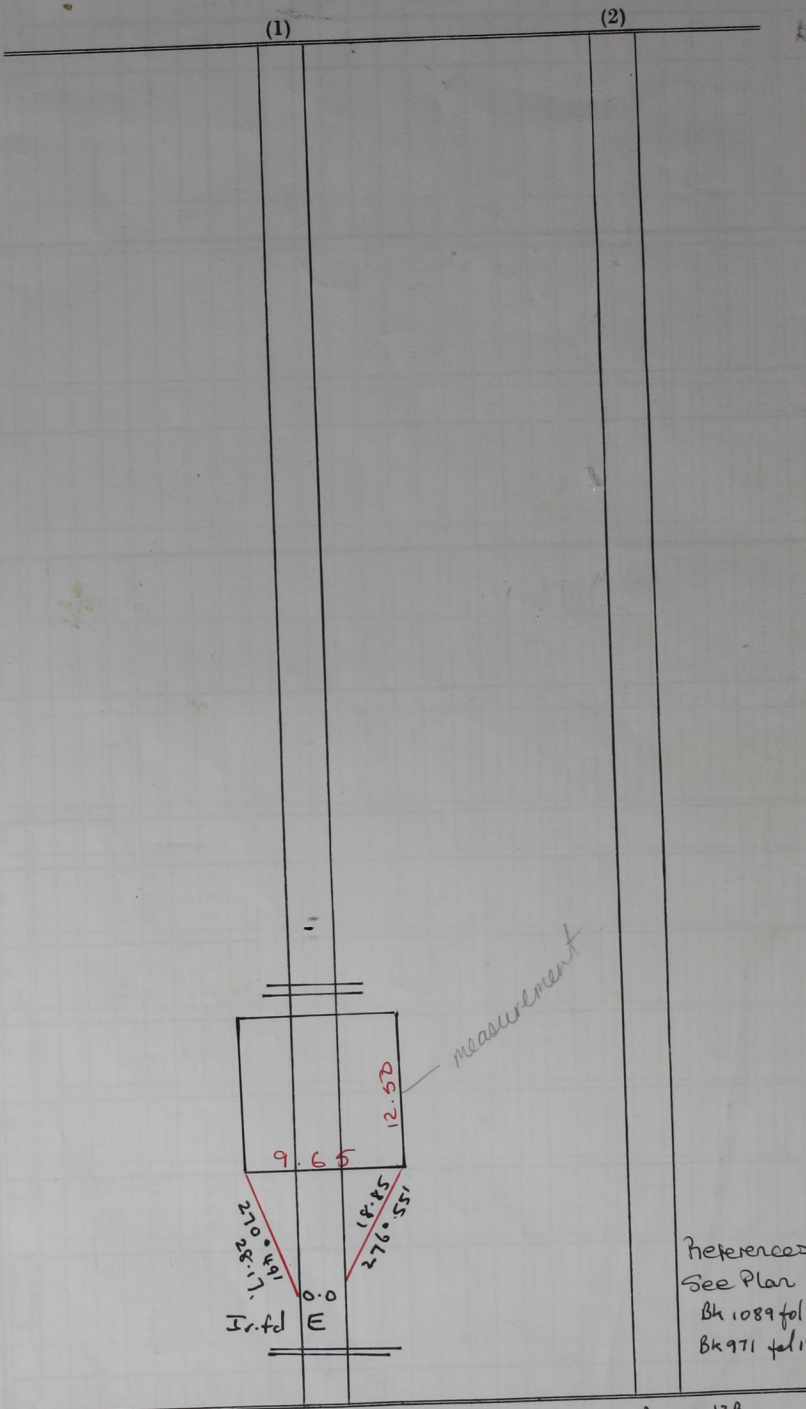

References :  
 See Plan M.T. 94  
 Bk 1089 fol 83  
 Bk 971 fol 178

-Bearings are Cassini based on Solar Ob'n.  $\frac{138}{745414}$

Distances are in METRES.

Surveyed in December 2000 to be leased to Endell Thomas & Curtis Thomas