

M.P. ....

L. & S.—53

8/plan

L. & S. 11/1654

SURVEY ORDER No.

171/2001

Copy to BK 1290 fol. 127

In the Ward of... ST. ANNS

SURVEY OFFICE,

OCTOBER 11<sup>th</sup> 1920

To

MR. HAKEEB NANDALAL TTLS.  
Land Surveyor

The application for the undermentioned parcel of Land having been approved, I request you to set out the Boundaries, by a Traverse Survey, and according to the Land Surveyors Rules, 1935.

Names of Petitioner and Residence	ACREAGE			Boundaries
	A.	B.	F.	
SURVEY OF A PARCEL OF LAND L.P. 62 CAPRIETA ROAD, LA PASTORA LAND SETTLEMENT, SANTA CRUZ FOR A STANDARD AGRICULTURAL LEASE FOR AFZAL MOHAMMED.				N. S. E. W.

Road to be reserved to provide access to

*[Signature]*  
Director of Surveys

CERTIFICATES

I certify that I checked the steel tape used on the .....Standard on the..... day of..... and that I verified the compass used on the..... day of ..... on the Port-of-Spain Referring Mark.

Land Surveyor

I certify that I ran all the lines charged for myself and strictly observed Rule 10 and that pillars and irons were placed by me on the survey. Pillars were taken at

*Hakeeb Nandalal*  
Land Surveyor

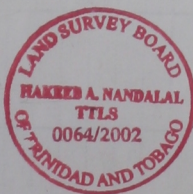





S.O. 171/2001

FROM	TO	DEG	MIN	DIST	EASTINGS	NORTHINGS	POINT
	A				500.00	500.00	A
A	Mon.fd	109	00	10.61	510.03	496.55	Mon.fd
Mon.fd	Ir.fd	76	30	78.50	586.36	514.87	Ir.fd
Ir.fd	Ir.pt	348	30	85.20	569.38	598.36	Ir.pt
Ir.pt	Ir.pt	285	04	131.07	442.81	632.43	Ir.pt
Ir.pt	Ir.pt	195	49	22.04	436.81	611.23	Ir.pt
Ir.pt	Ir.pt	178	26	49.47	438.16	561.77	Ir.pt
Ir.pt	No.mk	126	59	38.03	468.54	538.90	No.mk
No.mk	A	141	00	50.01	500.01	500.03	A

Misc. 0.01 0.03

Area = **1.3623 ha**

FIELD NOTES

(1) (2)

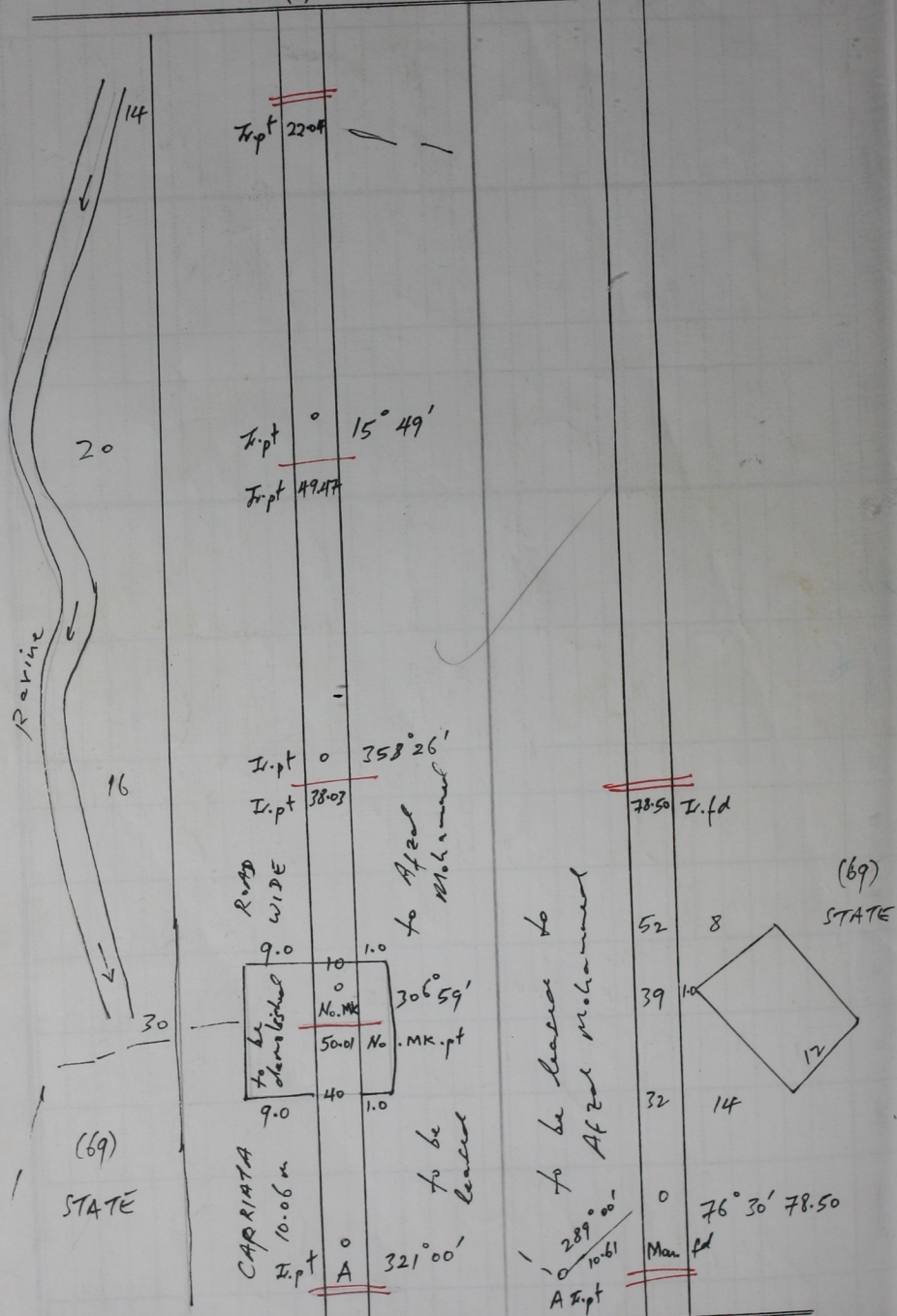

Cadastral Sheet 13B, B.12.A  
21C

Ward of St. Annas  
 U.S.-2000-36/85.-222 County of St. George  
 Distances are in Metres  
 B.T.S. are Cassini Grid based on G.C.A.

Surveyed in January 2002  
 to be leased to Afzal Mohamud  
 "La Pastora Estate"  
 Ref. Plan M.J. 94  
 Bk. 1035:166  
 S.O. 133/1969