

M.P.

L. & S.—53

L. & S. 116139

9 plan

SURVEY ORDER No.

153 12001

BK 1269 Vol. 49

In the Ward of Charana

SURVEY OFFICE,

SEPTEMBER 6th 1930

To

MR. HAKEEB NANDALAL T.T.S.
Land Surveyor

The application for the undermentioned parcel of Land having been approved, I request you to set out the Boundaries, by a Traverse Survey, and according to the Land Surveyors Rules, 1935.

Names of Petitioner and Residence	ACREAGE			Boundaries
	A.	B.	P.	
SURVEY OF A PARCEL OF LAND SITUATED AT 22 1/4 MM NAPARIMA MAYARD ROAD, POOLE (≈ 3.2 HA) FOR A STANDARD AGRICULTURAL LEASE FOR SOHAN RAMDATH				N. S. E. W.

Road to be reserved to provide access to

[Signature]
Director of Surveys

CERTIFICATES

I certify that I checked the steel tape used on theStandard on the..... day of..... and that I verified the compass used on the..... day of on the Port-of-Spain Referring Mark.

Land Surveyor

I certify that I ran all the lines charged for myself and strictly observed Rule 10 and that pillars and irons were placed by me on the survey.

Pillars were taken at

Land Surveyor

Hakeeb Nandalal

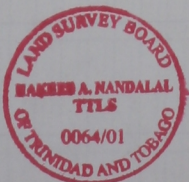

FIELD NOTES

(1)

(2)

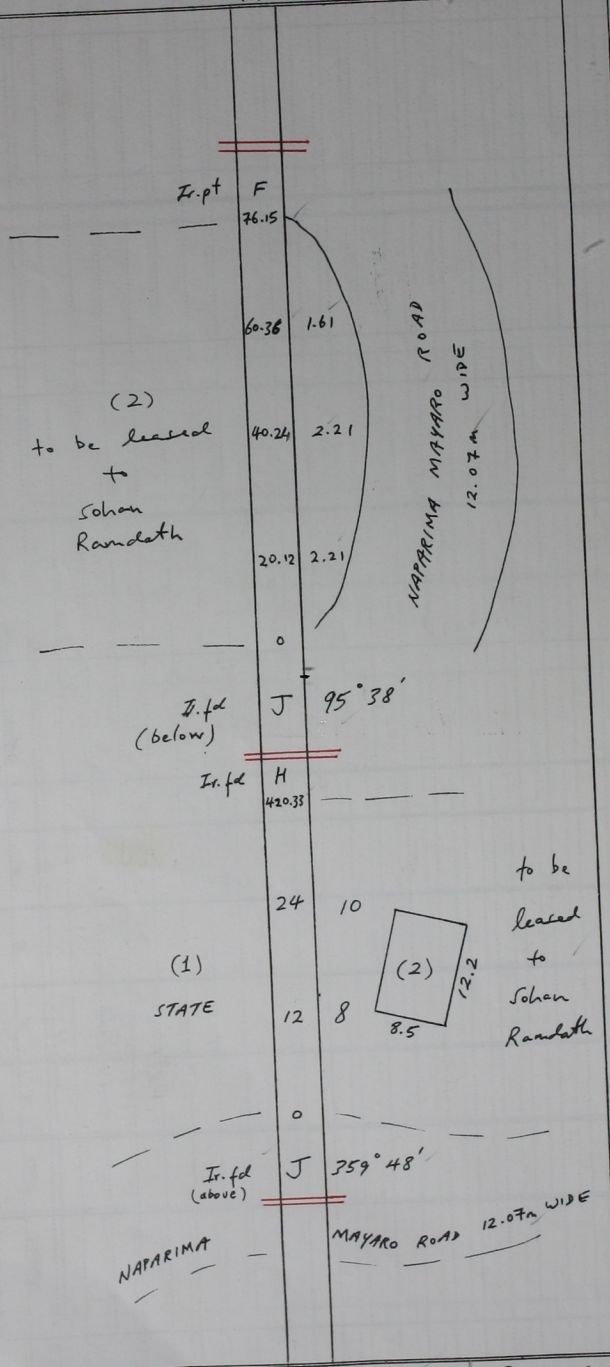

(2)
to be leased
to
Sohan
Ramdath

Ir.pt
(below)

(1)
STATE

Ir.pt
(above)

to be
leased
to
Sohan
Ramdath

Cadastral Sheet 55A, H. I. D
4/C

Surveyed in August 2001 to be leased
to SOHAN RAMDATH

Ward of Charuma
LAS-2000-36/05-22/2
County of Nariva
Distances are in meters

REF BK. 1065:34

Bearings are Cassini Grid based on Spheroid