

M.P.....

L. & S.—63

L. & S. 2/1/7... 54315

Plans

SURVEY ORDER No.

134/2001

Bk 1269 Fol. 59

In the Ward of BLANCHISSEUSE.....

SURVEY OFFICE,

APRIL 3rd..... 192002

To

MR. KEITH SCOTT T.T.L.S.
Land Surveyor

The application for the undermentioned parcel of Land having been approved, I request you to set out the Boundaries, by a Traverse Survey, and according to the Land Surveyors Rules, 1935.

Names of Petitioner and Residence	ACREAGE			Boundaries
	A.	R.	P.	
SURVEY OF A PARCEL OF LAND SITUATED AT LOT NO. 15 BRASSO SECO VILLAGE, BLANCHISSEUSE FOR A GRANT OF RESIDENTIAL LEASE FOR VALARLY PACHELO				N. S. E. W.

Road to be reserved to provide access to

[Signature]
Director of Surveys

CERTIFICATES

I certify that I checked the steel tape used on theStandard on the..... day of..... and that I verified the compass used on the..... day of on the Port-of-Spain Referring Mark.

Land Surveyor

I certify that I ran all the lines charged for myself and strictly observed Rule 10 and that pillars and irons were placed by me on the survey.

Pillars were taken at



[Signature]
Land Surveyor

T. T. L. S

24/04/2002

FIELD NOTES

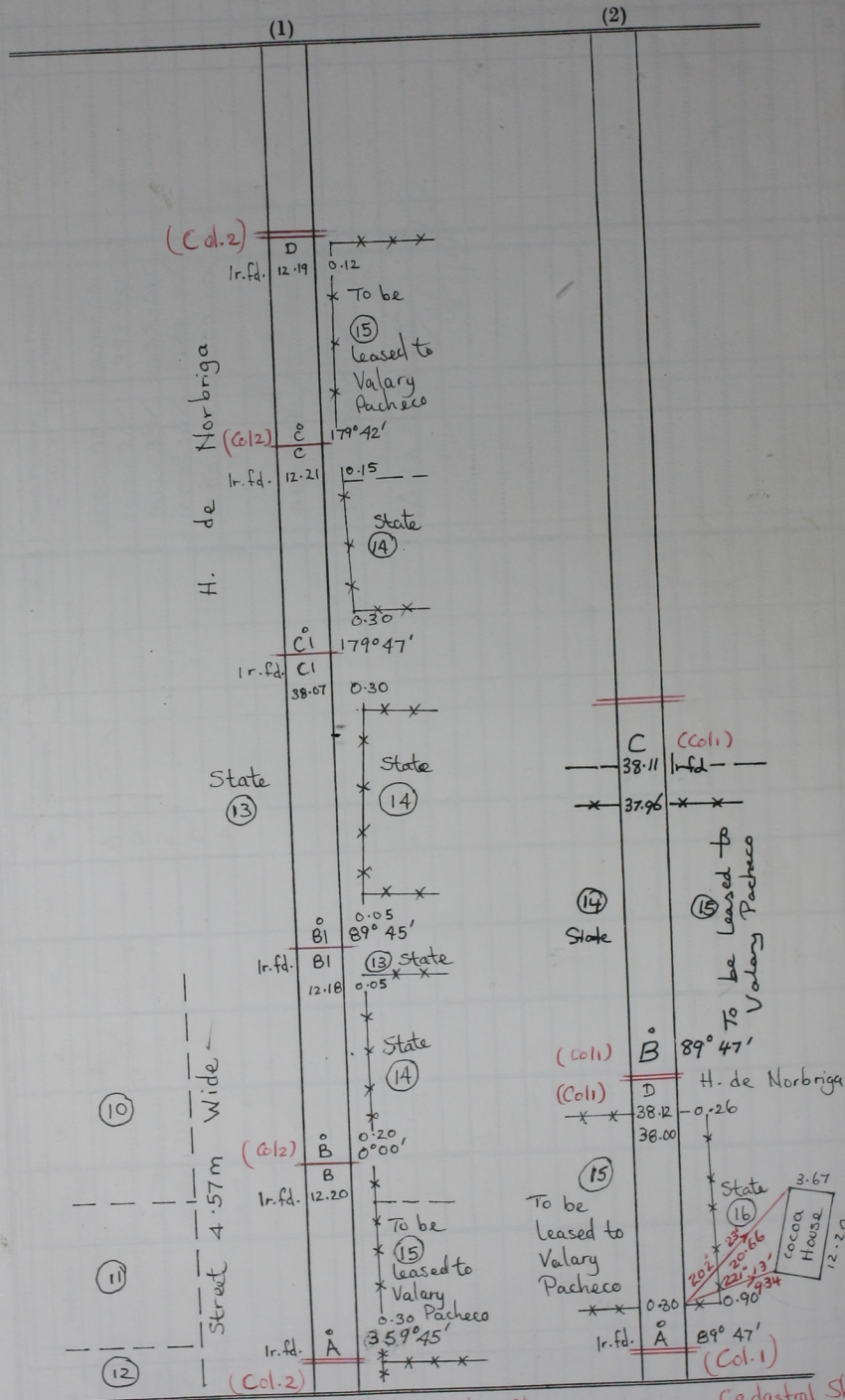

Bearings are Cassini Grid based on Solar Obs.
 To obtain compass bearings add 14 minutes
 Survey in July 2001 to be leased to Valary Pacheco
 LAS-2000-36/85-22/2
 Brasso Seco Village :

Cadastral Sheet B101
 Ward of Blanchisseau
 County of St. George
 Vide Plan B.E. 8
 Distances are in meters