

M.P.....

L. & S. 2/1/22 Sub 64/

plans

SURVEY ORDER No.

101/2001

1269 7A 79

In the Ward of Tacorigua

SURVEY OFFICE,

11th June 2001

To Mr. Ganeshdatt Ramcharan
Land Surveyor T.T.S

The application for the undermentioned parcel of Land having been approved, I request you to set out the Boundaries, by a Traverse Survey, and according to the Land Surveyors Rules, 1935.

Names of Petitioner and Residence	ACREAGE			Boundaries
	A.	R.	F.	
<i>Survey of a parcel of land situate at the corner of Wallis and Evans Streets, St. Augustines for a residential house to the occupant Mr. Basdai Vidyaarthi</i>				N. S. E. W.

Road to be reserved to provide access to

[Signature]
Director of Surveys

CERTIFICATES

I certify that I checked the steel tape used on the Standard on the day of and that I verified the compass used on the day of on the Port-of-Spain Referring Mark.

Land Surveyor

I certify that I ran all the lines charged for myself and strictly observed Rule 10 and that 2 pillars and 2 irons were placed by me on the survey.

Pillars were taken at

Ganeshdatt Ramcharan
Land Surveyor

FIELD NOTES

(1)

(2)

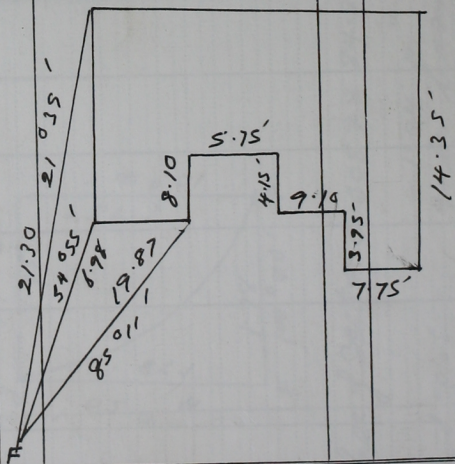

Bearings are Cassini based on solar obs.
 Dist in metres. Survey 30th Oct 2001 to be
 leased to BABDEO VIDYARTHI
 Vide BK 1160 fol 208