

M.P.....

L. & S. 11612 sub 7 LOT 14A.

SURVEY ORDER No.

74/2000

spans
BR 1257 77. 65

In the Ward of..... NAPARIMA.

SURVEY OFFICE,

..... APRIL 5th 192000.

To

MR BRIAN MOSES T.T.L.:
Land Surveyor

The application for the undermentioned parcel of Land having been approved, I request you to set out the Boundaries, by a Traverse Survey, and according to the Land Surveyors Rules, 1935.

Names of Petitioner and Residence	ACREAGE			Boundaries
	A.	B.	P.	
SURVEY OF A PARCEL OF LAND SITUATE AT SENA 4 (A) (B) RID CLARO LAND SETTLEMENT # 2 FOR RE-GRANT OF STANDARD AGRICULTURAL LEASE FOR MONTALAL ROOPNARINE and DULARIE ROOPNARINE				N. S. E. W.

Road to be reserved to provide access to

Michael Jones
F.A. Director of Surveys

CERTIFICATES

I certify that I checked the steel tape used on theStandard on the..... day of..... and that I verified the compass used on the..... day of on the Port-of-Spain Referring Mark.

Land Surveyor

I certify that I ran all the lines charged for myself and strictly observed Rule 10 and that pillars and 5 irons were placed by me on the survey.

Pillars were taken at

Brian Moses
Land Surveyor



Sta.	Bearing	Distance	Chain	N.	S.	E.	W.	Sta.	Meridian	Perpendicular	Double Longitudes	North Products	South Products	Sta.	Cumulative
AREA OF LOT # 14A															
X2	134° 41'	169.56						T1							
T1	89° 41'	128.95						G							
G	00° 03'	169.56						F							
F	264° 49'	129.65						X2							
AREA = 2,1906 sq. ✓															
AREA OF LOT # 14B															
E	206° 49'	32.19						D							
D	116° 49'	43.80						C							
C	30° 34'	32.26						B							
B	276° 49'	45.91						E							
AREA = 0,1444 sq. ✓															
<p style="text-align: right;"> <i>one comp. chd.</i> <i>A. H. Long</i> <i>22.15.12.00</i> </p>															

$C = 2148.150$
 $A = 21905.8 m$

$C = 2165.1104$
 $A = 21443.9$

FIELD NOTES

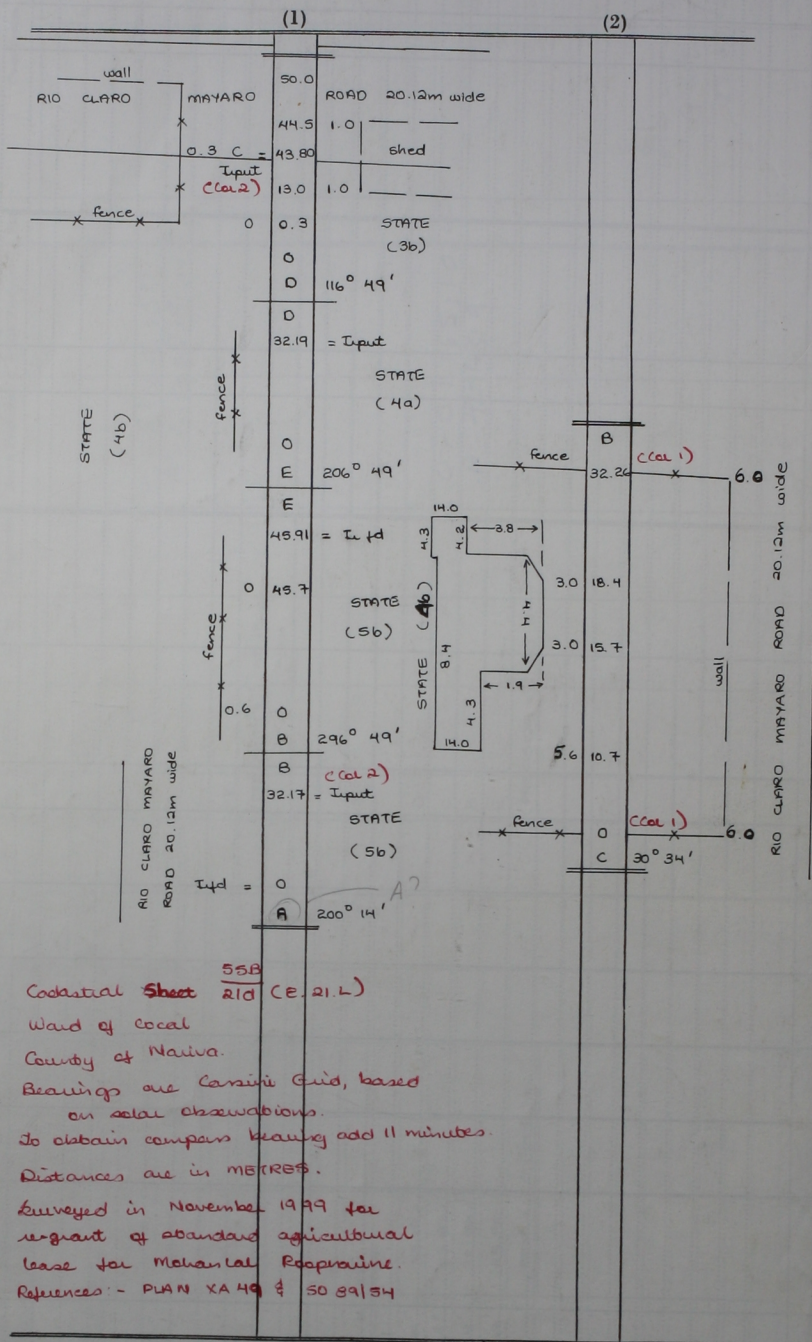

Cadastral Sheet 55B RIO (E. 21.L)

Ward of local County of Naiva.

Bearings are Cassini Grid, based on solar observations.

To obtain compass bearing add 11 minutes.

Distances are in METRES.

Surveyed in November 1999 for regrant of standard agricultural lease for Mohantal Reoprouine.

References: - PLAN XA 49 & 50 89/54