

M. S. No. 1011249.004. II

plans

SURVEY ORDER No.

57 12000

BE 1257 78. 161

In the Ward of DIEGO MARTIN

SURVEY OFFICE,

MARCH th14 192000

To

MR. HECTOR SANJER T.T.S.
Land Surveyor

The application for the undermentioned parcel of Land having been approved, I request you to set out the Boundaries, by a Traverse Survey, and according to the Land Surveyors Rules, 1935.

Names of Petitioner and Residence	ACREAGE			Boundaries
	A.	R.	P.	
SURVEY OF PARCEL OF LAND OFF SE JADE CARDEDS, DIAMOND VALLE DIEGO MARTIN. LOT NO. 467 OCCUPIED BY W/O C. TAYLOR FOR THE STATE.				N. S. E. W.

Road to be reserved to provide access to

Hector Sanjer
Director of Surveys

CERTIFICATES

I certify that I checked the steel tape used on the Standard
on the day of
and that I verified the compass used on the
day on on the Port-of-Spain Referring Mark.

Land Surveyor

I certify that I ran all the lines charged for myself and strictly observed
Rule 11 and that — pillars and 2 irons were placed by me on the survey.
Pillars were taken at

H. Sanjer
Land Surveyor

FIELD NOTES

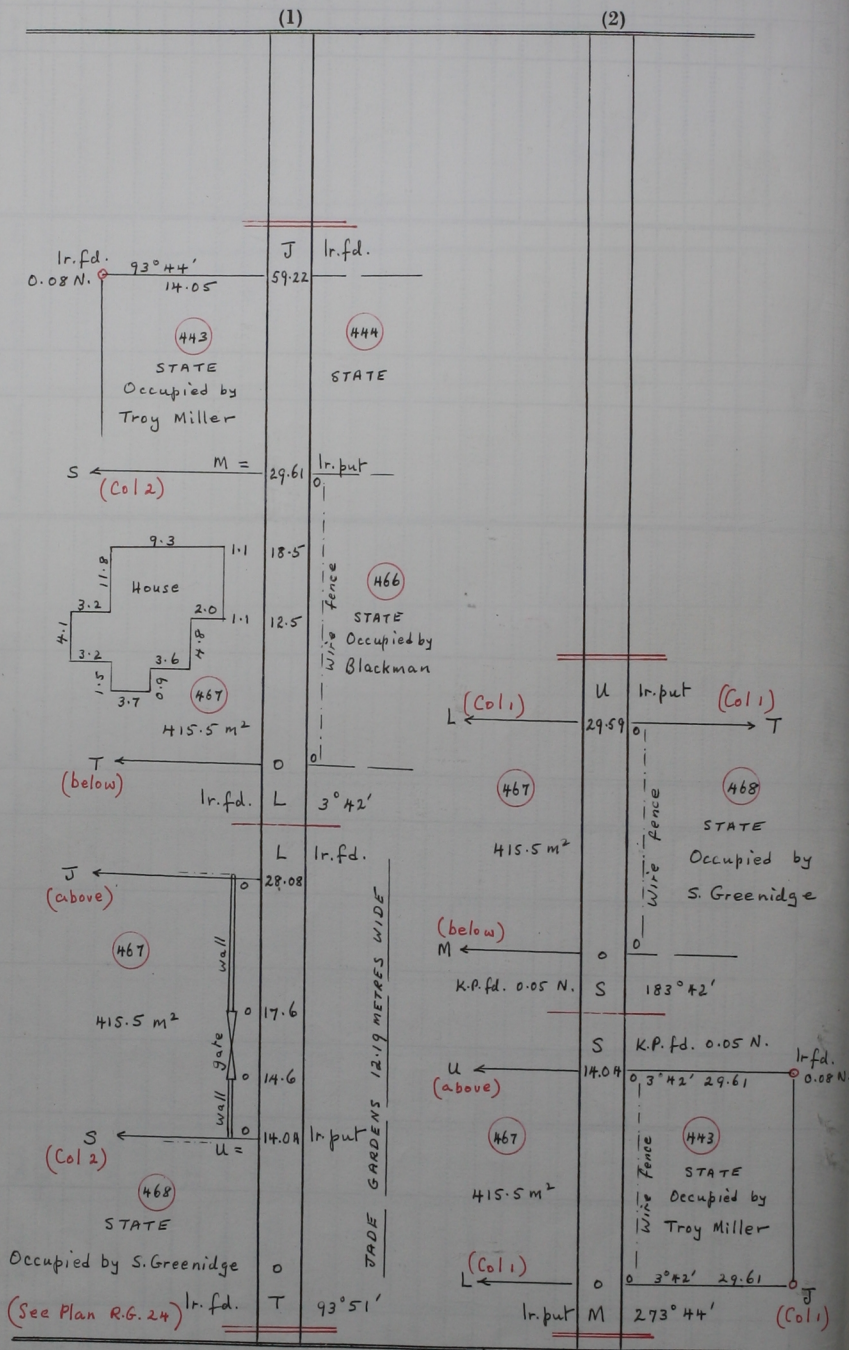

Bearings are Cassini Grid based on solar obs.
 Distances are in Metres. Surveyed in July 2000 for the STATE
 Ward of Diego Martin, County of St. George
 Cadutral Sheet A.14.L. 13A
 3/c