

M.P.....

L. & S.—63

8 plans
H.D.W.

L. & S. 13/2 Sub 5, LOT 19

SURVEY ORDER No.

41/2000

BK 1269 70.131

In the Ward of.....

SURVEY OFFICE,

MARCH 1st 192000

To

MR WINSTON DOYLE TTLS.
Land Surveyor

The application for the undermentioned parcel of Land having been approved, I request you to set out the Boundaries, by a Traverse Survey, and according to the Land Surveyors Rules, 1935.

Names of Petitioner and Residence	ACREAGE			Boundaries
	A.	B.	P.	
SUBJECT OF A PARCEL OF LAND LOT NO. 19, GORDON MILLER LAND SETTLEMENT, FOR LEASE TO ABRAHAM JOSEPH.				N. S. E. W.

Road to be reserved to provide access to

A. Jones
Director of Surveys

CERTIFICATES

I certify that I checked the steel tape used on theStandard on the..... day of..... and that I verified the compass used on the..... day of on the Port-of-Spain Referring Mark.

Land Surveyor

I certify that I ran all the lines charged for myself and strictly observed Rule 10 and that pillars and irons were placed by me on the survey.

Pillars were taken at

W. A. Doyle
Land Surveyor

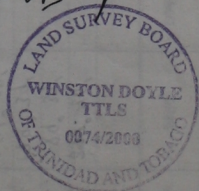

Sta.	Field	Deducted	Chain	N.	S.	E.	W.	Sia.	Meridian	Propn. of Angle	Dip of Slope	North Products	South Products	Sia.	Coordinates
C1										E	N	1800.00	1000.00		
												997.89	1345.17		
												1072.56	1345.76		
												1074.90	963.25		
												1000.00	999.99		
Y3	292° 41'	/	77.59				Y3			1000.00	1000.00	ΔE = 0.00	ΔN = -0.01		
Z3	313° 30'	/	3.97				Z3			928.41	1029.92	Precision = 1/			
H4	359° 39'	/	357.46				H4			925.55	1032.63				
C4	89° 53'	/	74.43				C4			923.39	1387.09				
B4	178° 39'	/	387.77				B4			997.82	1387.67	Area = 27.19 m ²			
							Y3			1000.18	999.91	Area to Road = 1/2 X 16 X 28.58 = 228.32			
										0E = -0.18	0N = 0.09				
										Precision = 1/143.60					
	Area to Road:		89.66 m ²							Area = 27675.99 m ²					
	200 x 468.7 =		94277 m ²							Traverse	22.4'	2.01			
	1/2 (-01 + 503) 2012 =		70.82 m ²							Area = 27675.99 m ²					
	1/2 (-03 + 744) 1060 =		66.09 m ²							27675.99					
	1/2 (-44 + 39.94) =		39.31 m ²							27675.99					
	Traverse 223' 30" 7.44, 312' 30" 3.94, 100° 39' 9.33									27675.99					
	Total Area to Road		260.47 m ²							27675.99					
			285.22 m ²							27675.99					
			280.77 m ²							27675.99					
										27675.99					
										27675.99					
										27675.99					
										27675.99					

Oil camp. Cled.
 Ambrosy bakind
 9428.2000

Sta. Field Chain N. S. E. W. Sia. Meridian Person/s

Survey Order No. 49/2000
 L.S. No. 1/3/2 Sub 5 LOT 19
FIELD NOTES

Ward of Manzanilla
 County of St. Andrew

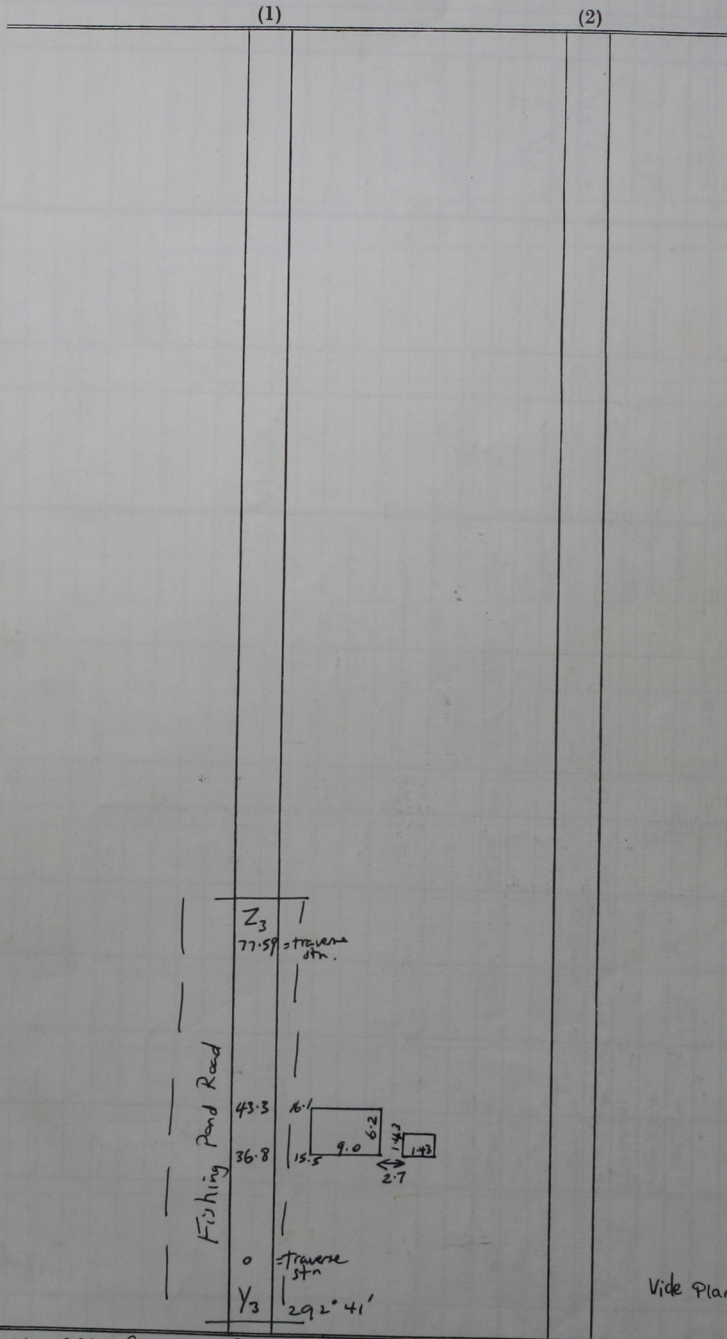

Vide Plan X.D. 71

Bearings are Cassini Grid based on Solar Observations
 Distances are in metres.

Surveyed in March 2000 at the request of the state to be leased
 to Joseph Abraham Joseph