

8 plans

M.P.....
L. & S. 1011249 Vol II

SURVEY ORDER No.

45 2000

SK 1257 70. 195

In the Ward of DIEGO MARTIN

SURVEY OFFICE,

MARCH 1st 192000

To
MR ALBERT HAYNES T.T.S.
Land Surveyor

The application for the undermentioned parcel of Land having been approved, I request you to set out the Boundaries, by a Traverse Survey, and according to the Land Surveyors Rules, 1935.

| Names of Petitioner and Residence | ACREAGE | | | Boundaries |
|--|---------|----|----|----------------------|
| | A. | B. | P. | |
| SURVEY OF A PARCEL OF LAND SITUATED AT 16 CARNELIAN GARDENS, DIAMOND VALE, DIEGO MARTIN OCCUPIED BY KAL A. WILLIAMS FOR THE STATE (LOT NO. 430). | | | | N. S. E. W. |

Road to be reserved to provide access to

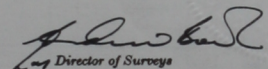
Director of Surveys

CERTIFICATES

I certify that I checked the steel tape used on theStandard on the..... day of..... and that I verified the compass used on the..... day of on the Port-of-Spain Referring Mark.

Land Surveyor

I certify that I ran all the lines charged for myself and strictly observed Rule 10 and that pillars and irons were placed by me on the survey.

Pillars were taken at

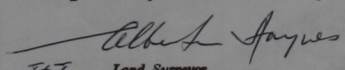
T.T.S., Land Surveyor

| Sta. | Field | Deduced | Chain | N. | S. | E. | W. | Sta. | Meridian | Perpen- dicular | Double Longitudes | North Products | South Products | Sta. | Co-ordinates |
|------|-------|---------|-------|----|----|----|----|------|--|--------------------|----------------------|----------------|----------------|------|--------------|
| C.8 | | 03° 49 | 29.57 | | | | | B8 | | | | | | | |
| B.8 | | 93° 49 | 14.82 | | | | | B9 | | | | | | | |
| B.9 | | 183° 52 | 29.57 | | | | | C.9 | | | | | | | |
| C.9 | | 273° 49 | 13.99 | | | | | C.8 | | | | | | | |
| | | | | | | | | | AREA BY COMPUTER = 414.2 SQUARE METERS | | | | | | |
| | | | | | | | | | | | | 414.104 | | | |
| | | | | | | | | | | | | C = 1/20,773 | | | |

Sta. Field Deduced Chain N. S. E. W. Sta. Meridian Perpendicular Double Longitudes North Products South Products Sta. Co-ordinates

FIELD NOTES

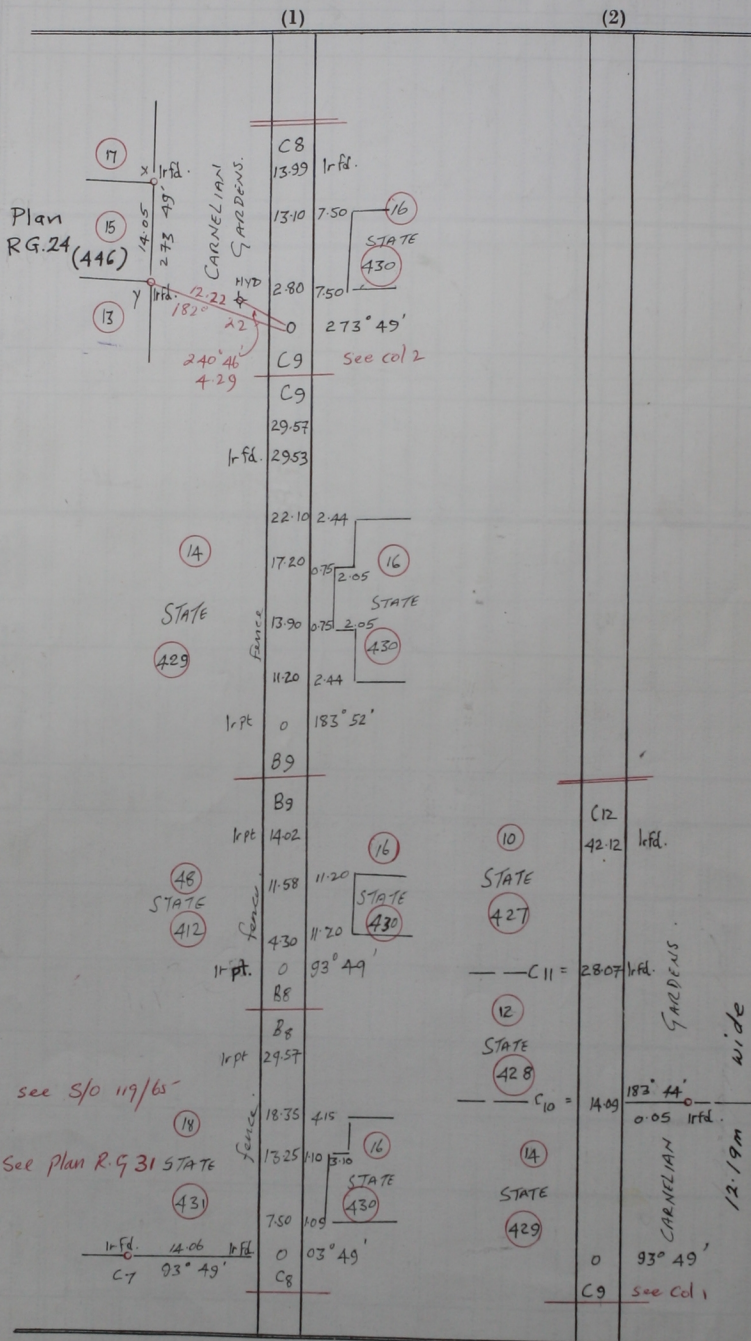

Surveyed in March, 2000
for the State

Bearings are Cassini Grid.
Distance in Metres
Bearings are based
on Solar Observations

Cad Sheet A.1A-L, 3/E
Ward of Diego Martin
County of St. George