

New specifications issued

L. & S.—53

8 plans

M.P. ....

L. & S. 2/5/3 Sub 28/31 + 32

SURVEY ORDER No.

122/2000

36 1290 77.25

In the Ward of LA BREA

SURVEY OFFICE,

APRIL 17<sup>th</sup> 192002

To W Doyle  
MR. KEITH SCOTT TTLS.  
Land Surveyor

The application for the undermentioned parcel of Land having been approved, I request you to set out the Boundaries, by a Traverse Survey, and according to the Land Surveyors Rules, 1935.

Names of Petitioner and Residence	ACREAGE			Boundaries
	A.	B.	P.	
SURVEY OF A PARCEL OF LAND SITUATED AT 31 + 32 -19 <sup>th</sup> STREET TECHIER STREET POINT FORTIN FOR A RESIDENTIAL LEASE FOR EDWARD CHARLES.				N. S. E. W.

Road to be reserved to provide access to

*Michael Jones*  
Director of Surveys

CERTIFICATES

I certify that I checked the steel tape used on the ..... Standard on the ..... day of ..... and that I verified the compass used on the ..... day of ..... on the Port-of-Spain Referring Mark.

Land Surveyor

I certify that I ran all the lines charged for myself and strictly observed Rule 10 and that ..... pillars and ..... irons were placed by me on the survey.

Pillars were taken at



*Keith M. Scott*  
Land Surveyor  
T.T.L.S.  
29/12/2000

Sta.	Field	Deducted	Chain	N.	S.	E.	W.	Sta.	Meridian Station	Perpendicular $E$	Double Longitudes $N$	North Products	South Products	Sta.	Co-ordinates
K	00° 14'		12.04						K	1000.00	1000.00				
C	90° 07'		23.20						C	1000.05	1012.04				
G	180° 13'		12.11						G	1023.25	1011.99				
I	270° 17'		23.20						I	1023.20	999.88				
									K	1000.00	1000.00				
										$PE = 20.00$	$\Delta N = 0.05$				
										Area =	280.2	$m^2$			

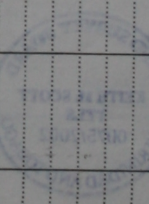

Sta. W. E. S. N. Chain Deducted Field Sta. Meridian Station Perpendicular  $E$  Double Longitudes  $N$  North Products South Products Sta. Co-ordinates

FIELD NOTES

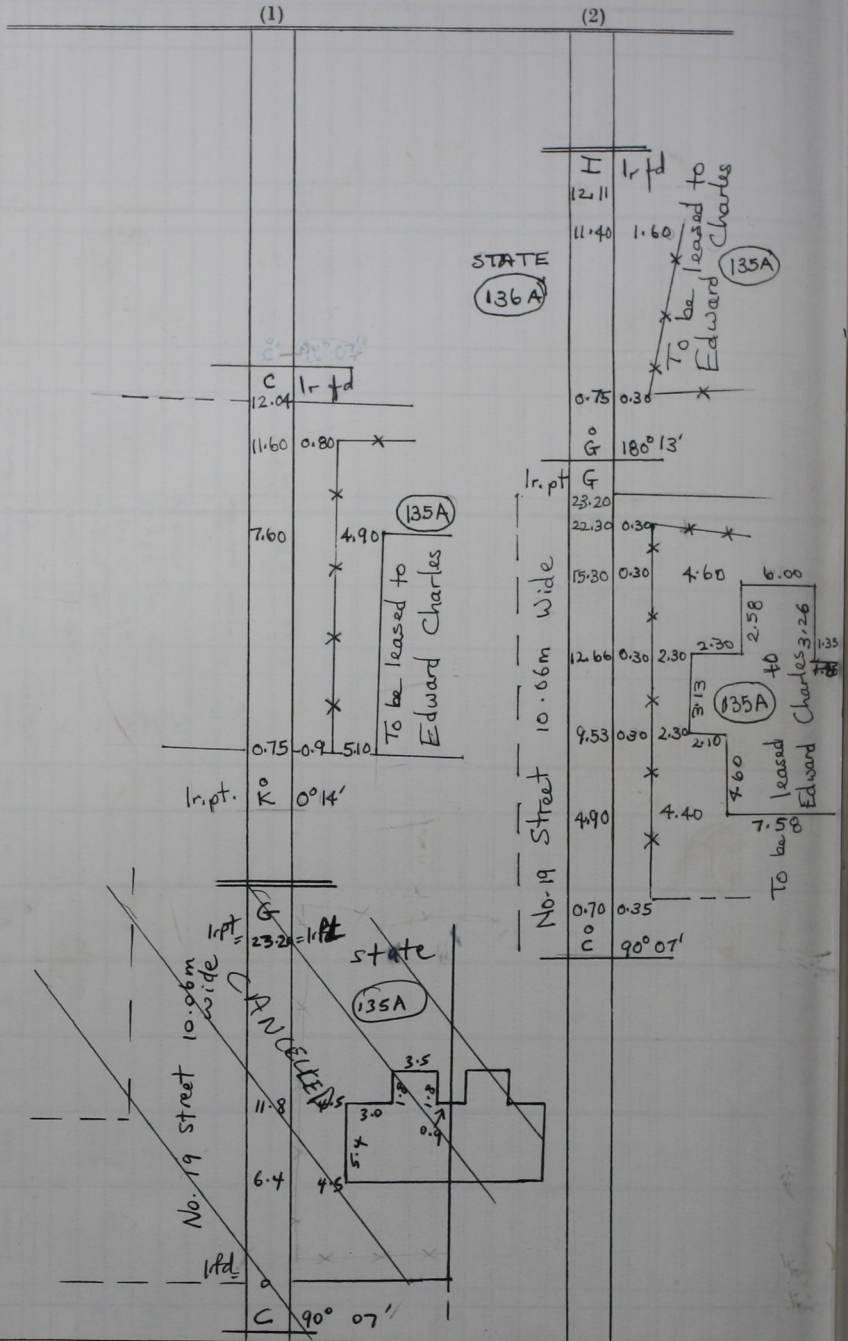

Bearings are Cassini Grid based on solar observations  
 Distances are in metres  
 Surveyed in June 2000 at the request of the State to be leased to Edward Charles  
 Vide Plan P.K. 11 and Bk. 1094 fol. 102