

M.P.....

L. & S... 2/6/103

SURVEY ORDER No.

117 / 2000

Bk 1257 Pt. 185

In the Ward of..... CHARUMA.....

SURVEY OFFICE,

..... JUNE 8th 19. 2000

To
MR. RON GAJADHAR T.T.L.S.
Land Surveyor

The application for the undermentioned parcel of Land having been approved, I request you to set out the Boundaries, by a Traverse Survey, and according to the Land Surveyors Rules, 1935.

Names of Petitioner and Residence	ACREAGE			Boundaries
	A.	R.	P.	
SURVEY OF W.A.S.A. QUARTERS KNOWN AS RIO CLARO SITUATED AT NAPARIMA MAYARO ROAD				N. S. E. W.

Road to be reserved to provide access to

[Signature]
Director of Surveys

CERTIFICATES

I certify that I checked the steel tape used on theStandard on the..... day of..... and that I verified the compass used on the..... lay of on the Port-of-Spain Referring Mark.

Land Surveyor

I certify that I ran all the lines charged for myself and strictly observed Rule 10 and that pillars and irons were placed by me on the survey. Pillars were taken at

Land Surveyor

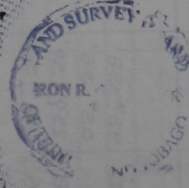
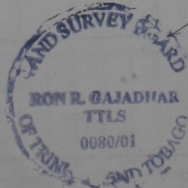

FIELD NOTES

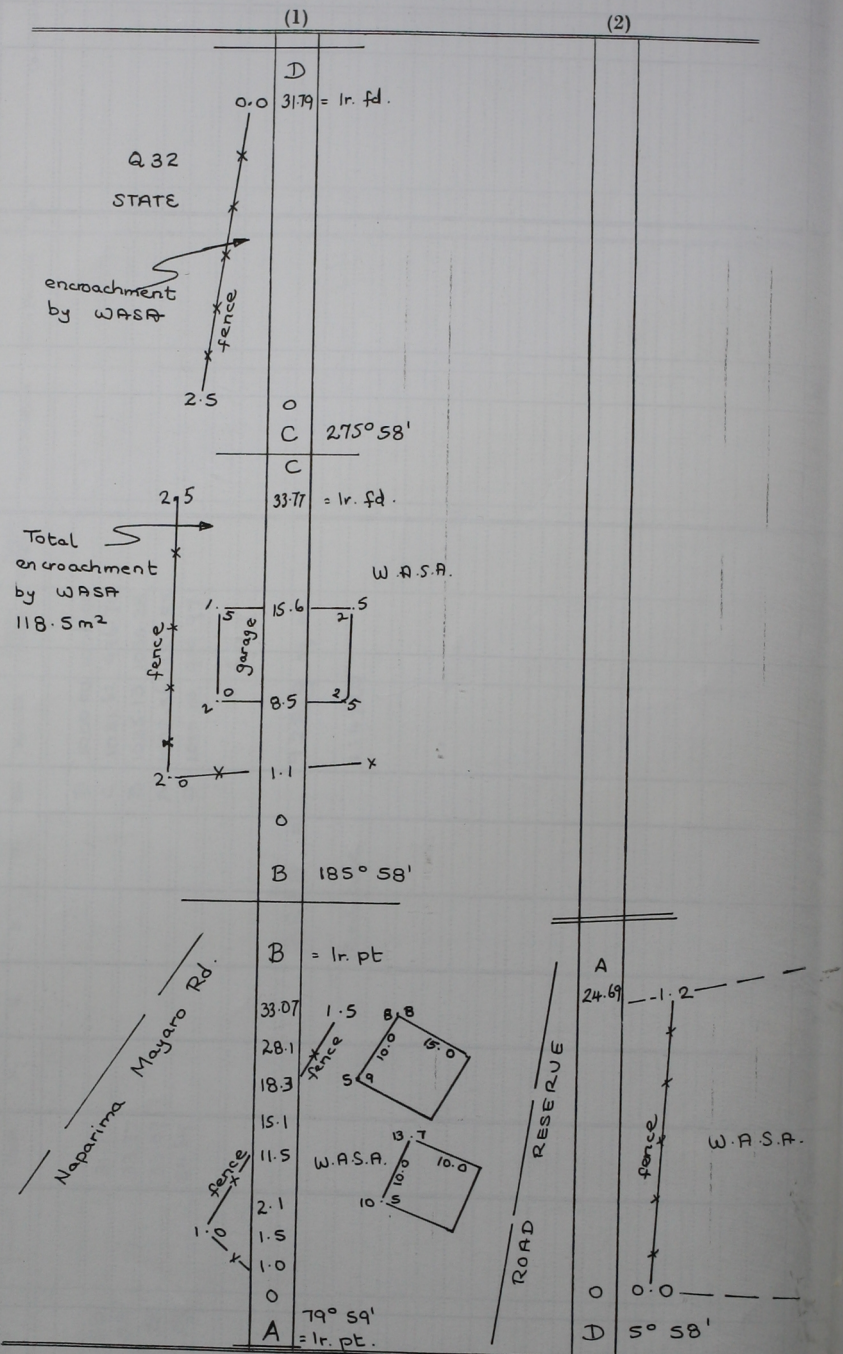

Ward of Charuma
 County of Nariva
 Cadastral Sheet H.2.C., $\frac{55B}{4/C}$
L.S.-2000.-36/05.-22/2
RIO CLARO
 Ref: Bk 922/100

Bearings are Cassini Grid based on
 Solar Observations
 Distances are in metres
 Surveyed in May 2000 for the
 Water & Sewerage Authority