

M.P.
L. & S. 216/103

Plans

SURVEY ORDER No.

117/2000

BK 1257 of 185

In the Ward of CHARUMA

SURVEY OFFICE,

JUNE 8th 192000.

To
MR RON GAJAMHAR T.T.L.
Land Surveyor

The application for the undermentioned parcel of Land having been approved, I request you to set out the Boundaries, by a Traverse Survey, and according to the Land Surveyors Rules, 1935.

Names of Petitioner and Residence	ACREAGE			Boundaries
	A.	R.	F.	
SURVEY OF WASA QUARTERS KNOWN AS RIO CLARO SITUATED AT NAPARIMA MAYARD ROAD.				N. S. E. W.

Road to be reserved to provide access to

Michael
f. As Director of Surveys

CERTIFICATES

I certify that I checked the steel tape used on the Standard
on the day of
and that I verified the compass used on the
day of on the Port-of-Spain Referring Mark.

Land Surveyor

I certify that I ran all the lines charged for myself and strictly observed
Rule 10 and that pillars and irons were placed by me on the survey.
Pillars were taken at

Ron Gajamhar
Land Surveyor



Sta.	Field	Declined	Chain	N.	S.	E.	W.	Sta.	Meridian	Perpen- dicular	Double Longitudes	North Products	South Products	Sta.	Co-ordinates
D	95° 58'		31.79				D		1000.00	1000.00					
C	05° 58'		33.71				C		1031.62	996.70					
B	259° 59'		53.07				B		1035.13	1030.28					
A	185° 50'		24.69				A		1002.56	1024.53					
							D		1000.00	999.91					
									AREA =	928.9	sq. m.				
									Miscellaneous:	1.4720					

Area = 928.9 sq. m.
Miscellaneous: 1.4720

Area = 928.9 m²

[Signature]
20/12/10

Survey Order No. 117/00

FIELD NOTES

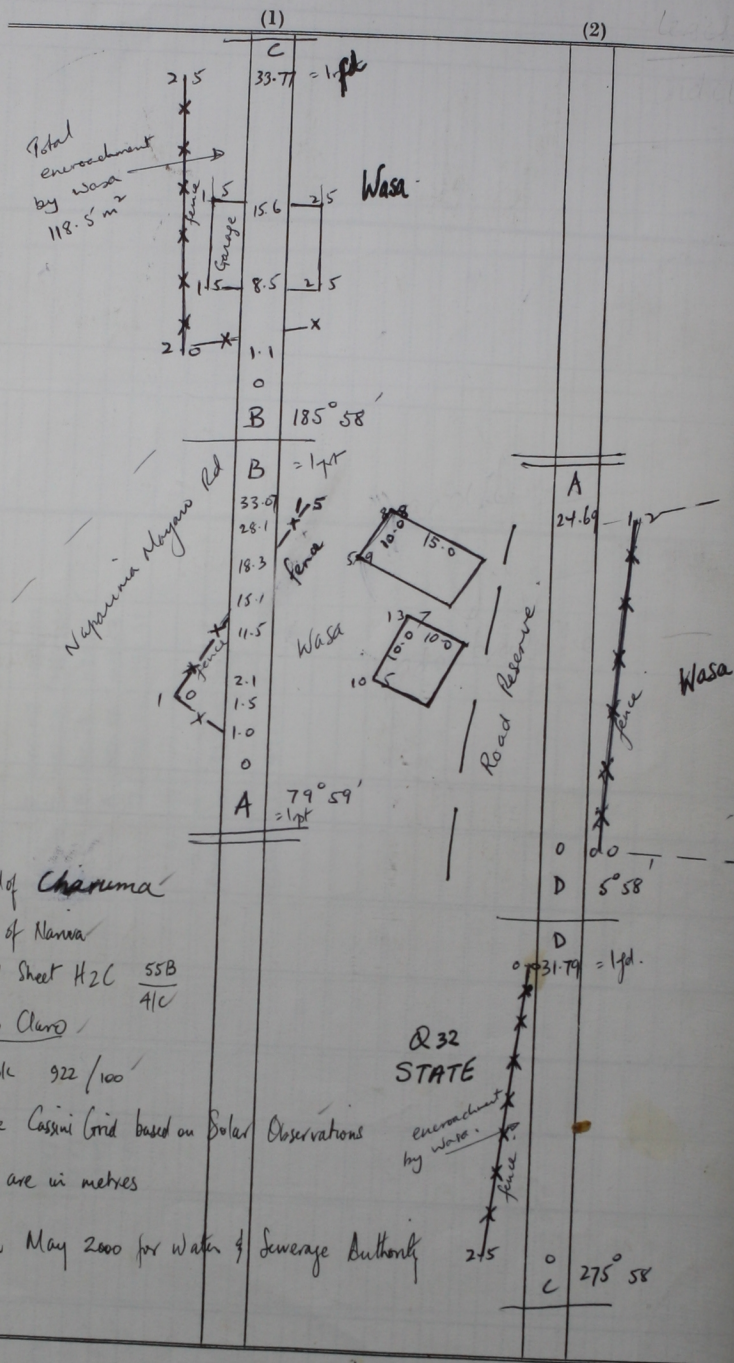

Ward of Charuma
 County of Namwa
 Cadastral Sheet H2C 55B
41C
Rio Claro
 Ref Book 922/100

Bearings are Cassini Grid based on Solar Observations
 Distances are in metres

Surveyed in May 2000 for Water & Sewerage Authority