

M.P.....

L. & S. 215/399

SURVEY ORDER No.

113/2000

BK 1069 78. 13

In the Ward of... LA BREA

SURVEY OFFICE,

NOVEMBER 9th 192001

To

MR. RON GAJADHAR T.T.S.
Land Surveyor

The application for the undermentioned parcel of Land having been approved, I request you to set out the Boundaries, by a Traverse Survey, and according to the Land Surveyors Rules, 1935.

Names of Petitioner and Residence	ACREAGE			Boundaries
	A.	B.	F.	
SURVEY OF A PARCEL OF LAND KNOWN AS POINT FORTIN #2 SITUATED AT HUBERTON CHAPO FOR WASA.				N. S. E. W.

Road to be reserved to provide access to

[Signature]
Director of Surveys

CERTIFICATES

I certify that I checked the steel tape used on theStandard on the..... day of..... and that I verified the compass used on the..... day of on the Port-of-Spain Referring Mark.

Land Surveyor

I certify that I ran all the lines charged for myself and strictly observed Rule 10 and that pillars and irons were placed by me on the survey. Pillars were taken at

[Signature]
Land Surveyor
RON E. GAJADHAR
T.T.S.
0080/01
OF TRINIDAD AND TOBAGO

FIELD NOTES

(1)		(2)	
		5.03	T3 31.00
	A 37.3	5.03	0 T2
State	State	5.03	65.98
		5.03	0 T1
	D 329° 52'	5.03	17.91
	D 16.01 = 1 pt	5.03	0 R3
State	State	5.03	74.65
		5.03	0 R1
	C 235° 03'	5.03	73.56
	C 37.3 = 1 pt	5.03	0 R2
State	State	5.03	26.97
		5.03	0 R3
R4	B 149° 51'	5.03	R3 44.32
	B 16.00 = 1 pt	5.03	0 R4
10.06	15.2	5.03	0 R4 30.09
Road Reserve	State	5.03	0 R5
10.06	3.0	5.03	0 R5
1 pt	A 55° 02'	5.03	5.03

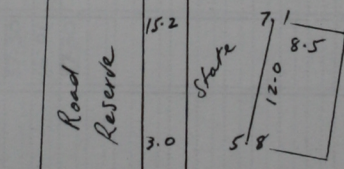

Bk 901/219
 W&H S.O. 52A/1952
 L.A.S. - 2000 - 36/95 - 22/2
 Surveyed in May 2000 for the Water and Sewerage Auth
 S.O. 113/2000
 Ward of La Brea
 County of St Patrick
 Cadastral Sheet $\frac{62E}{11C}$, F15F
 Bearings are Cassini true based on Solar.
 Distances are in m