

M.P.....

L. & S. 2.1.1.1850.

SURVEY ORDER No.

85/96

To Red House  
for checking  
of plans,  
96/10-11

In the Ward of Diego Martin

BK 1214 7th Aug 1996

SURVEY OFFICE,

7<sup>th</sup> August 1996.

To

Keith M. Scott

Land Surveyor

The application for the undermentioned parcel of Land having been approved, I request you to set out the Boundaries, by a Traverse Survey, and according to the Land Surveyors Rules, 1935.

Names of Petitioner and Residence	ACREAGE			Boundaries
	A.	R.	P.	
Survey of lot # 5 St Lucian Rd., Diego Martin for a lease to Rosemin David Ramnarine & Sunil Ramnarine	498	m <sup>2</sup>	(approx)	N. S. E. W.

Road to be reserved to provide access to

Michael Jones  
Director of Surveys  
7/8/96

CERTIFICATES

I certify that I checked the steel tape used on the .....Standard on the..... day of..... and that I verified the compass used on the..... day of ..... on the Port-of-Spain Referring Mark.

Land Surveyor

I certify that I ran all the lines charged for myself and strictly observed Rule 10 and that ..... pillars and ..... irons were placed by me on the survey.

Pillars were taken at

Land Surveyor



Total Chainage = 138.34 metres  
 ckd. Anthony Weber

Survey Order No. 85196

FIELD NOTES

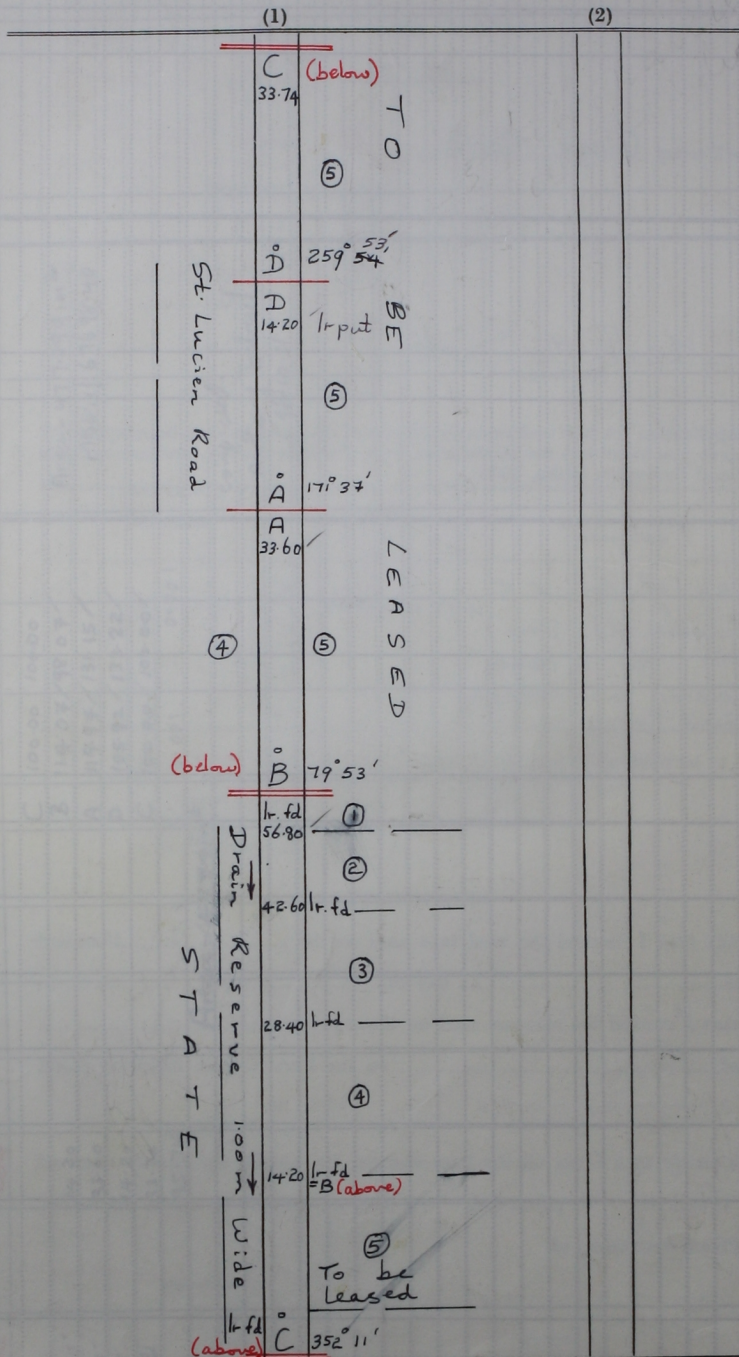

Bearings are Cassini based on Solar  
 Compass = -5'

Surveyed in August 1996 to be leased  
 to Rodolphe David Ramoine & Sunil Ramoine Ward - Diego Martin  
 Country - St. George

L.S. 21.11250 BK1151 F22  
 Vide S.O. No. 3/87  
 Sheet - 19A A14H  
 3/2  
 Distances = metres.