

M.P.....

L. & S. 2/1/22 Sub 726

To Mr. Jones or Mrs. Conville
for checking of
plans
Red House
96-1002

SURVEY ORDER No.

74/96

BK 1214 fol 183

In the Ward of Tacarigua.....

SURVEY OFFICE,

8th July.....1996

To

Mr Keith Scott
Land Surveyor

The application for the undermentioned parcel of Land having been approved, I request you to set out the Boundaries, by a Traverse Survey, and according to the Land Surveyors Rules, 1935.

Names of Petitioner and Residence	ACREAGE			Boundaries
	A.	R.	P.	
<i>Survey of lot no 3, corner of Sellier Street and River side Road Curape for a lease to Francis Bernard</i>				N. S. E. W.

Road to be reserved to provide access to

Andrew Bowler
Director of Surveys
8/7/96

CERTIFICATES

I certify that I checked the steel tape used on theStandard on the..... day of..... and that I verified the compass used on the..... day of on the Port-of-Spain Referring Mark.

Land Surveyor

I certify that I ran all the lines charged for myself and strictly observed Rule 10 and that pillars and irons were placed by me on the survey.

Pillars were taken at

[Signature]
Land Surveyor
September 25th 1996.

Total Chainage = 111.85 metres
 ced. Anthony Gabriel
 96-10-02

Survey Order No. 74/96

FIELD NOTES

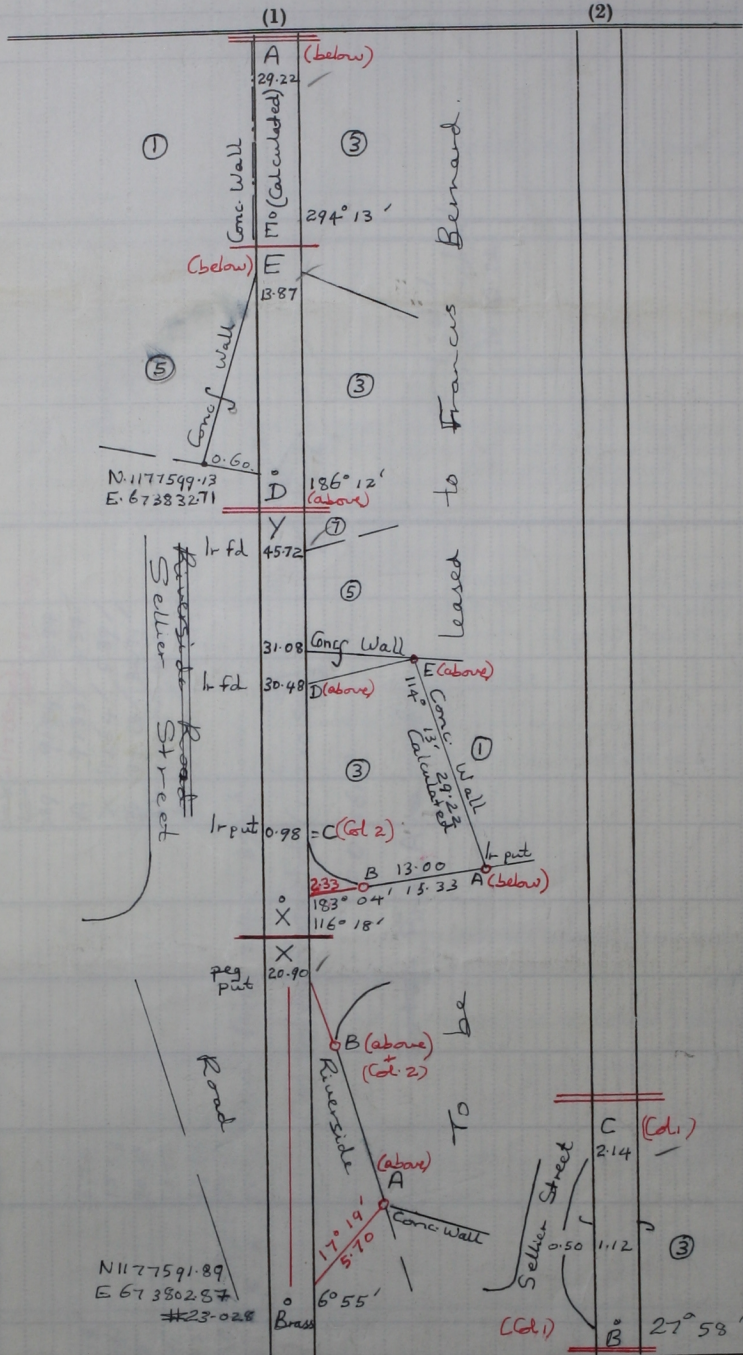

Bearings are based on horizontal control
 (W.M.) Brass #23-028 to Brass #23-029 = $35^{\circ} 24'$
 To obtain Cassini add 18 minutes
 Surveyed on 14th September 1996
 to be leased to Francis Bernard

Sheet 23C (B.18.I)
 21b
 Work Tacarigua
 Gundy - St. George
 Vide Plan L.B. 33
 Distances are in metres.