

M.P.

L. & S. 17/5/13

Please show computation of traverse for Mrs. Camille 96.07.31

SURVEY ORDER No.

61/96

Bk 1214 Pl. 171

In the Ward of La Brea

SURVEY OFFICE,

17th June 1996

To

Mr Paul Williams

Land Surveyor

The application for the undermentioned parcel of Land having been approved, I request you to set out the Boundaries, by a Traverse Survey, and according to the Land Surveyors Rules, 1935.

Names of Petitioner and Residence	ACREAGE			Boundaries
	A.	B.	P.	
<i>Survey of an area, to be used as an extension of a disposal site, for the Atlantic LNG CO. c/o Trinidad + Tobago</i>				N. S. E. - W.

Road to be reserved to provide access to

Andrew Bowden
Director of Surveys
17/6/96

CERTIFICATES

I certify that I checked the steel tape used on the Standard on the..... day of..... and that I verified the compass used on the..... day of on the Port-of-Spain Referring Mark.

Land Surveyor

I certify that I ran all the lines charged for myself and strictly observed Rule 10 and that — pillars and — irons were placed by me on the survey.

Pillars were taken at

Paul Williams
Land Surveyor

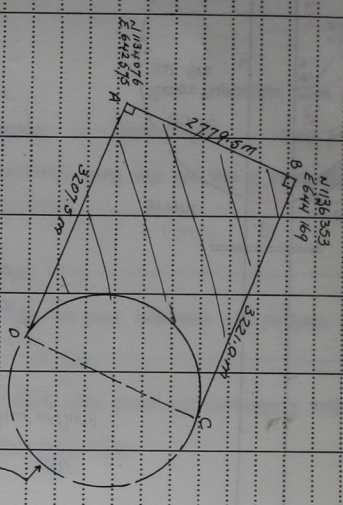

Radius = 0.75 radii (a mile)
 = 130.318
 Centripet = $\frac{N}{133388} \times 749076$

Area of Trapezoid ABCD = $\frac{1}{2} \times (\text{sum of parallel sides}) \times \text{distance between sides}$
 = $\frac{1}{2} \times (322.07 + 320.5) \times 272.07$
 = 893.4 ha.

Area of half of circle = $\frac{1}{2} \times \frac{\pi}{2} \times (130.318)^2$
 = 303.6 ha.

Area of shaded portion = $893.4 \text{ ha} - 303.6 \text{ ha}$
 = 589.8 ha.

FIELD NOTES

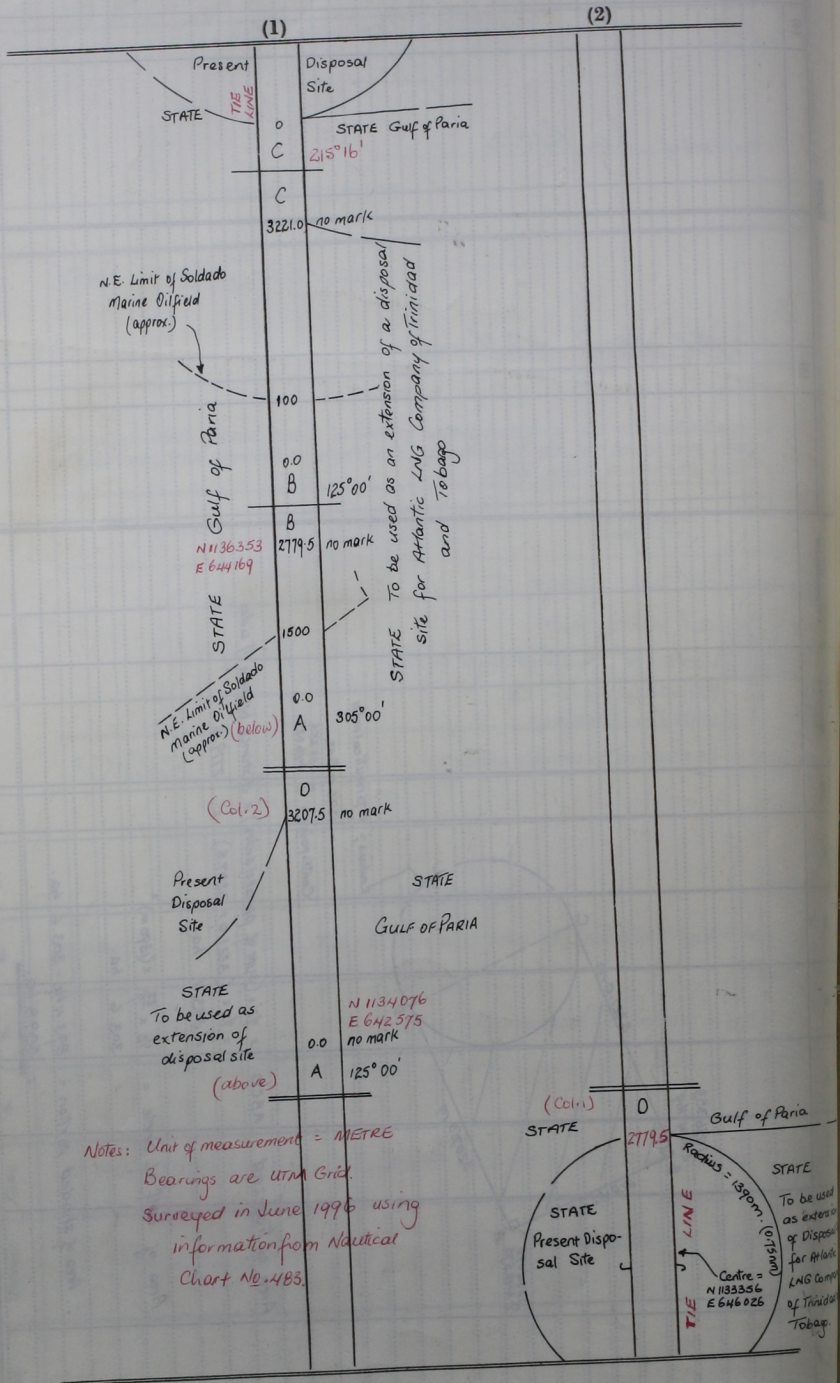

Notes: Unit of measurement = METRE
 Bearings are UTM Grid.
 Surveyed in June 1996 using
 information from Nautical
 Chart No. 483.