

M.P.....

L. & S. 116/3 Suts 12/45+48

SURVEY ORDER No.

56/46

To Mrs. Camille  
for checking of  
plans  
Red House  
16.09.03

In the Ward of Cocac

Bk 1314 Vol. 198

SURVEY OFFICE,

3rd JUNE 1916

To

Hakeeb Nandalal  
Land Surveyor

The application for the undermentioned parcel of Land having been approved, I request you to set out the Boundaries, by a Traverse Survey, and according to the Land Surveyors Rules, 1935.

Names of Petitioner and Residence	ACREAGE			Boundaries
	A.	R.	P.	
Surrey of lots 45+48 Crawford Estate Rio Claro for a standard Agricultural lease to Grinch Pitman.				N. S. E. - W.

Road to be reserved to provide access to

Andrew Bonin  
Director of Surveys  
3/6/1916

CERTIFICATES

I certify that I checked the steel tape used on the ..... Standard on the ..... day of ..... and that I verified the compass used on the ..... day of ..... on the Port-of-Spain Referring Mark.

Land Surveyor

I certify that I ran all the lines charged for myself and strictly observed Rule 10 and that - pillars and 10 irons were placed by me on the survey.

Pillars were taken at

Hakeeb Nandalal  
Land Surveyor



Total Chaining - 1064.58 metres  
 chd. Anthony Gabriel  
 96-09-03 Survey Order No. 56/96

FIELD NOTES

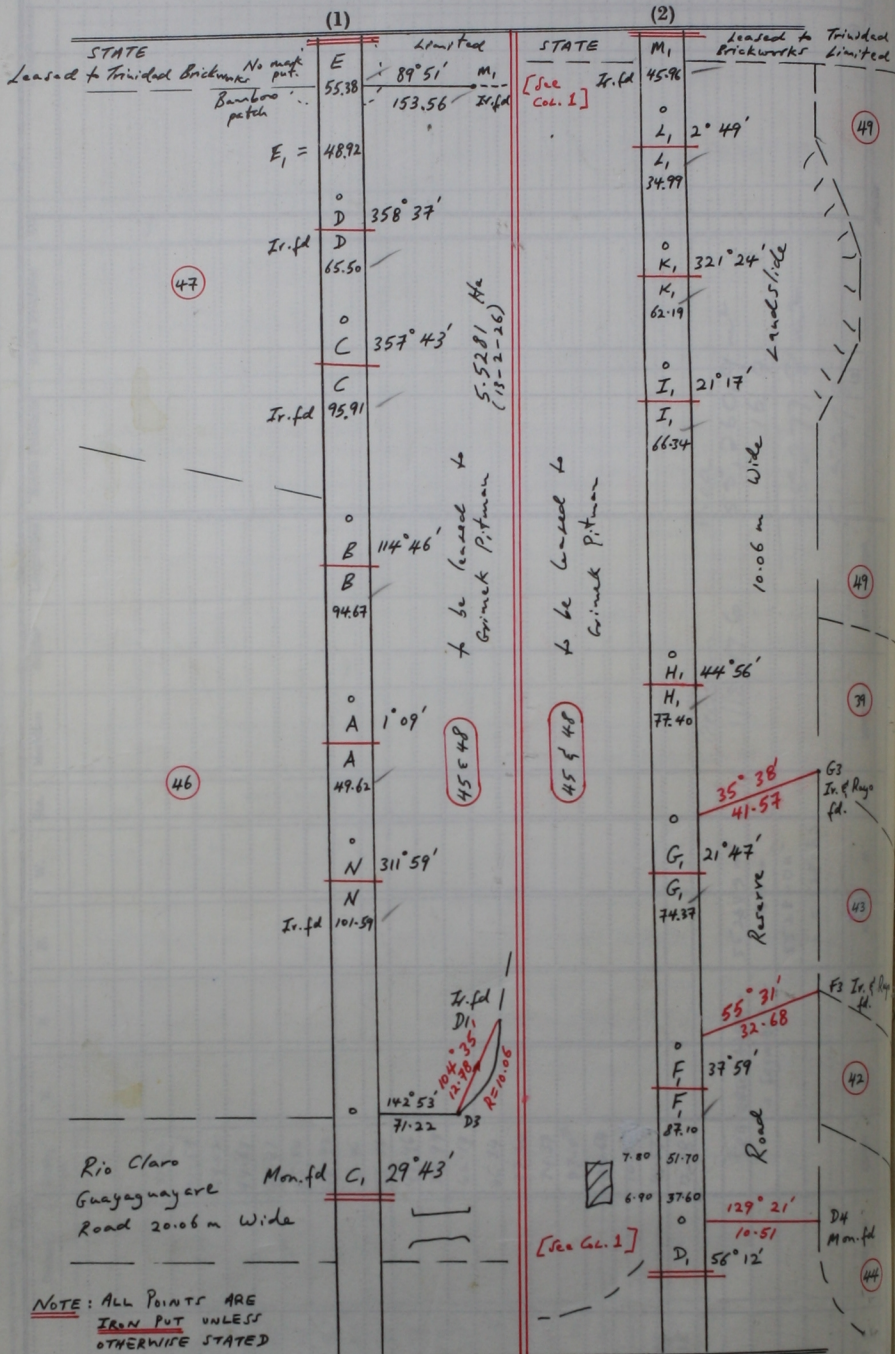

NOTE: ALL POINTS ARE IRON PUT UNLESS OTHERWISE STATED

Distances are in Metres,  
 Bearings are Cassini Grid based  
 on Solar obs.

Surveyed in April 1996  
 to be leased to Grimack Pitman

Cadastral sheet 55E 2/a/96  
 Words of Charman & Coal  
 County of Nariva

Vide P.A. 50