

4. Gabriel
L. & S. - 53

M.P.
L. & S. 2/3/8 Sub 29

SURVEY ORDER No.

44/96

To: Mrs. Camille
for checking plans
Red Hand
96-09-02

BK 1542 PP. 35

In the Ward of Manzanilla

SURVEY OFFICE,

7th May 1976.

To Keith Scott
Land Surveyor

The application for the undermentioned parcel of Land having been approved, I request you to set out the Boundaries, by a Traverse Survey, and according to the Land Surveyors Rules, 1935.

Names of Petitioner and Residence	ACREAGE			Boundaries
	A.	B.	P.	
<u>Surrey of Lot # 29 Sangre Grande Housing Scheme.</u>				N. S. E. W-

Road to be reserved to provide access to

Andrew Bowden
Director of Surveys
7/5/76

CERTIFICATES

I certify that I checked the steel tape used on theStandard on the..... day of..... and that I verified the compass used on the..... day of on the Port-of-Spain Referring Mark.

Land Surveyor

I certify that I ran all the lines charged for myself and strictly observed Rule 10 and that pillars and irons were placed by me on the survey.

Pillars were taken at

[Signature]
Land Surveyor
96/05/23

FIELD NOTES

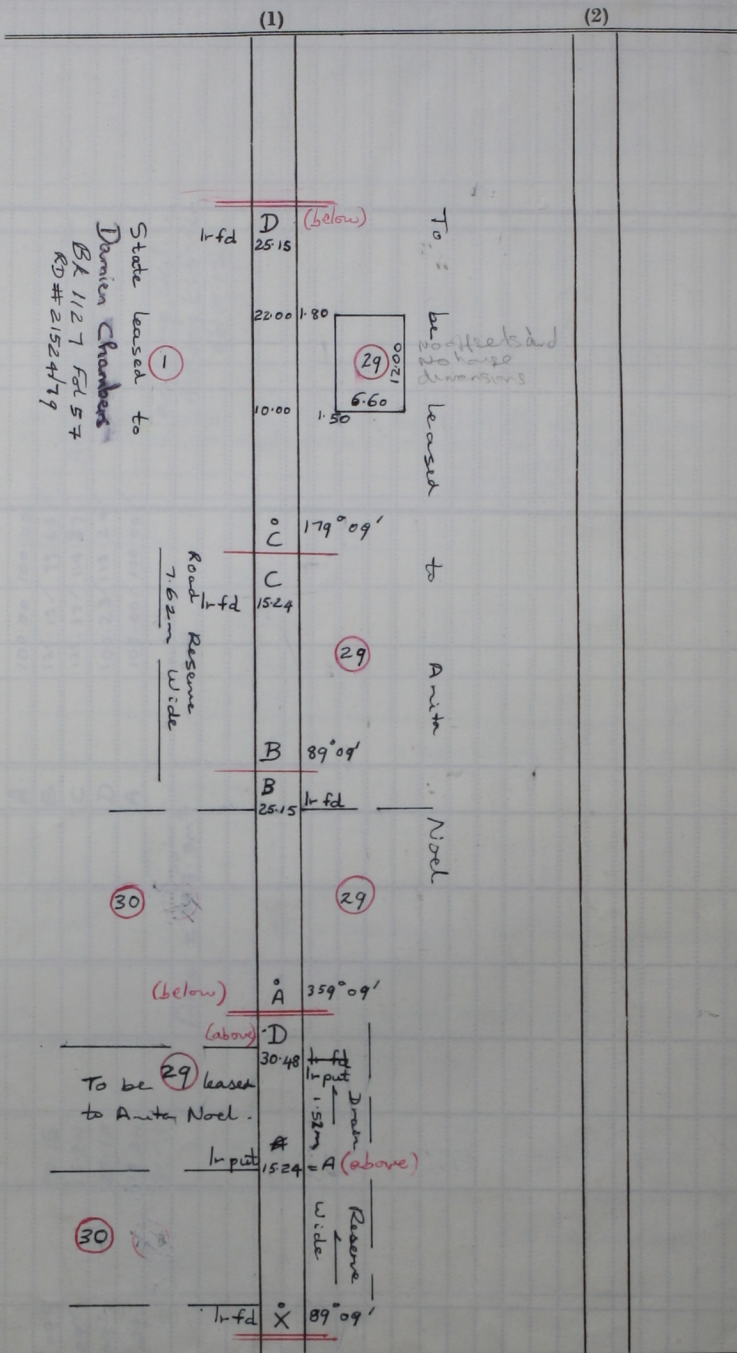

Bearings are Cassini based on Solar Observations Sheet 25F, C22
 Surveyed in May 1996 to Anita Noel
 Distances are in metres.
 Ward Marzaville
 County St. Andrew
 Vide Plan MA58