

M.P.

L. & S. 1/1/489

SURVEY ORDER No.

42/96

To Mrs. Camille
for the checking
7 plans
Red House
97.08.09

BK. 1242.175

In the Ward of Tacarigua

SURVEY OFFICE,

30th April 1996

To

Kelvin Romero

Land Surveyor

The application for the undermentioned parcel of Land having been approved, I request you to set out the Boundaries, by a Traverse Survey, and according to the Land Surveyors Rules, 1935.

Names of Petitioner and Residence	ACREAGE			Boundaries
	A.	B.	P.	
<u>Survey of Land at Seller Street, Curape to be leased to Victor Surajdeen</u>				N. S. E. W.-

Road to be reserved to provide access to

Andrew Bouch
Director of Surveys
30th April 1996

CERTIFICATES

I certify that I checked the steel tape used on theStandard on the..... day of..... and that I verified the compass used on the..... day of on the Port-of-Spain Referring Mark.

Land Surveyor

I certify that I ran all the lines charged for myself and strictly observed Rule 10 and that pillars and irons were placed by me on the survey.

Pillars were taken at

Kelvin Romero
Land Surveyor
1/7/97

Sta.	Height Bearing	Distance	Chain Sta	N. Northing	S. Sighting	Sta.	Meridian	Perpendicular	(3)	(4)
A	115° 25'	24.37	A	100.00	100.00		Area = 699.84 m		Sta. 112A River Bed Tr.	
B	181 29	32.22	B	89.54	122.01		MISC. 1 42423.3		Sta. 112B S.T.A.T.E. N. Mark 14	
C	299 49	13.80	C	57.33	121.00				Sta. 112C Leased to Germany	
D	294 29	11.00	D	68.75	99.19				Sta. 112D Victor	
	1 29	31.26	A	100.00	100.00		STATE		Sta. 112E Surreydon	
		112.65		+0.001	19223.4 m		Col. 2		Sta. 112F N. Mark 14 270° 53'	
				Area: 699.84 m			Camp site Anthony Gabriel		Sta. 112G MAIN RD.	
							97.18.04		Sta. 112H 30.34 R.P.H.	
									Sta. 112I Wire Fence	
									Sta. 112J Plan KA 57	
									Sta. 112K 54	
									Sta. 112L 1° 53'	
									Sta. 112M Cob 192 E2	
									Sta. 112N W2 N.M. PA	
									Sta. 112O 28.83 S.T.A.T.E.	
									Sta. 112P 16.5.55.1.70	
									Sta. 112Q V.L.G.R.	
									Sta. 112R Surrey 1.66.5	
									Sta. 112S 52	
									Sta. 112T 53	
									Sta. 112U Col 2 D. 11.00	

Total Claimage - 340.63 acres

chd. Anthony Cabral

97.08.04

Survey Order No. 42/96

Ward of Tacarigua
County of St. George
Cad. Sheet B17L

FIELD NOTES

23C
276

(1)		(2)	
Q ₂ 51.85 No mk. fd	39.2	h. Put 11.00	D 1° 29' 31.26 To be leased to Victor Surajdeo
STATE Leased to Victor Surajdeo	STATE	(53) Col. 1 High Wall No mk. fd	0 294° 29' No mk. fd.
STATE Leased to Victor Surajdeo	STATE	See Plan K.A. 54 (54) High Wall No mk. fd	0 299° 49' To be leased to Victor Surajdeo
Bk 1065 Fol. 218	0 298° 30'	High Wall Col. 1	0 299° 49' Bk 1065 Fol. 21
STATE Leased to Victor Surajdeo	Rustum & Kaliman	Ws 40° 51' 9.02 Col. 3 No mk. fd	L 45.05 (Ch. 3) St. Joseph River Bed Trace
STATE Leased to Victor Surajdeo	STATE Leased to Victor Surajdeo	Tie Line	0 173° 39' No mk. fd.
STATE Leased to Victor Surajdeo	Sellier St.	St. Joseph 51.37	H ₆ 50.15 No mk. fd.
STATE Leased to Victor Surajdeo	STATE Leased to Victor Surajdeo	STATE Leased to Victor Surajdeo	Sanatān Dharma Maha Sabha of T. & T.
STATE Leased to Victor Surajdeo	STATE Leased to Victor Surajdeo	STATE Leased to Victor Surajdeo	0 277° 59' No mk. fd.
STATE Leased to Victor Surajdeo	STATE Leased to Victor Surajdeo	STATE Leased to Victor Surajdeo	0 179° 27' No mk. fd.

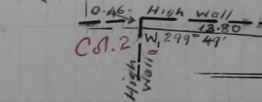
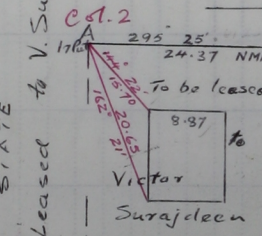
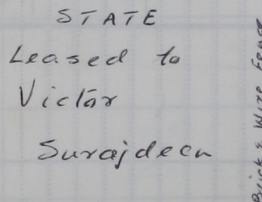
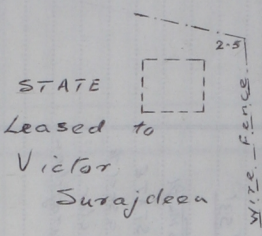

Bearings are Cassini Grid based on Solar Obs.
Distances are in metres
Date of Survey May 1997.