

1/2 A. Gabriel

L. & S. - 53

M.P.

L. & S. 1/1/13 Sub 1493 lot 14

SURVEY ORDER No.

32/96

To Mrs. Camille
for checking of
plans.
Red House
96.09.03

In the Ward of Valencia

Bk 1242 Vol. 197

SURVEY OFFICE,

28th March 1976

To

Hugo Somarçigh
Land Surveyor

The application for the undermentioned parcel of Land having been approved, I request you to set out the Boundaries, by a Traverse Survey, and according to the Land Surveyors Rules, 1935.

Names of Petitioner and Residence	ACREAGE			Boundaries
	A.	B.	F.	
Survey of lot 14 Farm School site Smith Lands Wallerfield to be leased to Tamouada Ali				N. Lot No. 17 S. lot No. 13 E. STATE W. Lot No. 12 & 15 and Land Res. @ 1/2 mile

Road to be reserved to provide access to

Andrew Bond
Director of Surveys
28th March 76

CERTIFICATES

I certify that I checked the steel tape used on the P.G.S. Standard on the 4th day of October 1975 and that I verified the compass used on the day of on the Port-of-Spain Referring Mark.

Hugo Somarçigh
Land Surveyor

I certify that I ran all the lines charged for myself and strictly observed Rule 10 and that 6 pillars and 6 irons were placed by me on the survey.

Pillars were taken at

Hugo Somarçigh
Land Surveyor

Total Chainage 514.88 metres
 Chd. Anthony Island
 96.09.03

Survey Order No. 32/96

FIELD NOTES

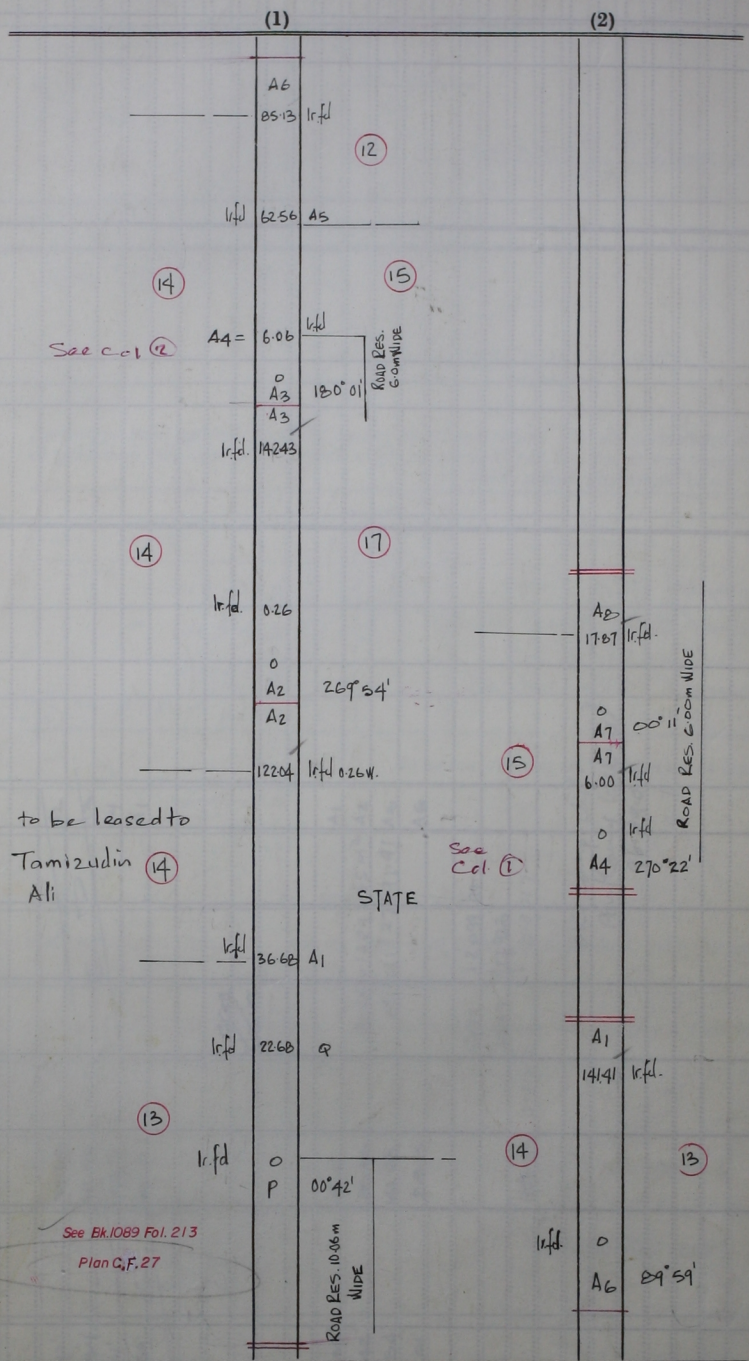

Bearings are Cassini Grid based on solar observations
 Distances are in metres
 Surveyed in October 1995 to be leased to Tamizudin Ali