

M.P. ....  
L. & S. 2/3/11 Sub 35

SURVEY ORDER No.

2/96

*Bk 1214 Fol 177*

In the Ward of MANZANILLA .....

SURVEY OFFICE,

2nd January ..... 1996.

To Mr. KEITH SCOTT .....  
Land Surveyor

The application for the undermentioned parcel of Land having been approved, I request you to set out the Boundaries, by a Traverse Survey, and according to the Land Surveyors Rules, 1935.

Names of Petitioner and Residence	ACREAGE			Boundaries
	A.	R.	F.	
<i>Redefinition Survey of Pt 35 situated at Opse Rd Sangre Grande showing all development including any encroachment - Renewal of lease - BERESFORD WHITE</i>				N. S. E. W.

Road to be reserved to provide access to Survey to be connected to national Framework.

*J. J. Long*  
Director of Surveys

CERTIFICATES

I certify that I checked the steel tape used on the ..... Standard on the ..... day of ..... and that I verified the compass used on the ..... day of ..... on the Port-of-Spain Referring Mark.

Land Surveyor

I certify that I ran all the lines charged for myself and strictly observed Rule 10 and that ..... pillars and ..... irons were placed by me on the survey. Pillars were taken at

*K. Scott*  
Land Surveyor  
5/2/96

Sta. From	Field Azimuth	Deduced	Chain Method	N.	S.	E.	W.	Sta. To	Meridian N	Perpen. direction E	Double Longitudes	North Products	South Products	Sta.	Co-ordinates
A	359° 09'		25.15					A	100.00	100.00					
B	89° 09'		15.24					B	125.15	99.63					
C	179° 09'		25.15					C	125.37	114.87		Area = 383.2860 m <sup>2</sup>			
D	269° 09'		15.24					D	100.23	115.24		15510.00			
			80.7800	0.00		0.00		A	100.00	100.00					
												Area = 383.3 m <sup>2</sup> OK			
												ok comp. ckd.			
												Area = 1 kesball			
												96.09.02			

Total chainage = 111,260.00 metres  
 chd. Anthony Ischert  
 9609102  
 Survey Order No. 2196

FIELD NOTES

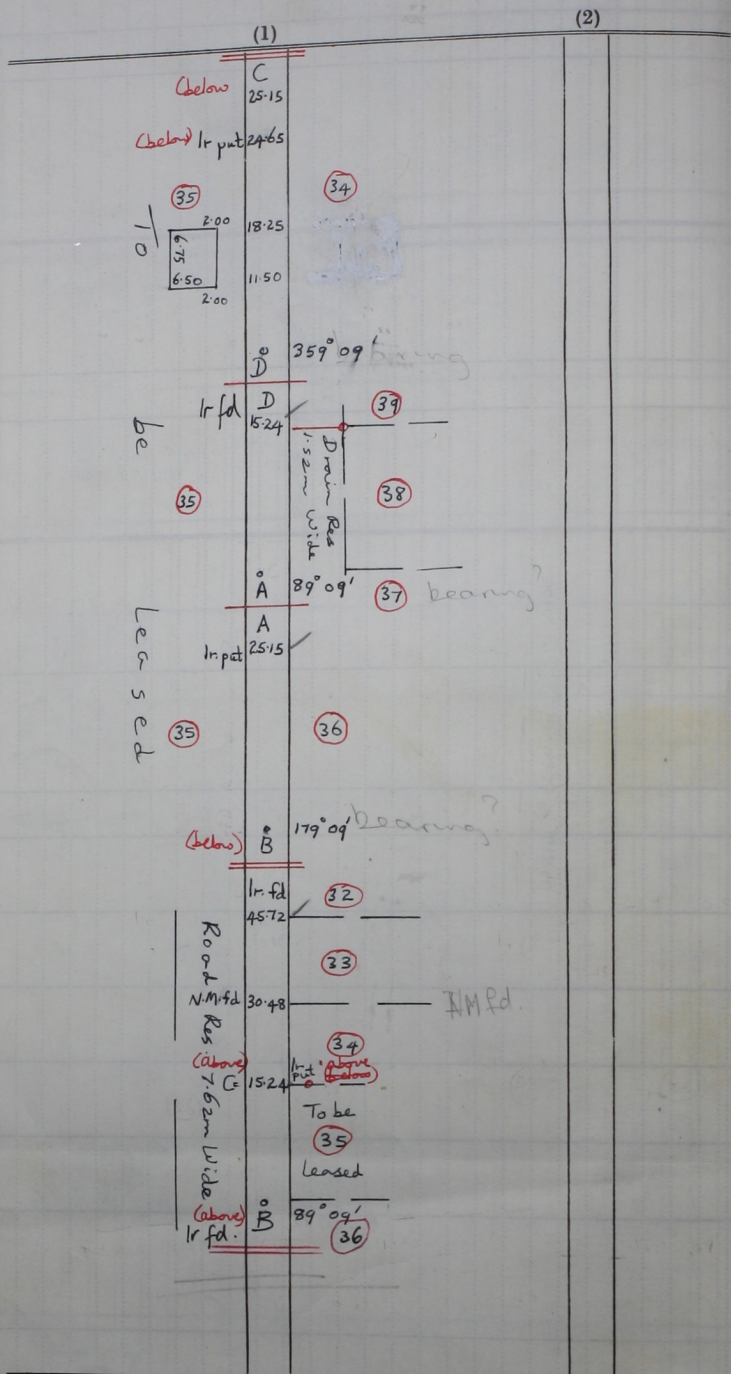

Bearings are Cassini based on Solar

Sheet 25F  
17b

Survey on December 1995 to be leased to Beresford White.

Ward Manzanilla  
 County St. Andrew  
 Vide Plan MA 58