

M.P. ....  
L.A. ....  
L. & S. 6/16/6

SURVEY ORDER No.

*Plan JB 217*

138/96 PLANE

In the Ward of *Guayaquayare, Mayor, Ortoire, Naparima*  
*Siparia + La Brea* SURVEY OFFICE,

*27<sup>th</sup> November* 1966

To  
*Mr S. Kalliecharan*  
Land Surveyor

The application for the undermentioned parcel of Land having been approved, I request you to set out the Boundaries, by a Traverse Survey, and according to the Land Surveyors Rules, 1935.

Names of Petitioner and Residence	ACREAGE			Boundaries
	A.	R.	P.	
<i>Survey to acquire lands for the laying of gas pipelines from Guayaquayare to Point Fortin.</i>				N. S. E. W.

Road to be reserved to provide access to

*Richard South*  
Director of Surveys  
*27/11/66*

CERTIFICATES

I certify that I checked the steel tape used on the ..... Standard on the ..... day of ..... and that I verified the compass used on the ..... day of ..... on the Port-of-Spain Referring Mark.

Land Surveyor

I certify that I ran all the lines charged for myself and strictly observed Rule 10 and that ..... pillars and ..... irons were placed by me on the survey.

Pillars were taken at

*S. Kalliecharan*  
Land Surveyor  
*4/3/67*

COUNTY OF VICTORIA  
 CADASTRAL SHEET G.15.P.

U.T.M. SHEETS  $\frac{64F}{3/d}$  &  $\frac{74C}{1/a \& 1/b}$

L. & S.—60

Land Regulations dated 2nd January, 1913.  
 Copy of Field Book

Ward of MORUGA

Survey Order No. 138/96

D NOTES

(1) PLAN E (2)

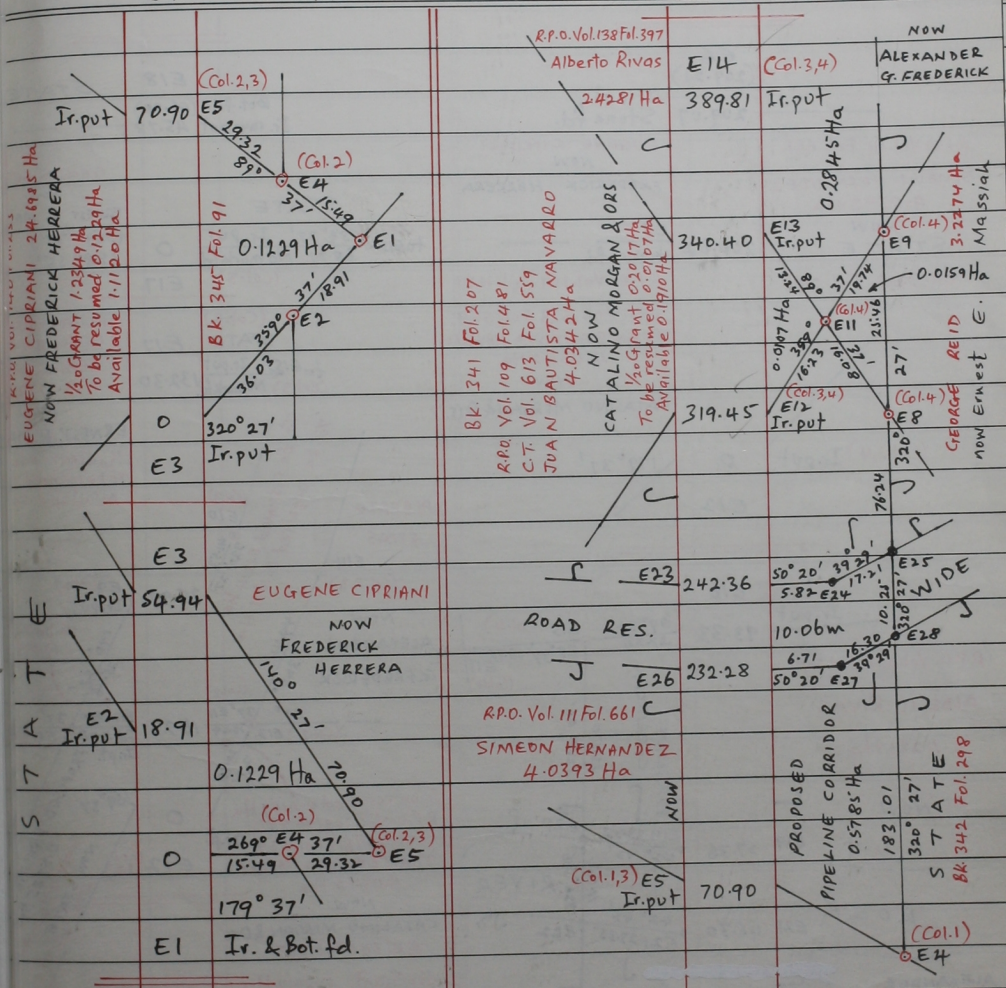

ALL DIMENSIONS ARE UTM GRID BASED ON SOLAR OBS.  
 CHECKED BY ME WITH DUE AUTHORITY IN DEC. 1996.  
 TO BE RESUMED AND ACQUIRED FOR THE PURPOSE  
 OF THE LAYING OF NATURAL GAS PIPELINES.

SCALE 1 : 2500  
 DIST. ARE IN METRES  
 ○ DENOTES IRON PUT EXCEPT  
 WHERE OTHERWISE STATED.

Shanmug  
 20/02/07  
 Jaitir

Checked  
 Krishna  
 18.06.97

