

M.P.....

L. & S. *LA-1/10/11, ph 3 pt 1*

SURVEY ORDER No.

102[#]/96

*To Mrs Camille
for the checking
of plans
Red House
97.12.17
98.02.12*

In the Ward of Diego Martin

BA 1243 77. 19

SURVEY OFFICE,

5th February 19 97

To

Camille Fortune
Land Surveyor

The application for the undermentioned parcel of Land having been approved, I request you to set out the Boundaries, by a Traverse Survey, and according to the Land Surveyors Rules, 1935.

Names of Petitioner and Residence	ACREAGE			Boundaries
	A.	B.	F.	
Redefinition of eastern boundary of the Diego Martin H/way in the vicinity of Mendez Drive (Lots 12, 13) to determine extent of encroachment on Lots 12, 13 Mendez Drive				N. S. E. W.

Road to be reserved to provide access to

Andrew Bond
Director of Surveys

CERTIFICATES

I certify that I checked the steel tape used on theStandard on the..... day of..... and that I verified the compass used on the..... day of on the Port-of-Spain Referring Mark.

Land Surveyor

I certify that I ran all the lines charged for myself and strictly observed Rule 10 and that pillars and irons were placed by me on the survey. Pillars were taken at

Camille Fortune
Land Surveyor

Total Claimage = 90.42 metres
 ced. Anthony Gabriel

Survey Order No. 102^A/96
 97.12.17

FIELD NOTES

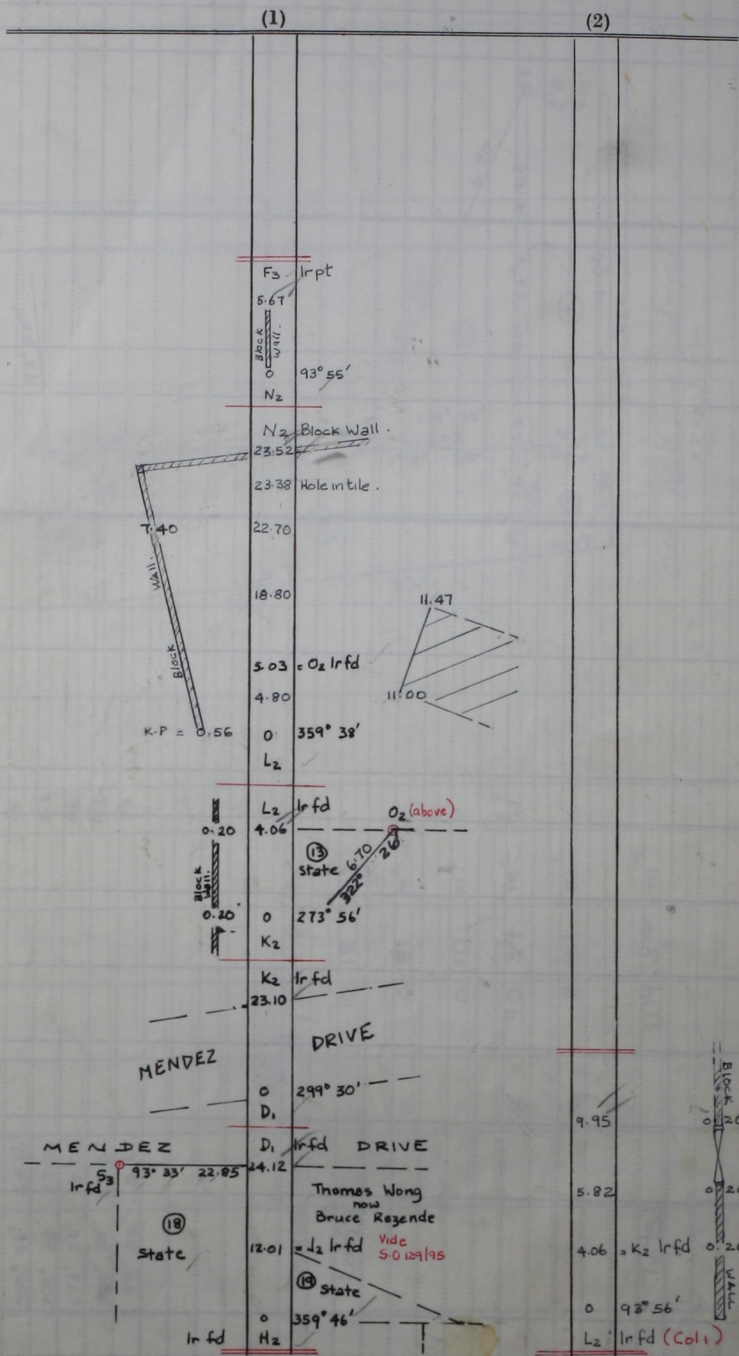

Distances are in metres
 Bearings are Cassini Grid, based on Solar Observations
 Surveyed by me, with due authority in October 1996 for the State
 Cadastral Sheet A 14L, 13A/31c.
 L.S.-2000.-36/165.-22/2 County of Sr. George
 Ward of Diego Martin