

REMAINING PORTION

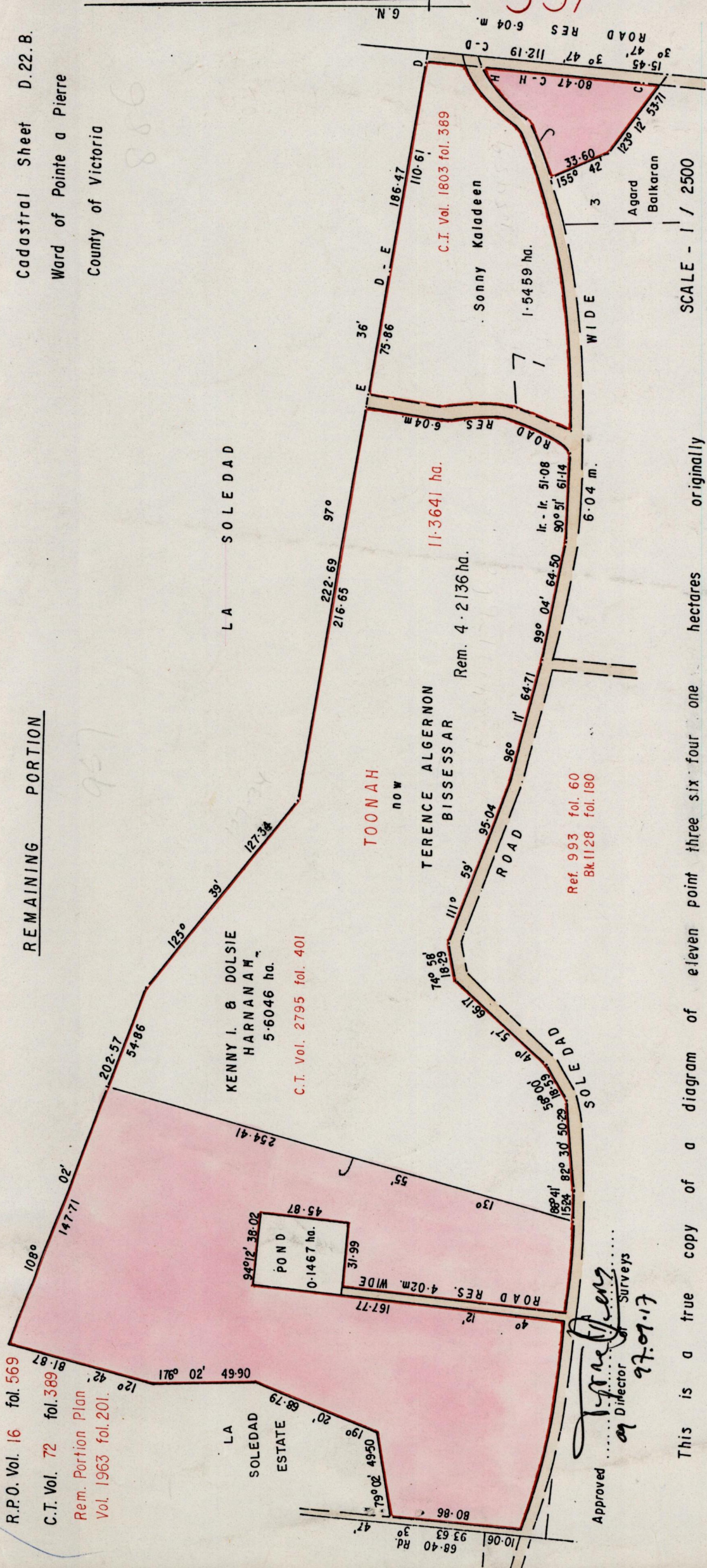

957

3336

SCALE - 1 / 2500
 Distances are in metres

This is a true copy of a diagram of eleven point three six four one hectares originally showing a portion coloured pink

granted to TOONAH

and containing four point two one three six hectares being the remainder after (2) two previous transfer

of another portion of the land. The dividing lines having been run in conformity with Rule 76 under

Sec. 7 (d) of Cap. 27. No. 2 and duly certified by the Director of Surveys.

Approved by *[Signature]* Director of Surveys
 27.07.17

Checked by AMZ. 17.9.9.
 Ent. on.

[Signature]
 Land Surveyor, Trinidad & Tobago
 14/4/97

Original Survey Bk. 993 fol. 60.

PLATE 214 - 1000 - 006