

No 27487

957

887

R.P.O. Vol. 16
C.T. Vol. 894

Fol. 143
Fol. 507

Ward of Siparia
County of St. Patrick
Cadastral Sheet G.12.F. $\frac{63.D.}{27d}$

GAJADHUR

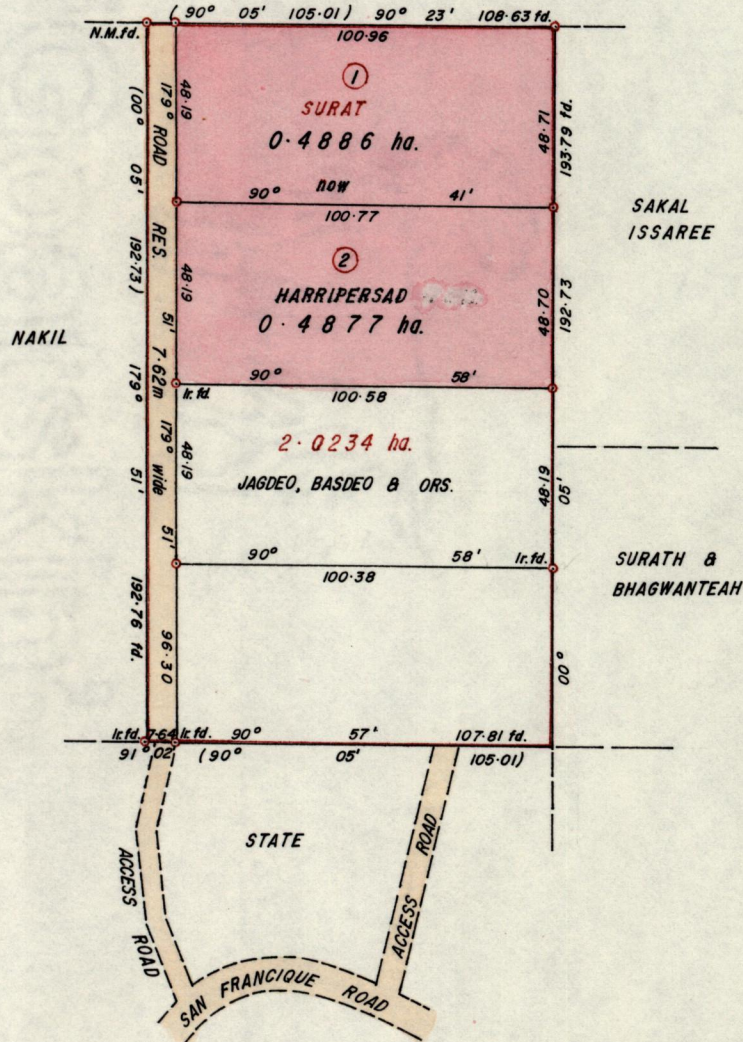

Approved *[Signature]*
Director of Surveys
97/9/96

o Denotes Iron put except otherwise stated.

Bearings are Cassini Grid, based on Solar Observation
Note: To obtain compass bearings add/subtract

SCALE 1:2000

minutes Distances are in metres

PLAN of 2 Parcels of land coloured pink in the Ward of Siparia
Containing together zero point nine seven six three hectares

Surveyed by me, with due authority, in September 19th. 1996

I certify that I have complied with rule 76 under section 14(2)(d) of the
Land Surveyors' Ordinance 1952, and that this plan is correct.

Checked by *[Signature]* 97-09-96

[Signature]
Land Surveyor, Trinidad and Tobago
5/2/97

Entered

Original Survey Bk. 710 fol. 226

1038

20

