

957

L. & S.—54 (36)

No 20793

Original in Bk 472 Fol. 43.

Thomas Jenvey

R.P.O. Vol.

C.T. Vol. 1365 Fol. 159

Ward of Siparia  
County of St. Patrick  
Cadastral Sheet G.12 G.

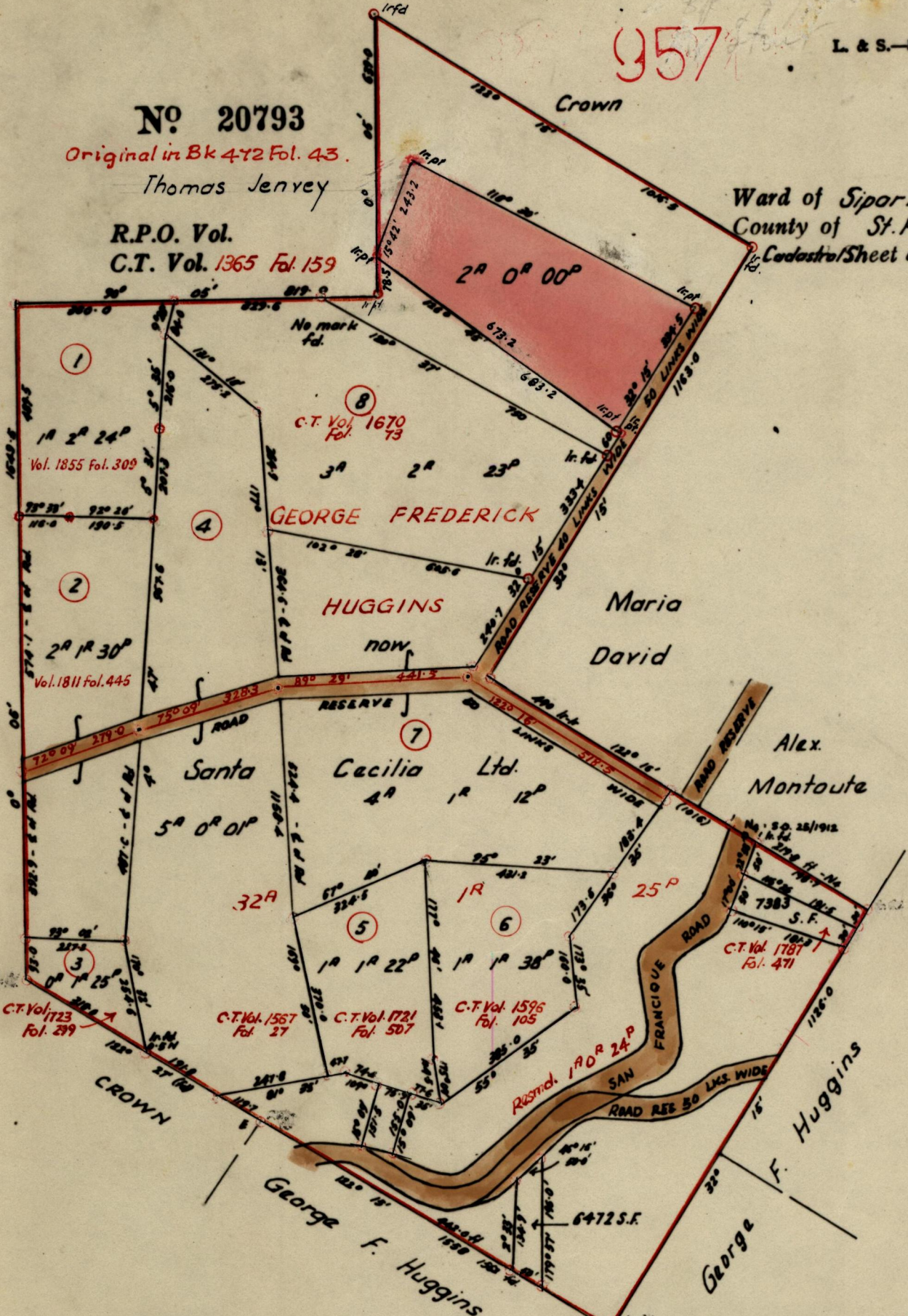

Approved

*John Samuel*  
 Director of Surveys  
 10. 8. 71

SCALE 1 : 2500

Note : To obtain compass bearings add/subtract 5 minutes Distances are in Links & feet

PLAN of a Parcel of land coloured pink in the Ward of Siparia  
 Containing Two acres

Surveyed by me, with due authority, in April 1967

I certify that I have complied with rule 76 under Section 14 (2) (d) of the Land Surveyors' Ordinance 1952, and that this plan is correct.

Checked by *L. J. W. 9/8/71*

Land Surveyor, Trinidad *1st July 1971*

G. P., Tr./To.—2201—10,000—10/65

LANDS AND SURVEYS VAULT RECORDS

Original in Bk 472 to 43