

Lot No.	C.T.Vol.	FOL.	AREA.
1	1600	111	0.1857ha.
2	1600	117	462.8m <sup>2</sup>
3	1600	123	928.2m <sup>2</sup>
4	1600	129	"
5	1600	137	"

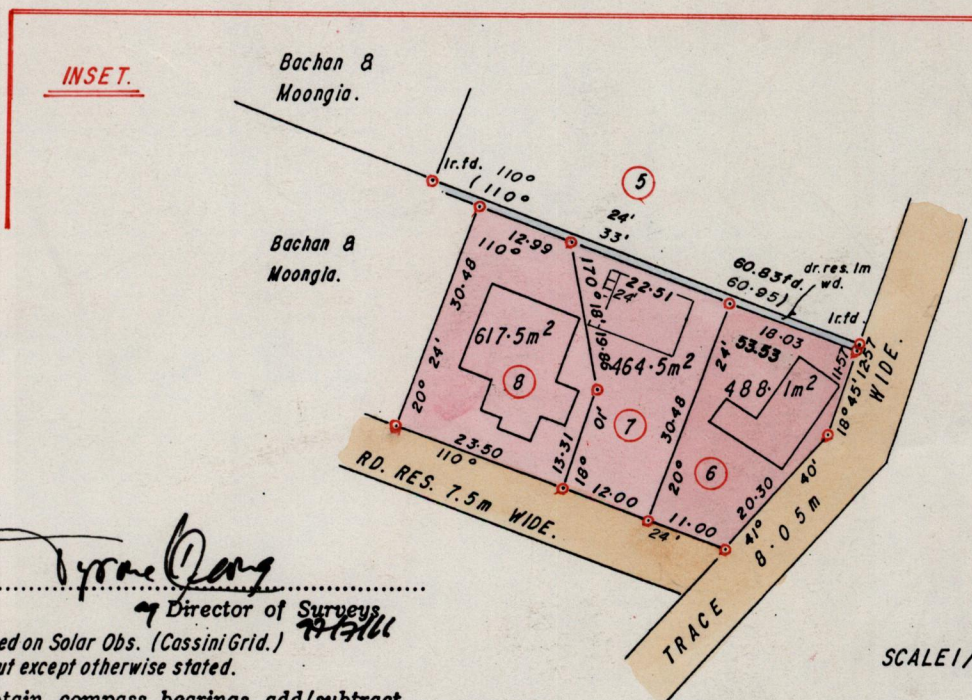

Approved *Tyrone O'Connell*  
 Director of Surveys

Bearings are based on Solar Obs. (Cassini Grid.)

• Denotes Iron put except otherwise stated.

Note: To obtain compass bearings add/subtract

PLAN of 3 Parcelsof land coloured pink in the Ward of Sipario.

Containing together zero point one five seven zero hectare.

Surveyed by me, with due authority, in July, 1994

I certify that I have complied with rule 76 under section 14(2)(d) of the Land Surveyors' Ordinance 1952, and that this plan is correct.

Checked by *Ross* 14/07/97

*A. Deenanar*  
 Land Surveyor, Trinidad 8<sup>th</sup> November 19.96

Orig. Survey Plan Bk 391 fol. 14.

852

852

