

No 10234

357

8319

R.P.O. Vol. 422  
C.T. Vol. 1633

Fol. 155  
Fol. 197

Ward of Naparima  
County of Victoria  
Cadastral Sheet G.14.B,  $\frac{64D}{17B}$

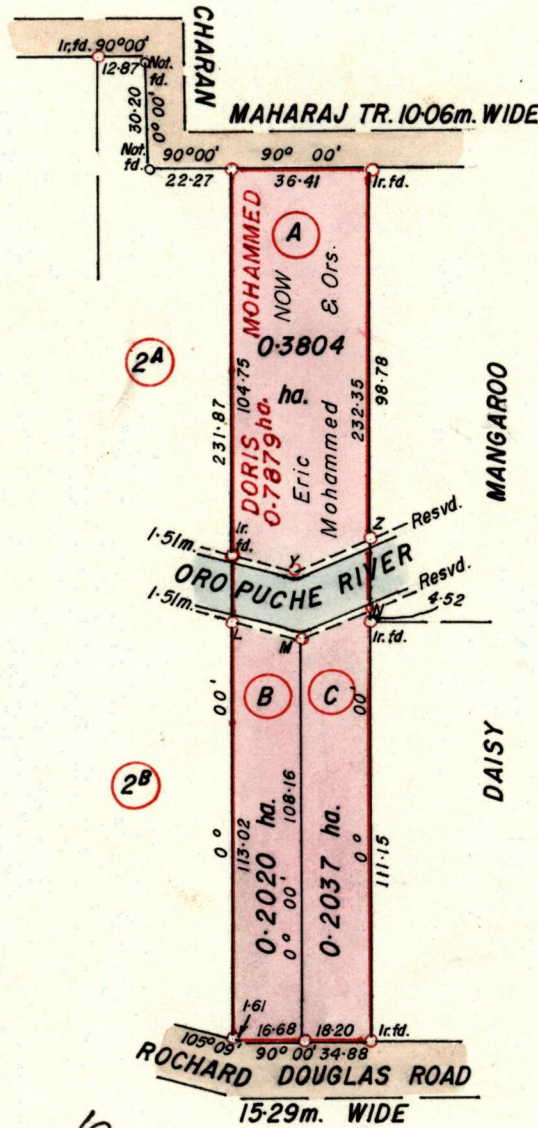

STA.	BEARINGS	DIST.
Ir. fd.-Y	101° 31'	14-99
Y-Z	67° 35'	23-50
Z-N	180° 00'	17-90
N-M	247° 35'	19-69
M-L	286° 09'	18-98
L-Ir. fd.	0° 00'	14-10

Approved

*[Signature]*  
Director of Surveys  
19/7/17

○ Denotes Iron put except stated otherwise

SCALE 1 : 2000

Note: To obtain compass bearings add/subtract ○ minutes Distances are in metres

PLAN of 3 Parcel of land coloured pink in the Ward of Naparima  
Containing together point seven eight six one hectares  
Surveyed by me, with due authority, in April 1996

I certify that I have complied with rule 76 under section 14(2)(d) of the  
Land Surveyors' Ordinance 1952, and that this plan is correct.

Checked by *[Signature]*

*[Signature]*

Entered .....

Land Surveyor, Trinidad 24<sup>th</sup> April 1996

83  
97/1/13

968

968

Original Survey Bk. 968 fol 96

