

No 22222

957

777

R.P.O. Vol. 18
C.T. Vol. 1179

Fol. 143
Fol. 43

Ward of Siparia.
County of St. Patrick. 63D
Cadastral Sheet 6.12.A.8 B 2/a

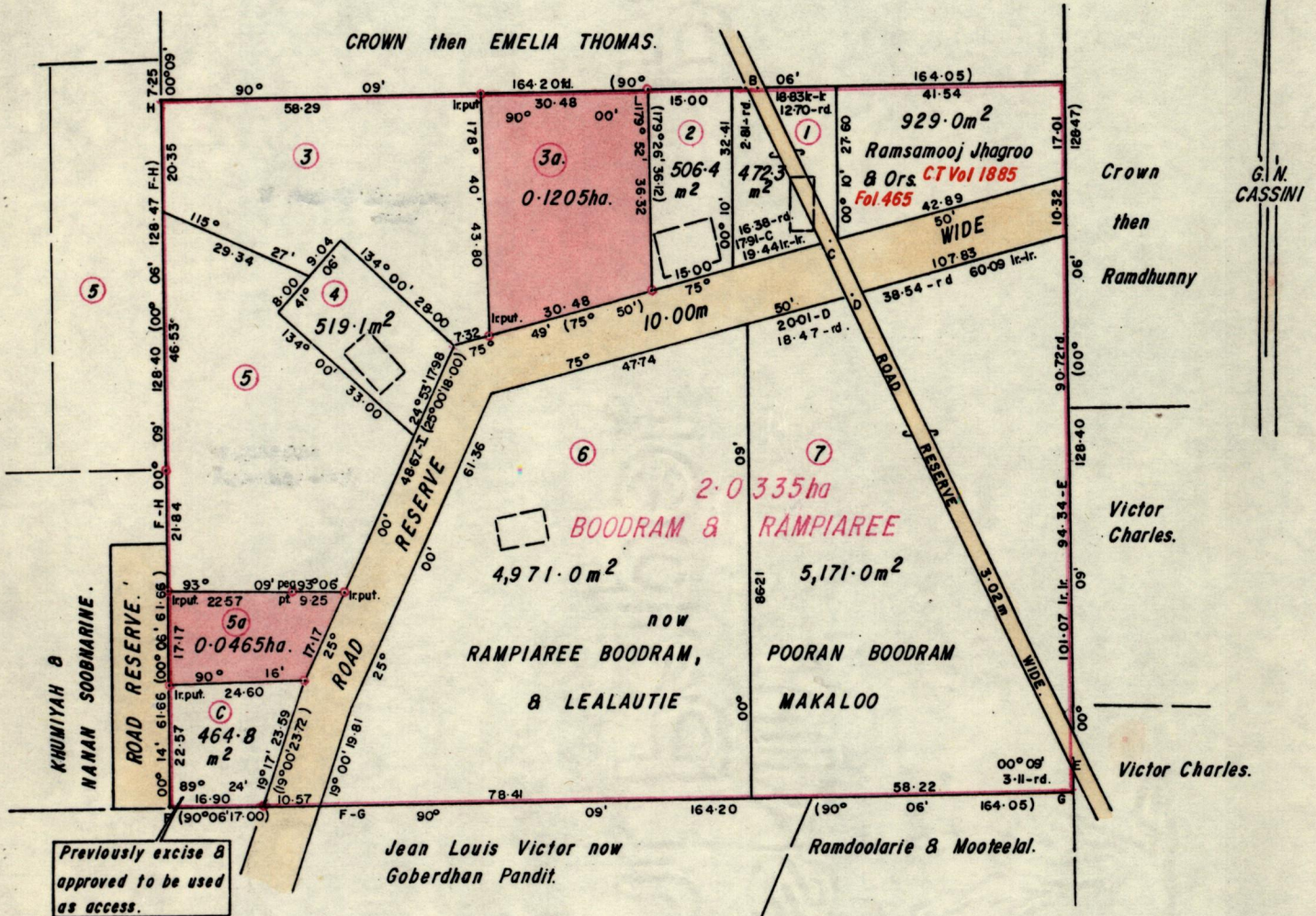

L - B = 90° 40' 17.82 (90° 06' 17.82)

Approved

Jean Charles

Director of Surveys
90.12.19

o Denotes Iron found.

SCALE 1/1250

minutes

Distances are in metres.

Bearings are based on Solar Observations (Cassini Grid)
Note: To obtain compass bearings add/subtract

PLAN of 2 Parcels of land coloured Pink in the Ward of Siparia.

Containing together zero point one six seven zero hectares.

Surveyed by me, with due authority, in March, 1990

I certify that I have complied with rule 76 under section 14(2)(d) of the Land Surveyors' Ordinance 1952, and that this plan is correct.

Checked by *J. Ramcharan* 27/12/90

Land Surveyor, Trinidad *Jankaran Mico* Dec. 15th 1990

Original Survey Bk 456 Pl. 158