

No 22442

957

775

R.P.O. Vol. 68
C.T. Vol. 1631

Fol. 257
Fol. 125

Ward of Naparima.
County of Victoria.
Cadastral Sheet G.13.B. 63F. 1/a

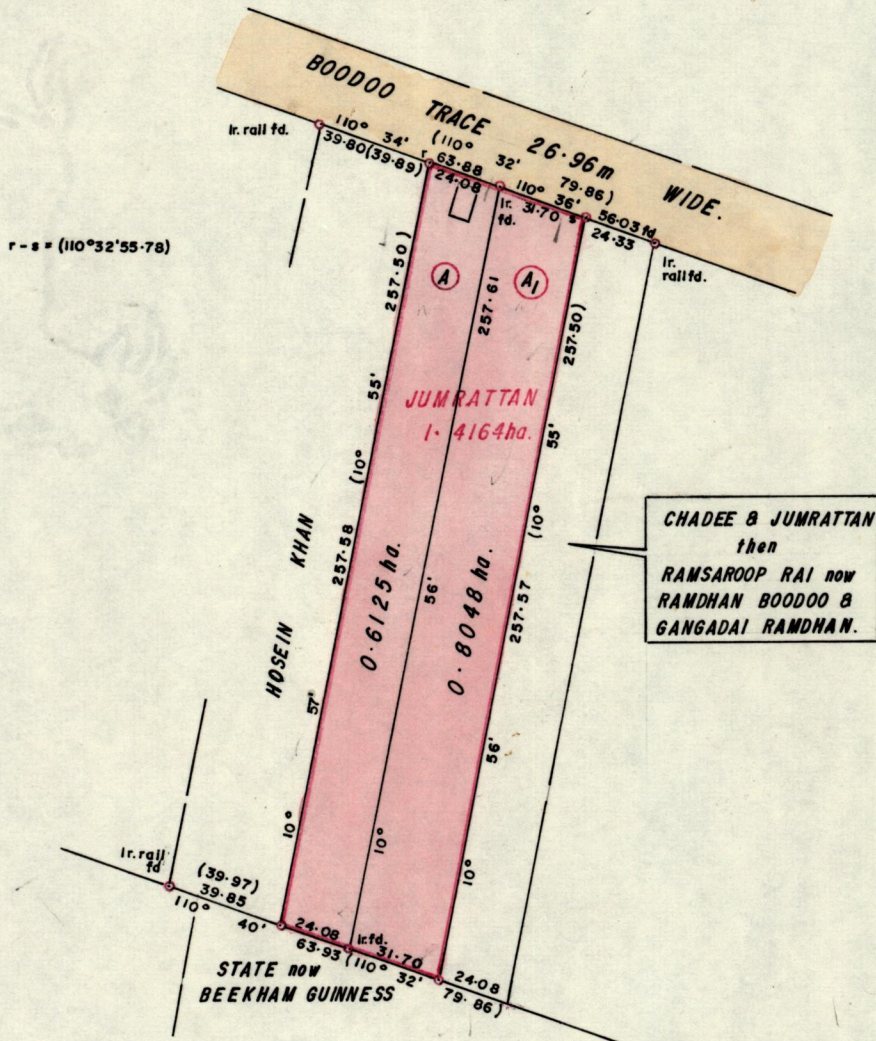

G. N. Cassini

Bk. 980 fol. 9
Bk. 997 fol. 121
Bk. 963 fol. 13

Approved *Land Charles*
Director of Surveys
90.12.19

• Denotes Iron put except otherwise stated.

Bearings are based on Solar Obs. (Cassini Grid.)
Note: To obtain compass bearings add/subtract

SCALE 1/2500
minutes

Distances are in metres.

PLAN of 2 Parcelsof land coloured Pink in the Ward of Naparima
Containing one point four one seven thee hectares. (together)

Surveyed by me, with due authority, in April, 1987

I certify that I have complied with rule 76 under section 14(2)(d) of the
Land Surveygrs' Ordinance 1952, and that this plan is correct.

Checked by *Shanchari*
19/12/90

Tarkaran Mico

Entered

Land Surveyor, Trinidad *Dec, 19th* 19.90

Original Survey Bk 968 Lot. 76