

957

772

No 9900

R.P.O. Vol. 188
C.T. Vol. 1225

Fol. 101
Fol. 427

Ward of Siparia.
County of St. Patrick. 63F.
Cadastral Sheet G.13.K. 37d

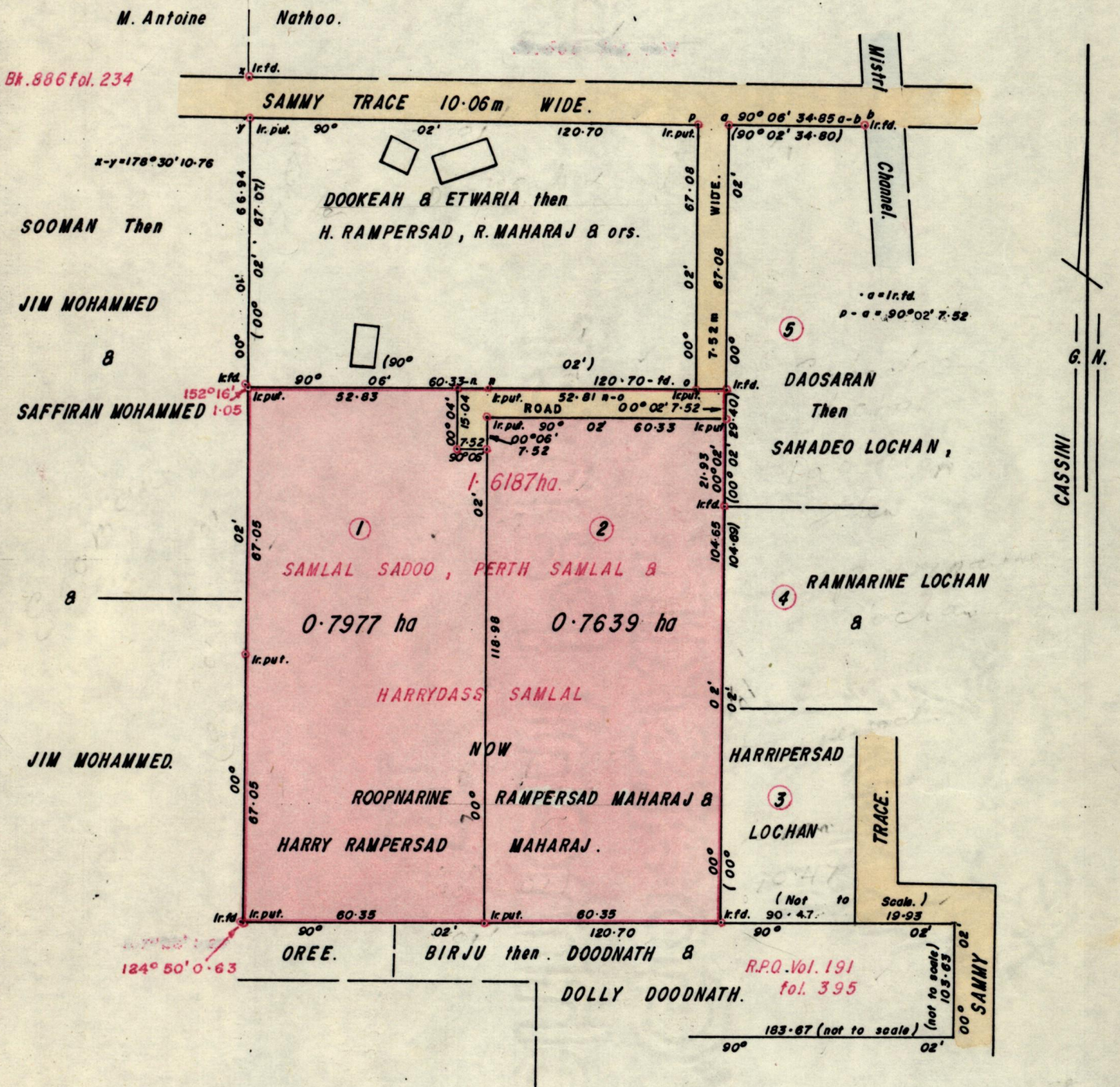

Approved *[Signature]*
Director of Surveys
90-13-20

Bearings are based on Solar Observations. (Cassini Grid.) SCALE 1:1500
Note: To obtain compass bearings add/subtract minutes Distances are in metres.

PLAN of 2 Parcel of land coloured Pink in the Ward of Siparia.
Containing together one point five six one six hectares.
Surveyed by me, with due authority, in May, 1989.

I certify that I have complied with rule 76 under section 14(2)(d) of the
Land Surveyors' Ordinance 1952, and that this plan is correct.

Checked by *[Signature]* 20/11/90 *[Signature]*
Entered Land Surveyor, Trinidad Dec 7th 1990

Original Survey BK 886 Lt. 234