

357

767

R.P.O. Vol 327
C.T. Vol. 1905.

Fol. 621
Fol. 157

Ward of Siparia.
County of St. Patrick.
Cadastral Sheet G.B.C. 86. ^{73C} 1/d

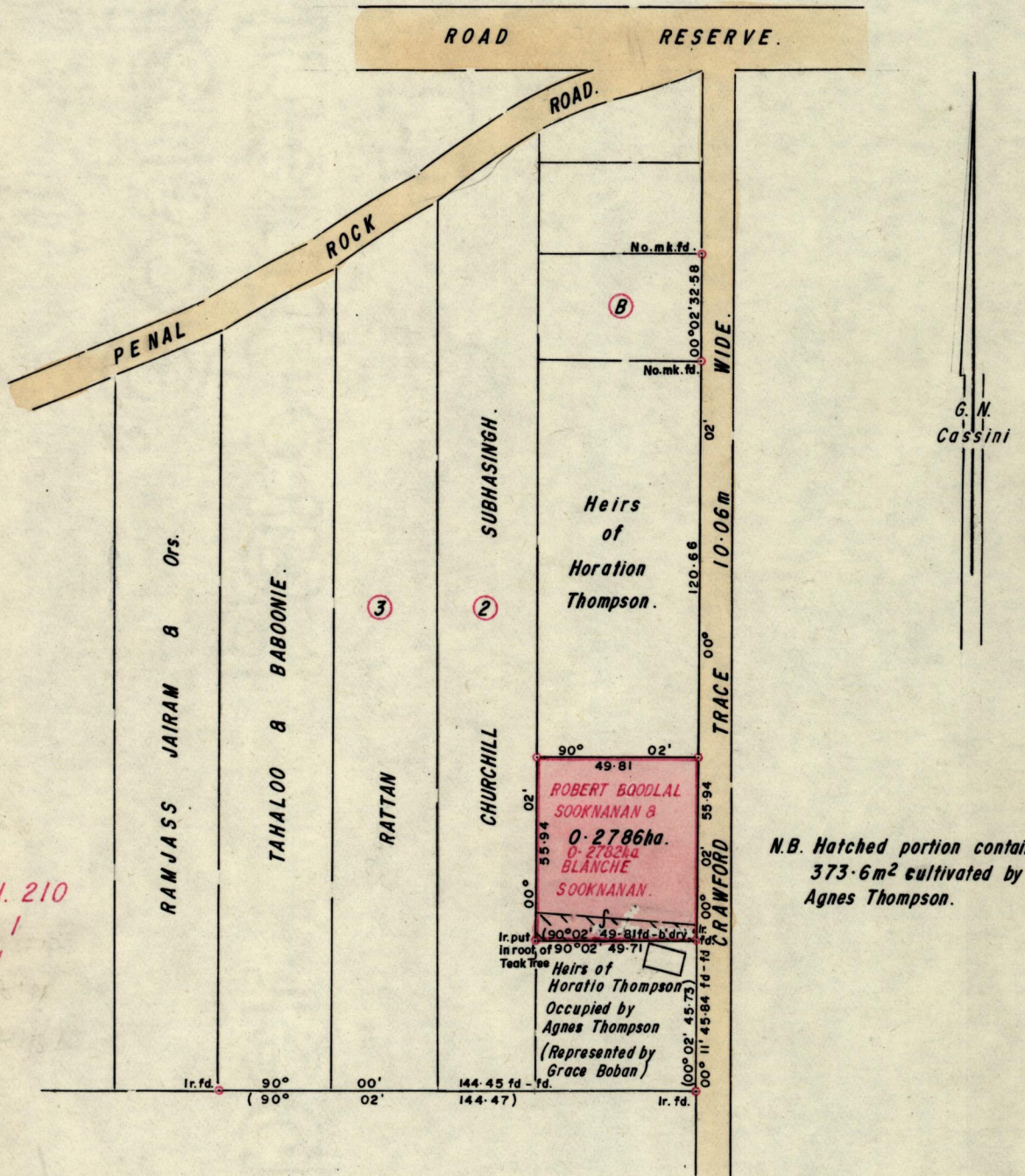

Bk. 1012 fol. 210
Bk. 903 fol. 1
Bk. 1163 fol. 131

N.B. Hatched portion containing 373.6m² cultivated by Agnes Thompson.

Approved

Y. S. Cole

Director of Surveys
20.12.11

• Denotes Iron put except otherwise stated.

Bearings are based on Solar Observations. (Cassini Grid.)

SCALE 1/2000.

Note: To obtain compass bearings add/subtract

minutes

Distances are in metres.

PLAN of a Parcel of land coloured Pink in the Ward of Siparia.

Containing zero point two seven eight six hectares.

Surveyed by me, with due authority, in November, 1990

I certify that I have complied with rule 76 under section 14(2)(d) of the Land Surveyors' Ordinance 1952, and that this plan is correct.

Checked by *G. K. Ancharba* 10/12/90

Jankaran Micoo
Land Surveyor, Trinidad Nov, 26th 1990

Entered

Original Survey Rk 1012 Pl. 210