

REMAINING PORTION

R.P.O. Vol. 168 Fol. 539

C. of T. Vol. 1719 Vol. 379

957

Cadastral Sheet G.12.D. <sup>63E</sup>/<sub>2/a</sub>

761

Ward of Siparia.

County of St. Patrick.

Remaining Portion Plan filed in

R.P.O Vol. 2108 fol. 75

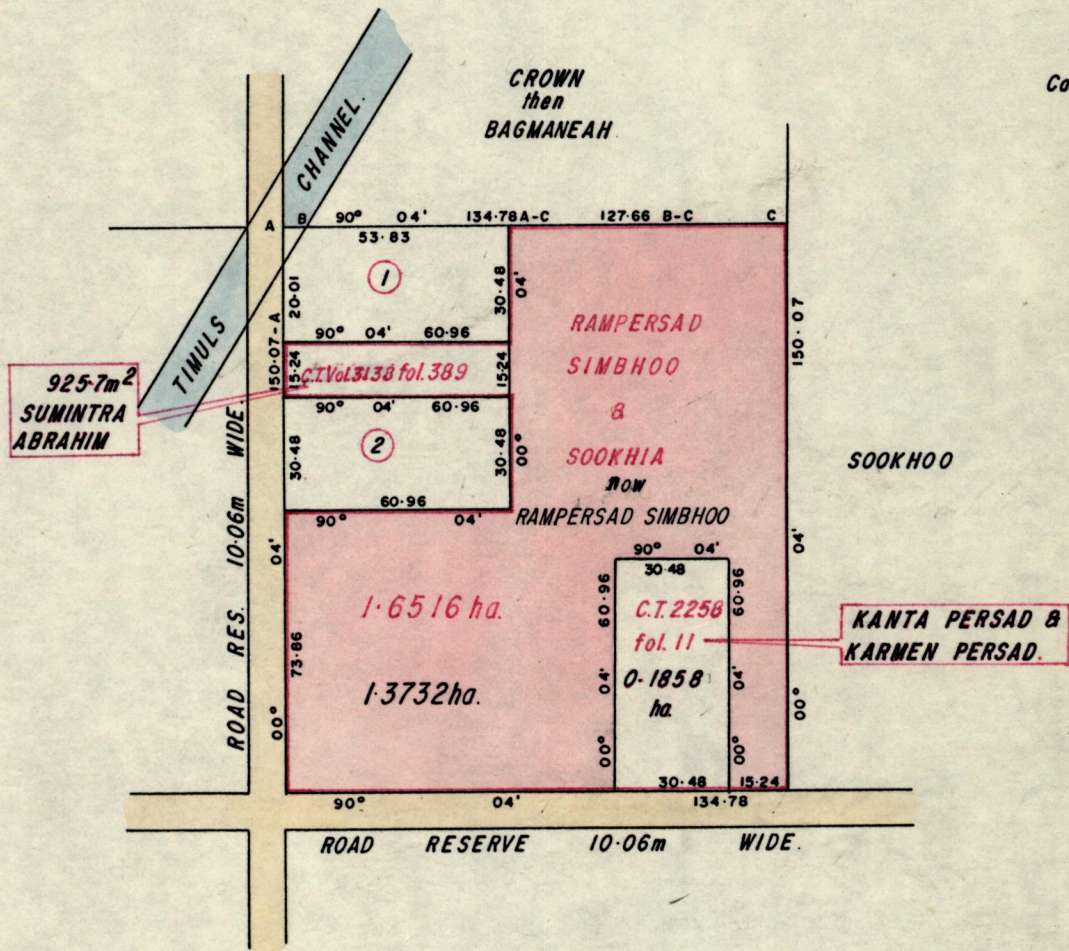

Approved

*[Signature]*  
Director of Surveys 90.12.12

SCALE 1:2000

Note: To obtain compass bearings ~~add~~ 4 minutes subtract

Distances are in metres.

This is a true copy of a diagram of one point six five one six hectares. originally granted to Rampersad Simbhoo & Sookhia. , shewing a portion coloured pink and containing one point three seven three two hectares. being the remainder after TWO previous transfer of another portion of the land. the dividing lines having been run in conformity with Rule 76 under Sec. 7(d) of Cap. 27. No. 2 unit duly certified by the Director of Surveys.

Checked by *[Signature]* 12/12/90

Entered on

*[Signature]*

Land Surveyor, Trinidad, Nov. 22<sup>nd</sup> 19.90. & Tobago.



Original Survey Bk 402 Pl. 75

708

1875  
1876

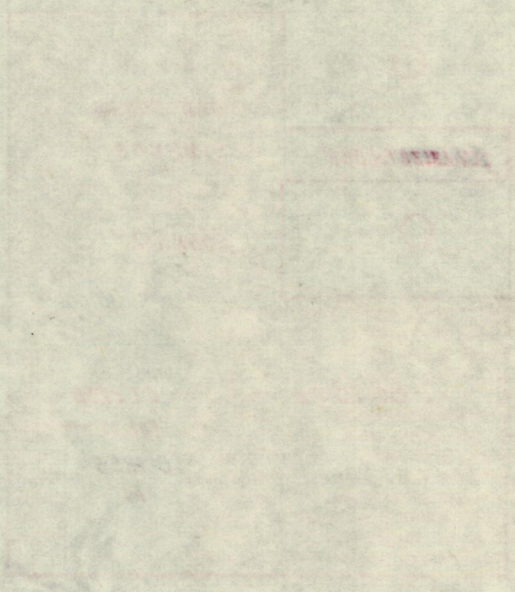

1875  
1876

1875  
1876

1875  
1876