

357

758

INSET

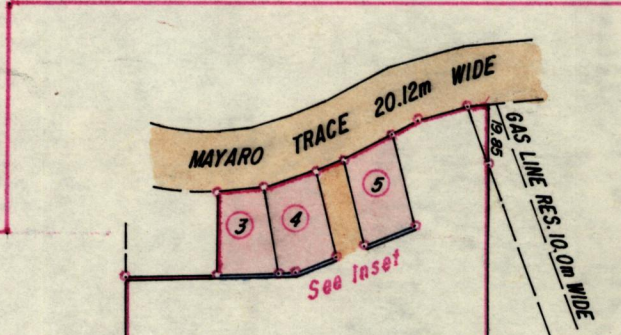
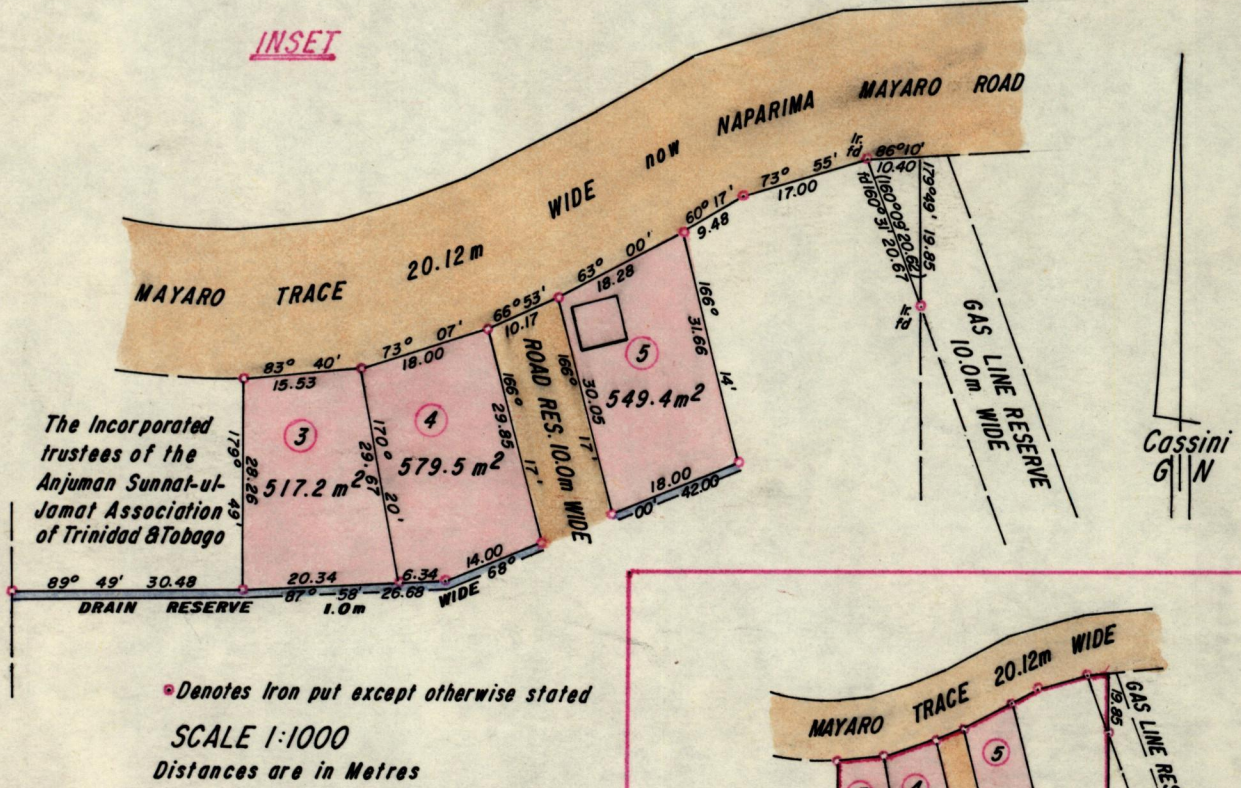

Approved *Lawrence Charles*  
Director of Surveys 90-11-28

Bearings are based on solar observations

PLAN of 3 Parcels of land coloured pink in the Ward of Charuma Containing together, one thousand six hundred and forty six point one square metres.

Surveyed by me with due authority in January 1990

I certify that I have complied with rule 76 under section 14(2) (d) of the Land Surveyors Ordinance 1952 and that this plan is correct

Checked by *G. Lanchester* 28/11/90

SCALE 1:2500

Entered . . . Land Surveyor, Trinidad & Tobago 22<sup>nd</sup> August 1990

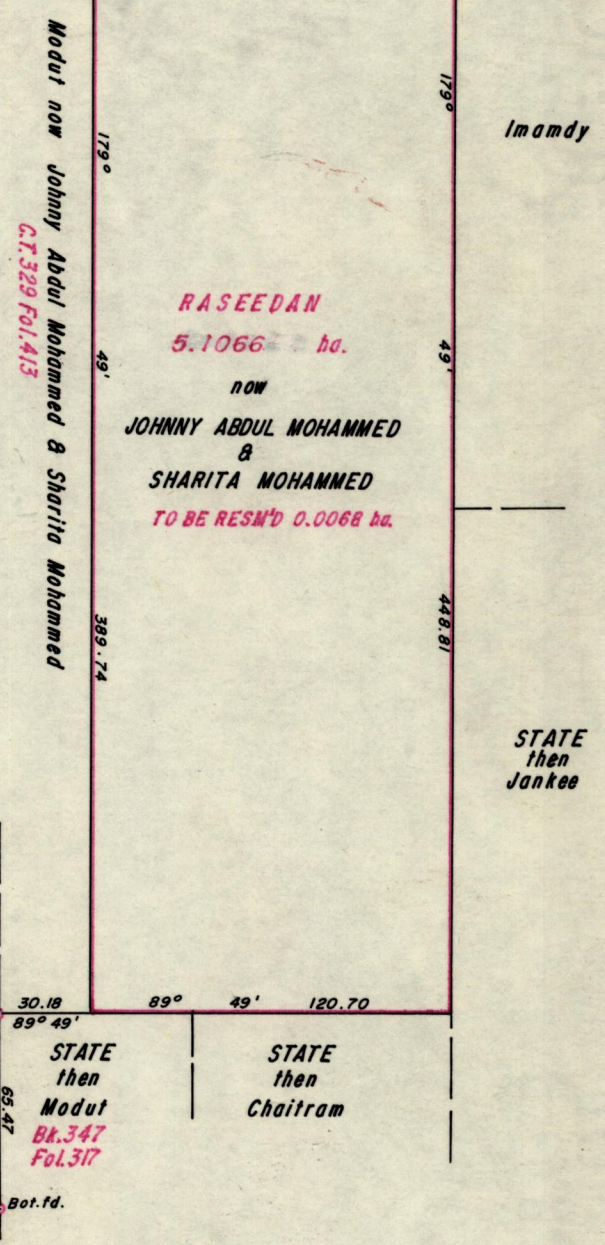

Bk. 1103 Fol. 147

STATE then Bissundayah

STATE then Modut Bk. 347 Fol. 317

STATE then Chaitram

TRACE

507

508

509

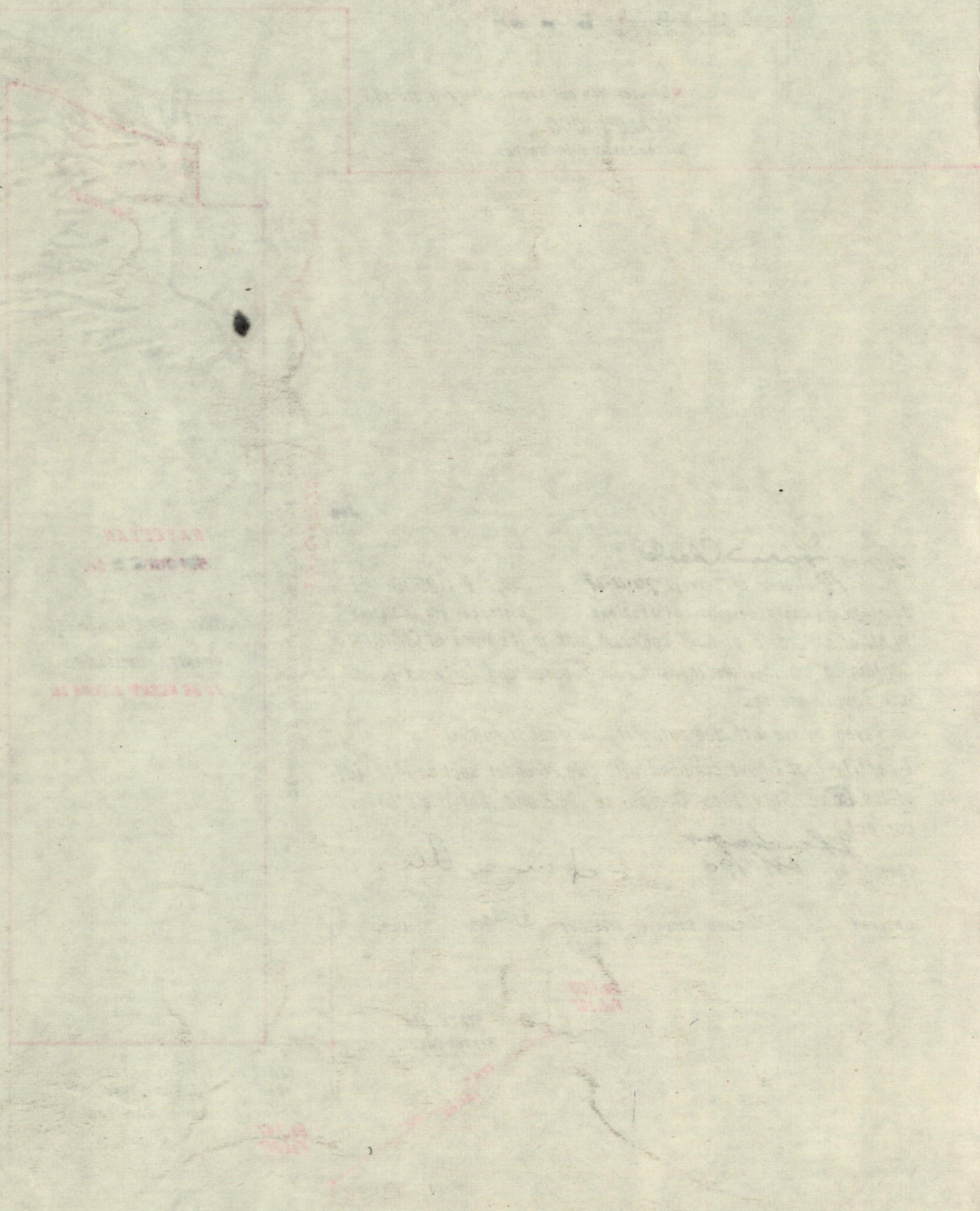

RECEIVED  
MAY 19 1913

MAY 19 1913

509

508