

Nº 21869

957

63

R.P.O. Vol. 541
C.T. Vol.

Fol. 115
Fol.

Ward of St. Ann's
County of St. George
Cadastral Sheet B.17.F.

INSET

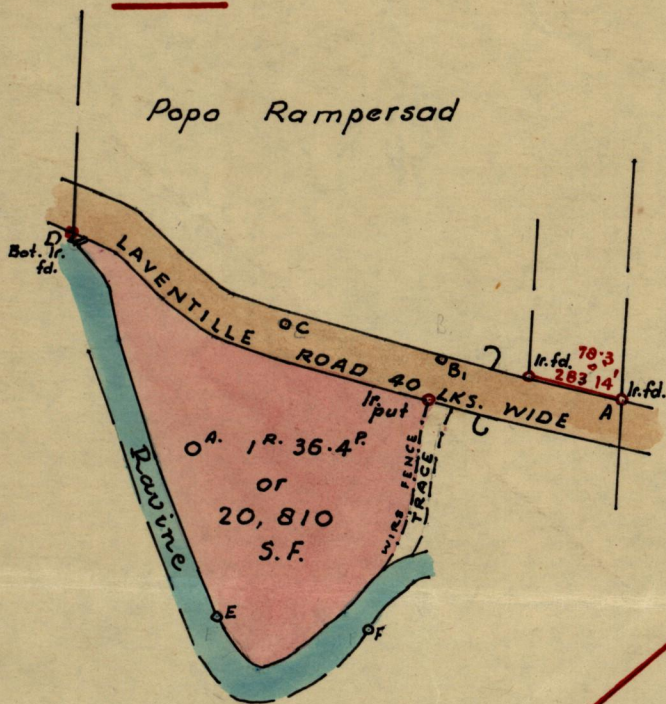

Scale ~ 1/1250

Distances are in links

LEGEND			
STA.	BEARINGS	DISTANCE	STA.
A	281° 45'	154.0	B ₁
A	281° 45'	285.5	C
C	293° 20'	196.1	D
D	153° 28'	340.6	E
E	93° 59'	126.7	F
F	13° 34'	232.0	B ₁

Drucilla

Paul

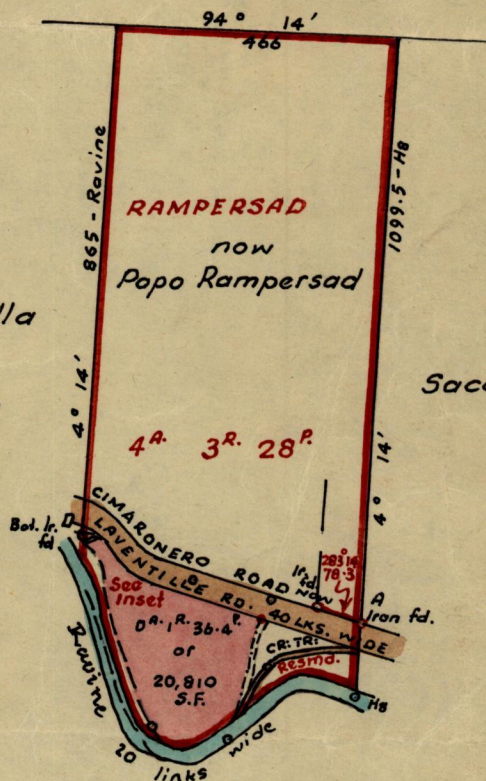

Approved

L. H. Fanell

Director of Surveys
30.9.67

SCALE ~ 1/2500

Note: To obtain compass bearings add ~~seconds~~ 1

minutes

Distances are in links

PLAN of a Parcel of land coloured pink in the Ward of St. Ann's
Containing twenty thousand, eight hundred & ten square feet
Surveyed by me, with due authority, in December 1967.

I certify that I have complied with rule 76 under Section 14 (2) (d) of the Land
Surveyors' Ordinance 1952, and that this plan is correct.

Checked by *[Signature]* 27/1/68

Albert Hayes

Entered

Land Surveyor, Trinidad 10th January 1968