

Nº 39693

957

613

R.P.O. Vol. 62
C.T. Vol. 1153

Fol. 47
Fol. 83

G.N.

Ward of La Brea
County of St. Patrick
Cadastral Sheet F10C&G

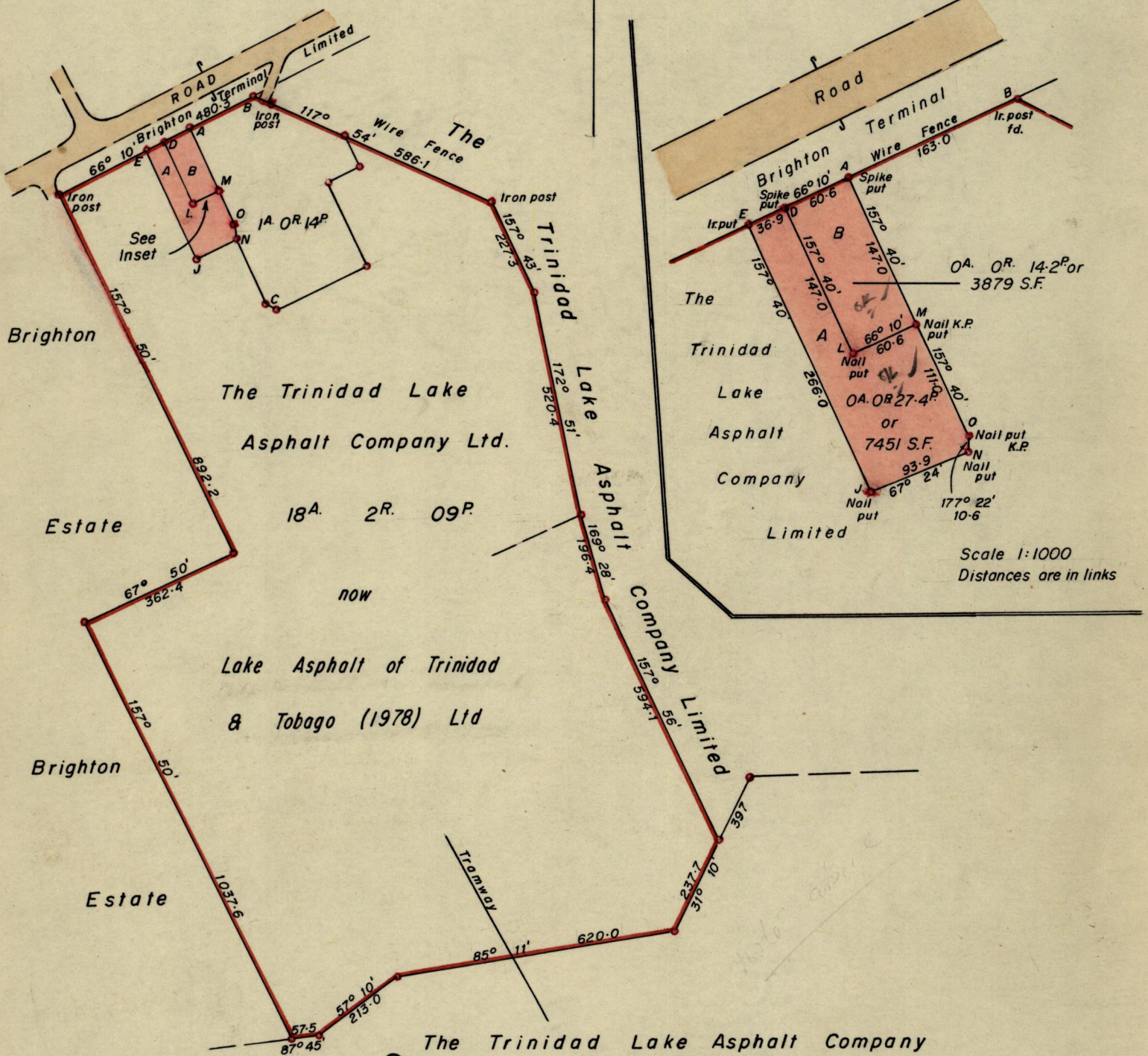

Scale 1:1000
Distances are in links

Approved

[Signature]
Director of Surveys

17.10.79

SCALE 1:2500

Note: To obtain compass bearings ~~add~~ subtract 13 minutes Distances are in Links

PLAN of ~~the~~ ^{two} Parcel of land coloured pink in the Ward of La Brea
Containing (A) twenty-seven point four perches or seven thousand four hundred and fifty-one square feet
(B) fourteen point two perches or three thousand eight hundred and seven-nine square feet
Surveyed by me, with due authority, in March 1971

I certify that I have complied with rule 76 under Section 14 (2) (d) of the Land Surveyors' Ordinance 1952, and that this plan is correct

Checked by *[Signature]* 17/10/79

[Signature]

Entered.....

Land Surveyor, Trinidad 20th Sept 1979

G.P., TR./To.—616—15,000—LANDS AND SURVEYS VAULT RECORDS

Original in Plan U.E.43

819

820

821

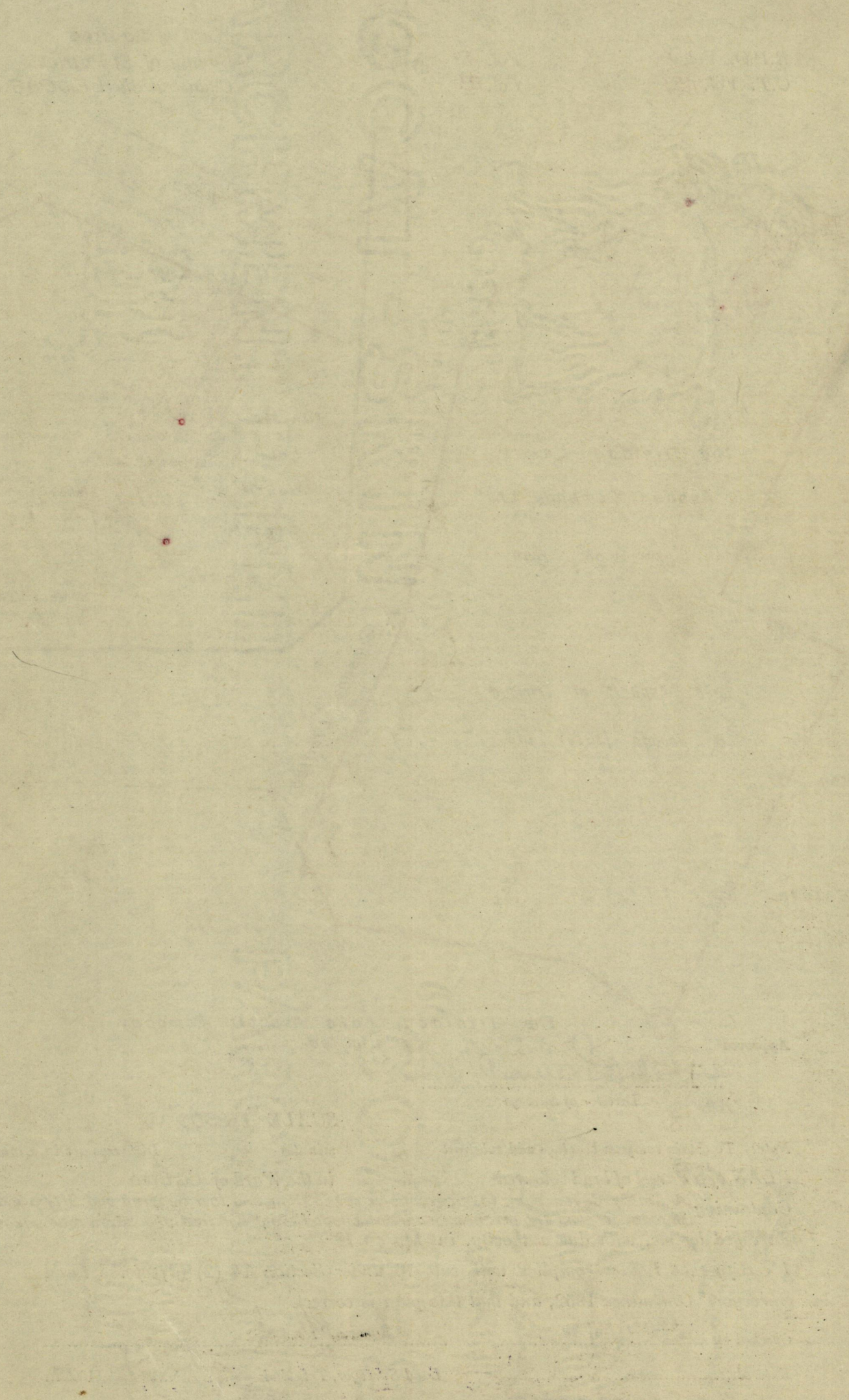

Architectural drawing or map