

Nº 44634

357

612

R.P.O. Vol. III
C.T. Vol. 1360

Fol. 137
Fol. 371

Ward of Siparia
County of St Patrick
Cadastral Sheet G. 13. N

Mary Ramdeen
now or formerly
N. Ramdin & D. Philip

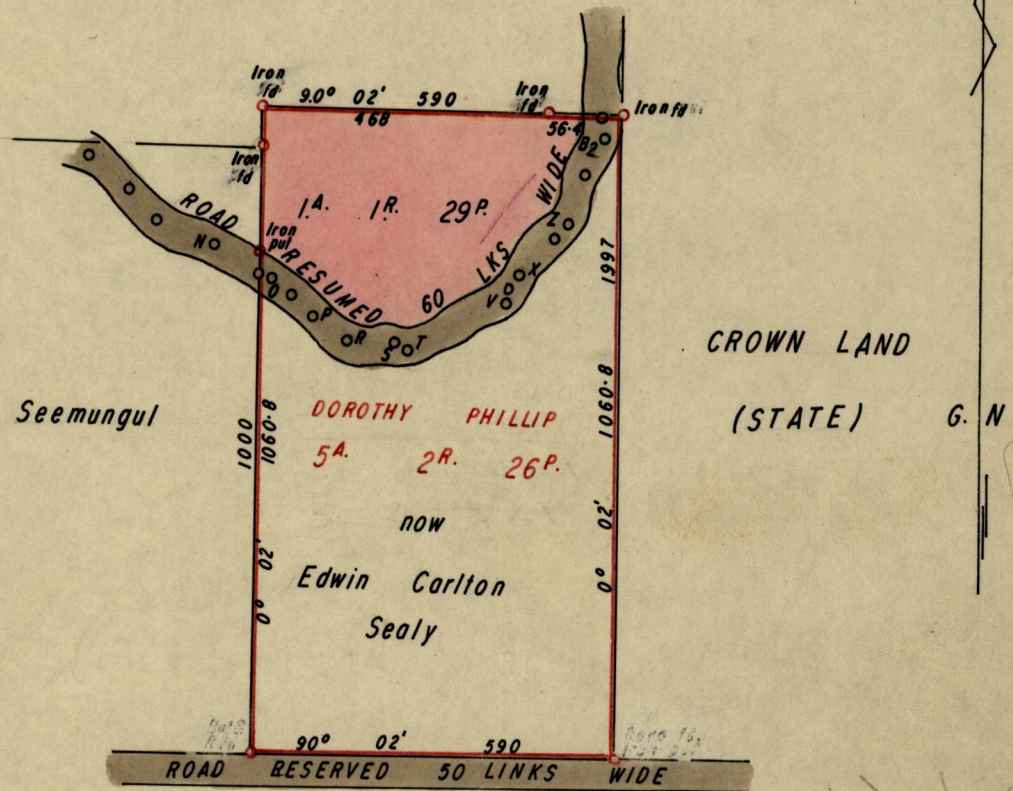

Approved

John Samuel

17.10.79

Director of Surveys

SCALE ~ 1/2500

Note: To obtain compass bearings ~~add~~/subtract 2 minutes Distances are in Links

PLAN of a Parcel of land coloured pink in the Ward of Siparia

Containing One Acre, One Rood and Twenty-nine Perches

Surveyed by me, with due authority, in May 1979

I certify that I have complied with rule 76 under Section 14 (2) (d) of the Land Surveyors' Ordinance 1952, and that this plan is correct.

Checked by *PJ 17-10-79*

Herman Pinard

Entered..... Land Surveyor, Trinidad 15th October 1979.

LANDS AND SURVEYS VAULT RECORDS

Original in Bk 926 fo 72

10

10/15/157

10

10

10

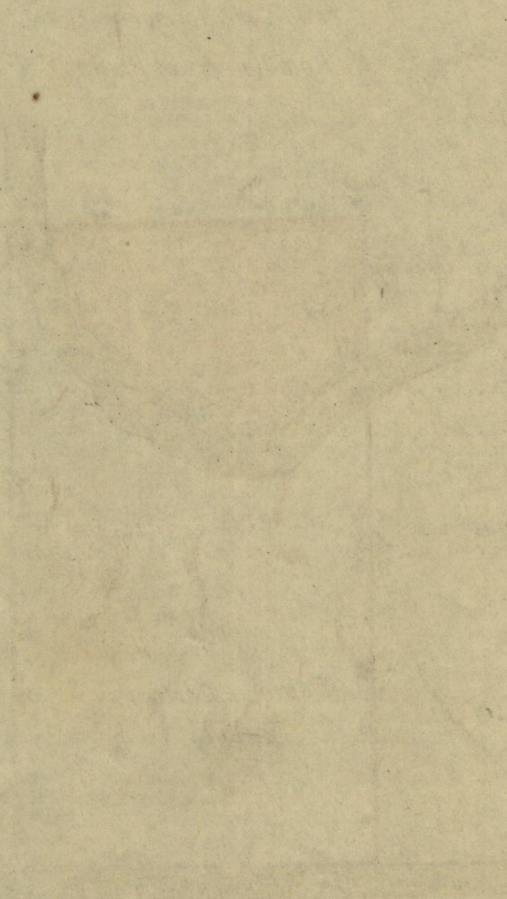

Faint, illegible text or markings at the bottom of the page, possibly bleed-through from the reverse side.