

357

L. & S.—54

586

No 40477

R.P.O. Vol. 2412
C.T. Vol.

Fol. 445
Fol.

City
~~Ward~~ of Port of Spain
County of St. George
Cadastral Sheet A.20.0

G.N.

Vault

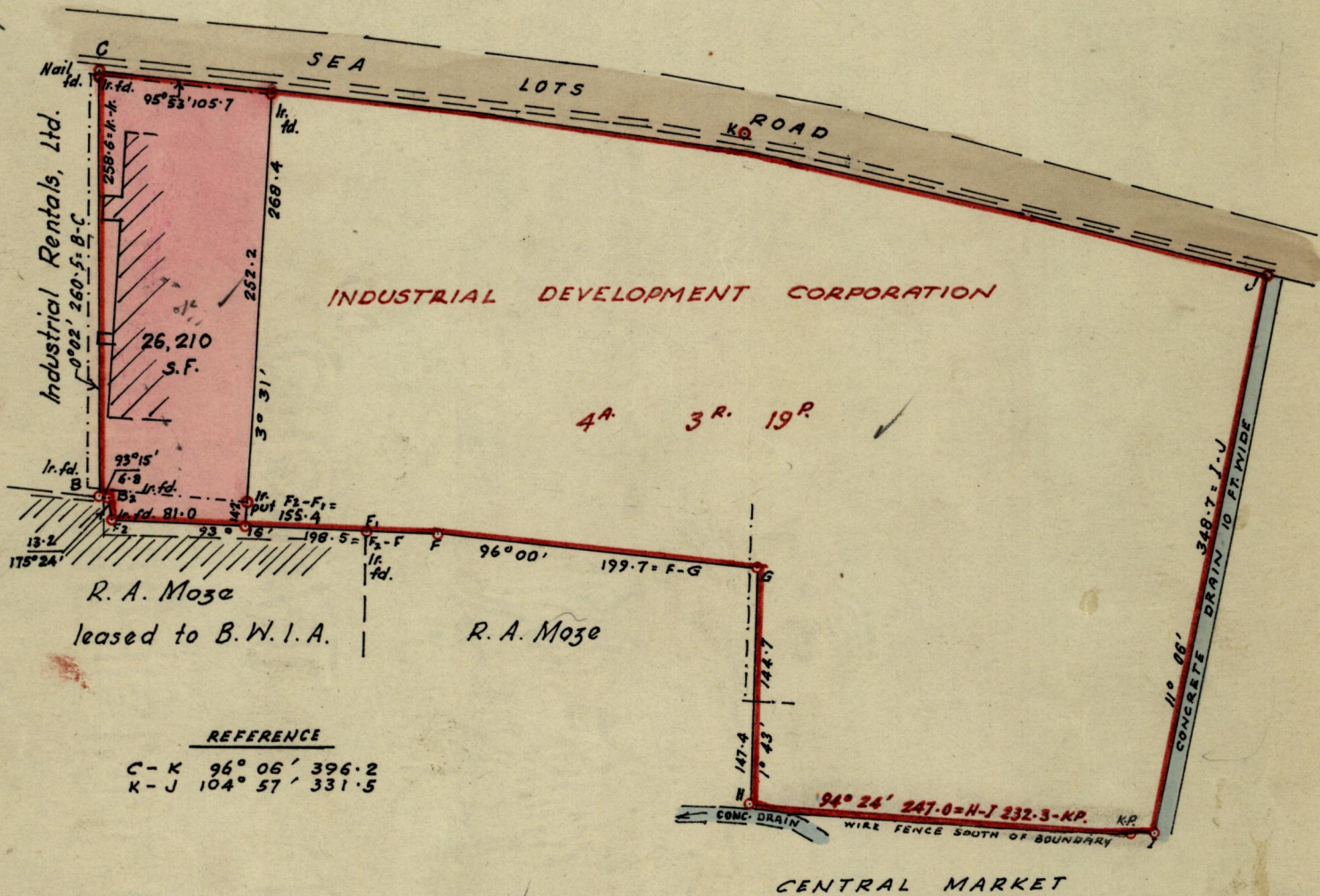

REFERENCE

C-K	96° 06'	396.2
K-J	104° 57'	331.5

Approved

John Lamm
Director of Surveys

21.9.79

SCALE : 1/1250

Note: ~~To obtain compass bearings add/subtract~~ ~~minutes~~
Bearings based on POS control Marks.

Distances are in feet

PLAN of a Parcel of land coloured pink in the ~~Ward~~ City of Port of Spain
Containing twenty-six thousand, two hundred & ten square feet
Surveyed by me, with due authority, in July 1979

I certify that I have complied with rule 76 under Section 14 (2) (d) of the Land Surveyors' Ordinance 1952, and that this plan is correct.

Checked by *L. J. W. 20/9/79.*

Leslie C. Skempton
Land Surveyor, Trinidad. 30th July 1979.

Entered.....

LANDS AND SURVEYORS

Original survey map plan T.A.133